

HB1828

EXTERIOR LINEAR LED LIGHTBAR

COMPACT | LOW PROFILE | SPEC GRADE
4w/ft | 180lm/ft



Cove | Accent | Border | General Lighting

Maximize your lighting value without sacrificing quality with The Smart Lighting Company HB1828 Series luminaire, a testament to our commitment to affordable, spec-grade outdoor lighting. Designed for versatility, this low-profile fixture excels in cove, accent, walls, borders, and general lighting applications. At just 0.79"H x 1.5"W, the HB1828 packs superior performance into a compact form. Its integrated 100/277VAC driver and Plug & Play connectors simplify installation and facilitate extended configurations. With Nichia bin-sorted LEDs at its core, it delivers outstanding light quality efficiently, using less power to produce a brighter effect—ideal for design-conscious yet budget-aware architects and lighting designers. Enclosed in a robust, extruded aluminum housing with a sleek black powder coat and removable precision-tooled end caps for continuous lensing, this luminaire is a smart choice for enduring and economical architectural lighting.



PERFORMANCE

Output

4w/ft | 180lm/ft

Color Temperatures

22k, 27k, 30k, 35k, 41k, 50k, 65k, R, G, B, A

Beam Angles

120°

LEDs per Foot

28

LED's

Nichia bin-sorted

Color Consistency

2 SCDM

CRI

85 std, 95 optional

ELECTRICAL

Input Voltage

100-277vac

Power Supply

Integral

Control

0-10v dimming

Heat dissipation

Full thermal management system

Connection

Quick connect plug and play system

Projected Lumen Maintenance

>90,000 hours

PHYSICAL

Fixture Length Options

12", 24", 36", 48"

Max Run Length

277ft@277vac, 120ft@120vac

Housing

Anodized extruded aluminum,

Lens

Polycarbonate diffused

Fixture Finish (Standard)

Black

Seamless Lens Connection

Removable end covers

Standard Mounting

Stainless adjustable or flat brackets

Operating Temperature

-40°F to 122°F, (-40°C to 50°C)

ENVIRONMENT AND WARRANTY

IP Rating

IP66

Environment

Dry, Damp or Wet locations
0-100% non condensing humidity

Certifications

UL, cUL

Warranty

5 year limited warranty

OPTICS

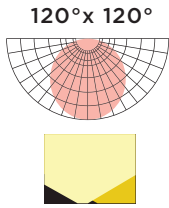

COLOR TEMPERATURES

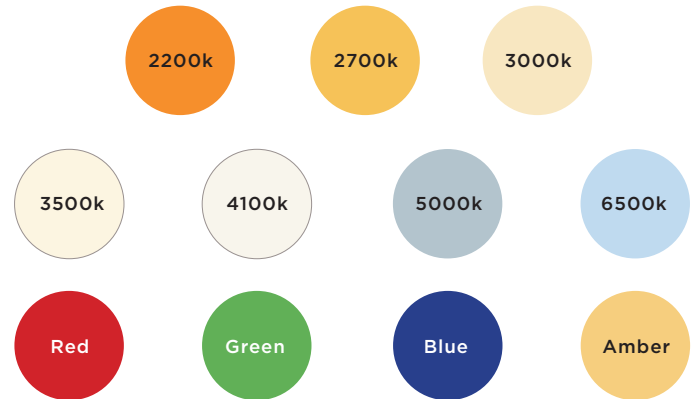

DIMENSIONS AND DATA

4w/ft	Voltage	View Angle	Watts/Fixture	Lumens/Fixture	LEDs/Fixture	Extrusion Length	Total Length
HB1828-12-XXK-XXD-ACD	100-277VAC	120°	4w	180	28	L=302.8mm	L=304.8mm (12")
HB1828-24-XXK-XXD-ACD			8w	360	56	L=607.6mm	L=609.6mm (24")
HB1828-36-XXK-XXD-ACD			12w	540	84	L=912.4mm	L=914.4mm (36")
HB1828-48-XXK-XXD-ACD			16w	720	112	L=1217.2mm	L=1219.2mm (48")

PROFILE

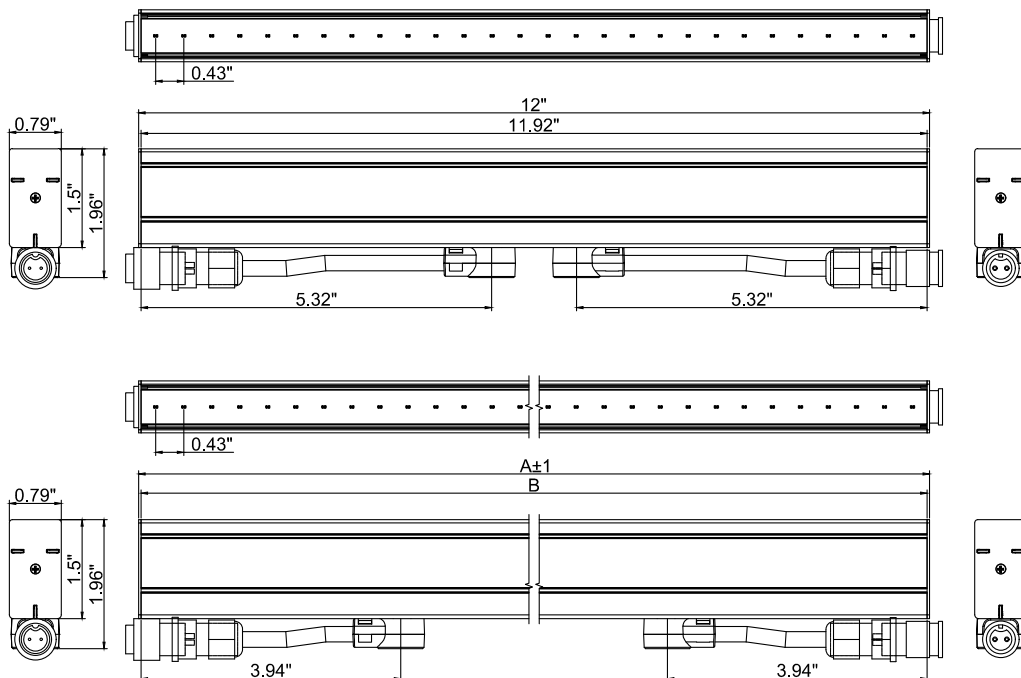

CREATE YOUR FIXTURE

Ex. HB1828-48-30K-120-ACD

MODEL	LENGTH	COLOR	OPTICS
HB1828	12" 12 inches 24" 24 inches 36" 36 inches 48" 48 inches	22k 2200k R Red 27k 2700k G Green 30k 3000k B Blue 35k 3500k A Amber 41k 4100k 50k 5000k 65k 6500k	120 120"x120"
VOLTAGE	CONTROL		
AC 100-277vac	D 0-10v Dimming ND Non Dimming		

SELECT CONNECTION

Wire Lead

QTY	POWER/SIGNAL	
	AL-HB5P-72"-W/L	72" (6ft) Wire lead 5pin
	AL-HB5P-xx"-W/L	xx" (CU) Wire lead 5pin
QTY	POWER	
	AL-HB3P-72"-W/L	72" (6ft) Wire lead 3pin
	AL-HB3P-xx"-W/L	xx" (CU) Wire lead 3pin

* 1 wire lead required for each run.

End Cap

QTY		
	AL-HB3P-ENDCAP	End cap for fixture output at end of run

* 1 End cap required at the end of each run.

Jumper Cable

QTY	POWER/SIGNAL	
	AL-HB5P-12"-J	12" (1ft) jumper 5pin
	AL-HB5P-72"-J	72" (6ft) jumper 5pin
	AL-HB5P-xx"-J	xx" (CU) jumper 5pin
QTY	POWER	
	AL-HB3P-12"-J	12" (1ft) jumper 3pin
	AL-HB3P-72"-J	72" (6ft) jumper 3pin
	AL-HB3P-xx"-J	xx" (CU) jumper 3pin

* Fixtures are end to end connected. Use jumpers if space is needed between fixtures.

SELECT MOUNTING

QTY	MOUNTING BRACKETS - 2 PER FIXTURE	
	AL-HB18-ADJ BRACKET	HB18 Adjustable bracket
	AL-HB18-FLAT BRACKET	HB18 Flat bracket

ADDITIONAL OPTIONS

0-10V Dimmer

QTY		
	LUT-DVSTV-WH	Wall switch with 0-10v dimming

Surge Protection

QTY		
	LSP4-UNV	120/277v surge protector

WIRE LEAD

DESCRIPTION

5 pin power / signal wire

PART NUMBER

AL-HB5P-xx"-W/L

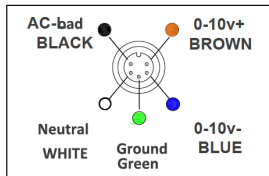
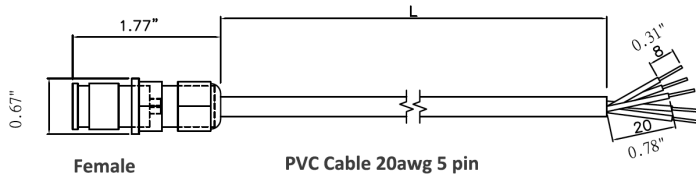

DESCRIPTION

3 pin power wire

PART NUMBER

AL-HB3P-xx"-W/L

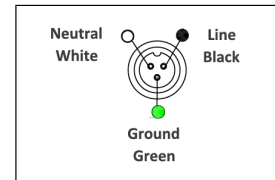
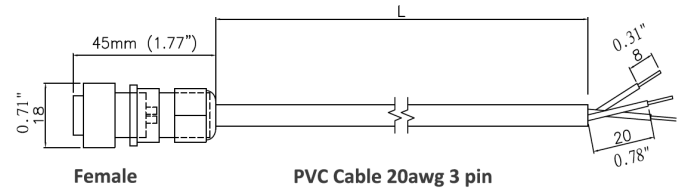

JUMPER CABLE

DESCRIPTION

5 pin power / signal jumper

PART NUMBER

AL-HB5P-xx"-W/L

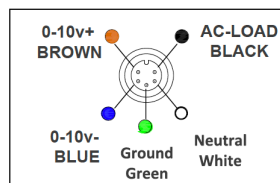
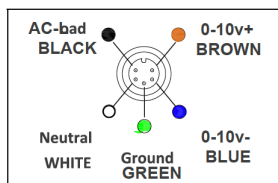
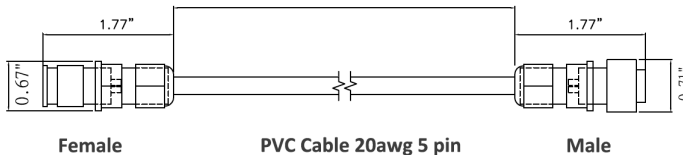

DESCRIPTION

3 pin power jumper

PART NUMBER

AL-HB3P-xx"-J

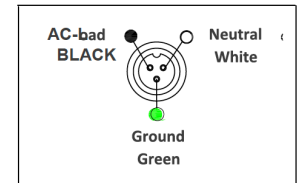
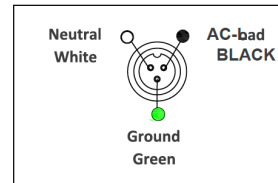
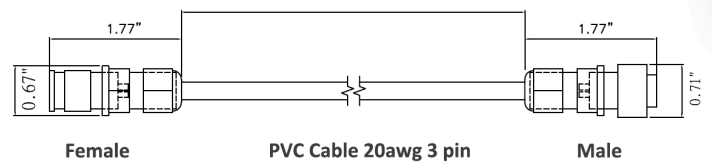

MOUNTING BRACKETS

ADJUSTABLE BRACKETS

DESCRIPTION

HB18 Adjustable Bracket

PART NUMBER

AL-HB18 ADJ.Bracket

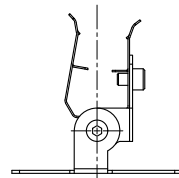
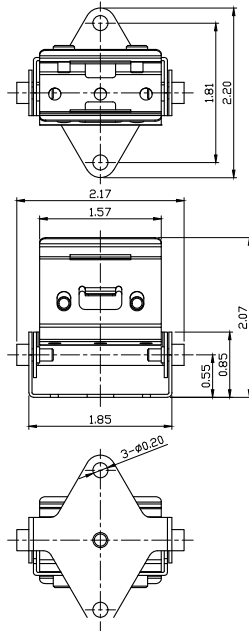

Surface treatment: Black coating
/ Grey coating

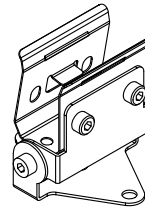
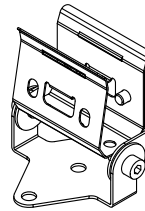

FLAT BRACKETS

DESCRIPTION

HB18 Flat Bracket

PART NUMBER

AL-HB18-Flat Bracket

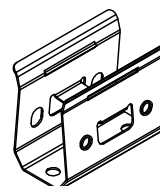
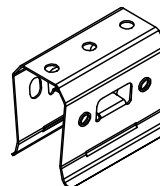
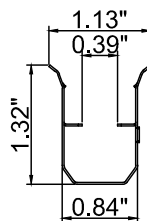
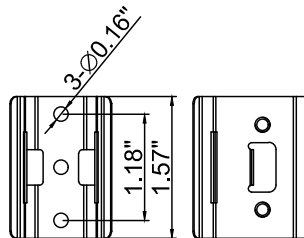
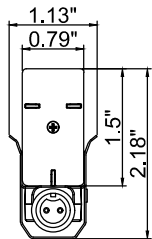

Clip

SURGE PROTECTION DEVICE

SURGE PROTECTION

DESCRIPTION

Surge Protection Device

PART NUMBER

AL-LSP-UNV

The use of a surge protection device is necessary to maintain your warranty. Specifications are subject to change without notice.

SPECIFICATIONS

Input Voltage	120-277V (+/- 5%)		
Frequency	50Hz-60Hz		
Maximum Continuous Voltage	320V		
Maximum Discharge Current	L-N 20kA; L-G, N-G 10kA (8/20Qs standard wave)		
Nominal Discharge Current	5kA		
Measured Limiting Voltage (VpK)	L-N	L-G	N-G
	1200	1320	1320
Max Case Temperature	85°C		

PULSE RATING (8 X 20 SEC)		
Surge Level	# of Strikes	
	L-N	L-G, N-G
10,000A	*2	1
6,500A	4	2
5,000A	30	15
2,000A	200	100
700A	20000	1000

*1 strike at 20,000A

MECHANICAL DIMENSIONS : IN (MM)

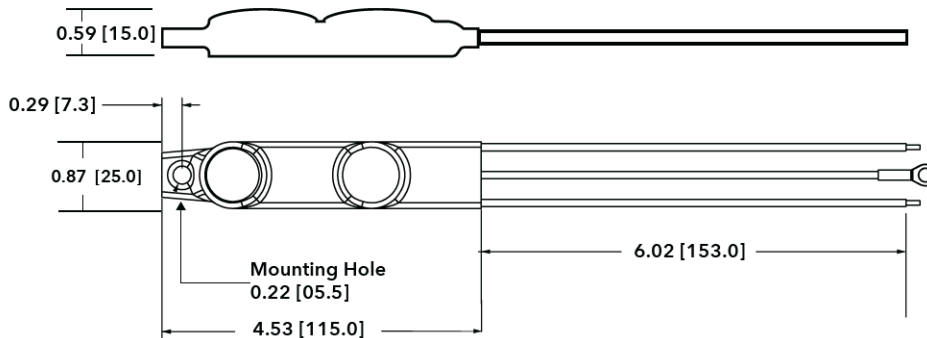

WIRING DIAGRAM

