

HB30 Mounting

Extrusions, Extended Arms, Louvers

For use with our HB30 series fixtures for applications between 1 and 12 feet.



APPLICATION

Designed to illuminate signage, facades, monuments and more.

The Extrusion package allows you to easily mount your HB30 fixture in an architectural powder-coated extrusion with your choice of mounting arms or ground post stakes. Standard finishes available. Fixtures are able to be mounted as a stand-alone fixture or in a seamless row. Wires connect from the fixture through the extended arm into the junction box. The wall mounted box has knock outs on all four sides as well as through the back. Row mounted fixtures are wired end to end. The housing angle is adjustable on the extended arms. Louvers are available as an option to reduce glare.

FEATURES

- Extruded aluminum housing with stainless steel hardware
- Black or Bronze Powder-coat finish standard - RAL custom colors available
- Extended arms 6", 12", 18", 24" or 36"
- Ground post mounting
- No visible wires or mounting hardware
- Integrated Glare Shield and optional Louvers
- Stand-alone or Row mounted
- Adjustable housing with calibrated system for precise angle up to 25°+/-
- Mounted direct or indirect, horizontally or vertically

WARRANTY

Our fixtures are backed by a 5-year limited warranty.

PHYSICAL

Housing	Extruded Anodized Aluminum
Fixture Lengths	12", 24", 36", 48"
Housing Colors	Bronze, Black, White, Silver, custom
Connection	Quick connect plug and play
Mounting	Extended arms or ground post
Environment	IP66 Wet, Damp or Dry Locations
Glare Protection	Integrated glare shield - optional louvers

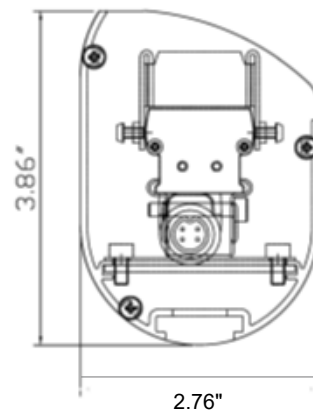

HB30 Mounting

FIXTURE SOLD SEPARATELY

DATE
FIRM
PROJECT
CONTACT

PART NUMBER

MODEL	LENGTH	FINISH	MOUNTING	OPTIONS
HB30EXT	12 1 foot 24 2 foot 36 3 foot 48 4 foot	BZ Bronze BK Black WH White SI Silver CU Custom RAL _____	6" 6" Arm 12" 12" Arm 18" 18" Arm 24" 24" Arm 36" 36" Arm GPS Ground Post	L Louvers N None

Standard fixture housing is anodized aluminum. Powder coating is available from factory in Black, Bronze, White, or custom. There is a minimum quantity for powder coating or a surcharge will be added.

ACCESSORIES

MOUNTING HARDWARE

AL-HB30 ADJ.BRACKET	HB30 Adjustable Bracket
HBEXT-GPS	Ground post stake

1ft & 2ft extrusions require one ground post stake (HBEXP-GPS). 3ft & 4ft extrusions require two ground post stakes (HBEXP-GPS).

GLARE PROTECTION

HB30-12" LOUVER	12" Louver
HB30-24" LOUVER	24" Louver
HB30-36" LOUVER	36" Louver
HB30-48" LOUVER	48" Louver

Standard louvers are in Black. Special order for Bronze, White, Silver or custom.



HB30 Extended Arm Mounting

FIXTURE SOLD SEPARATELY

12" AND 24" EXTRUSIONS WITH SINGLE MOUNTING ARMS

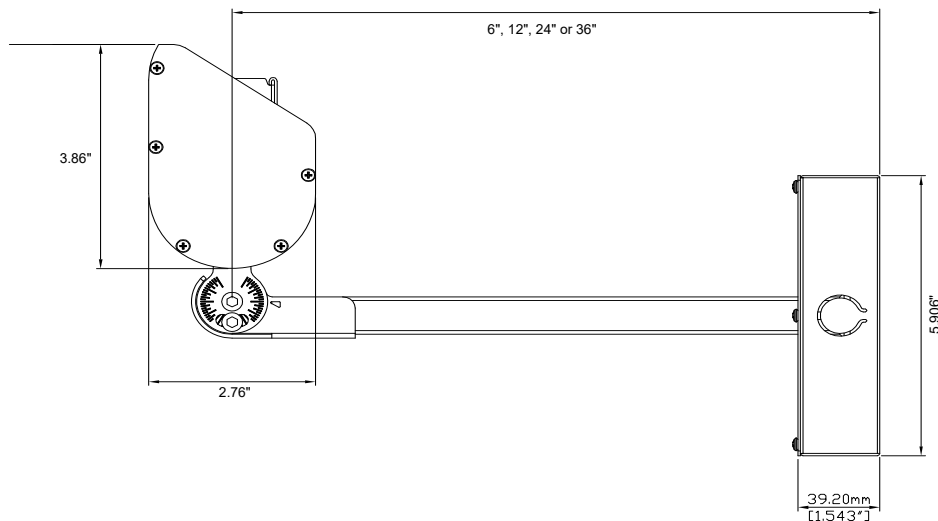
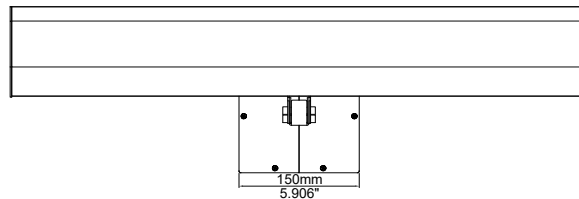
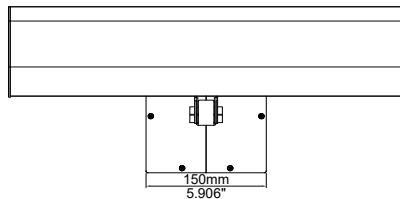
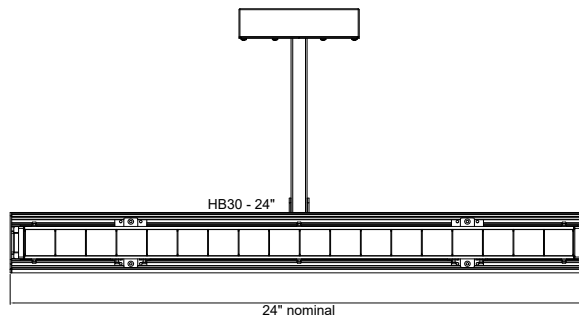
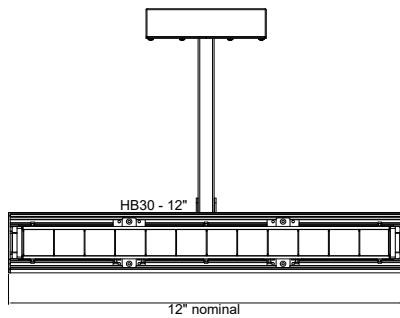
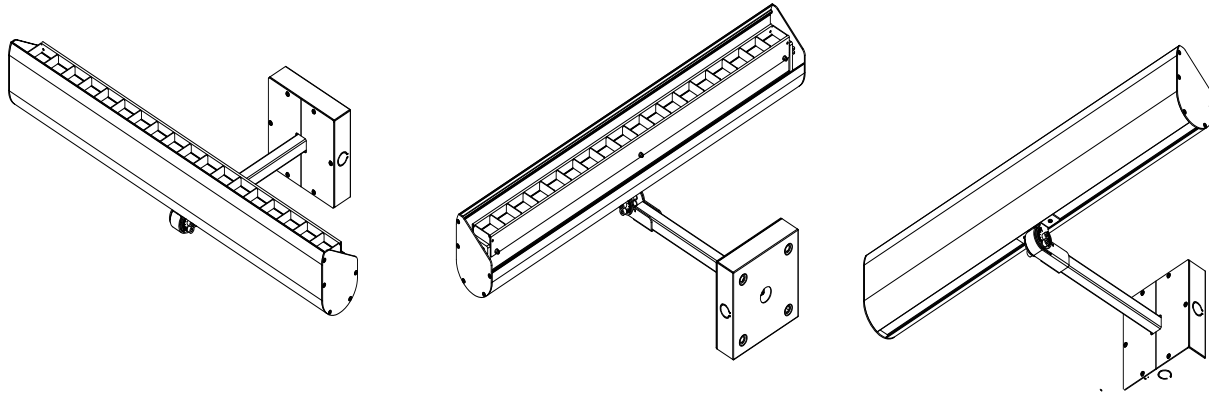

HB30 Extended Arm Mounting

FIXTURE SOLD SEPARATELY

36" AND 48" EXTRUSIONS WITH DOUBLE MOUNTING ARMS

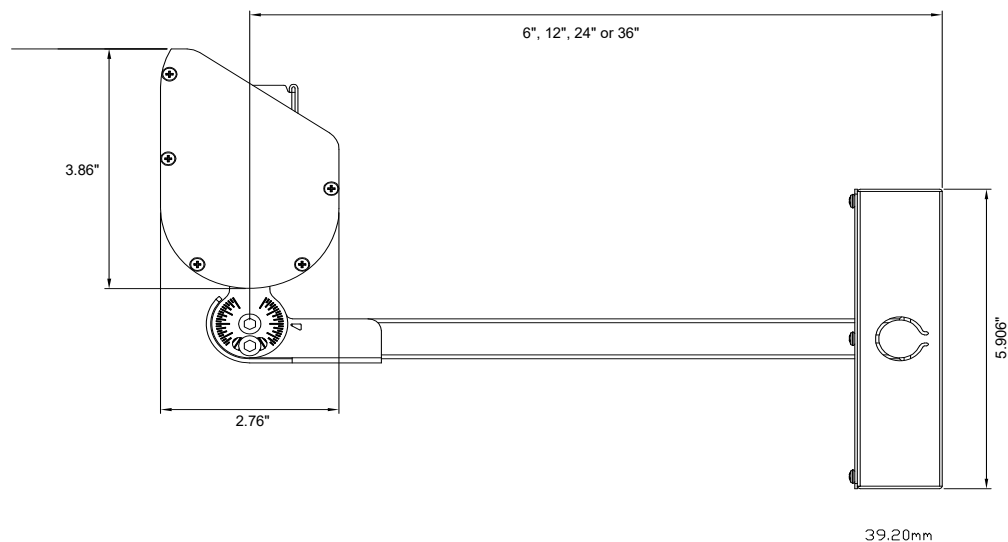
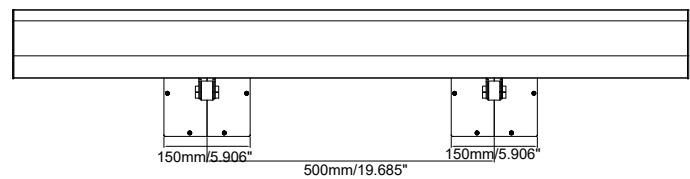
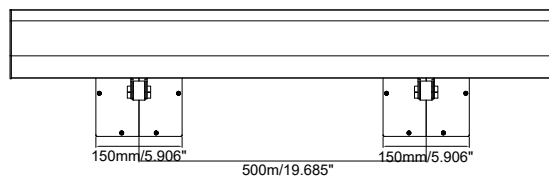
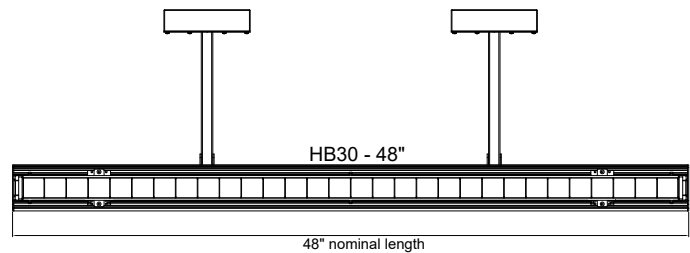
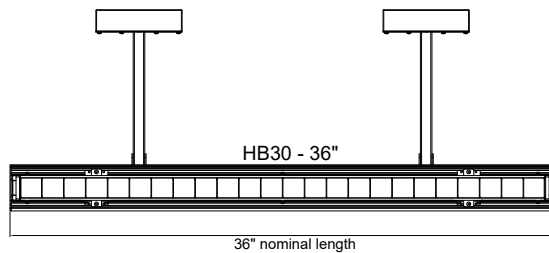
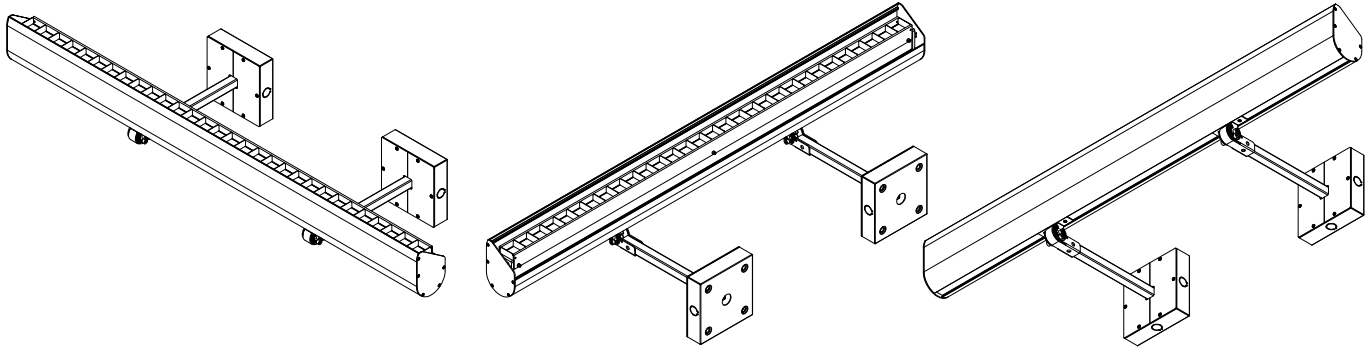

HB30 Ground Post Mounting

FIXTURE SOLD SEPARATELY

12" AND 24" EXTRUSIONS WITH ONE THREADED ARM

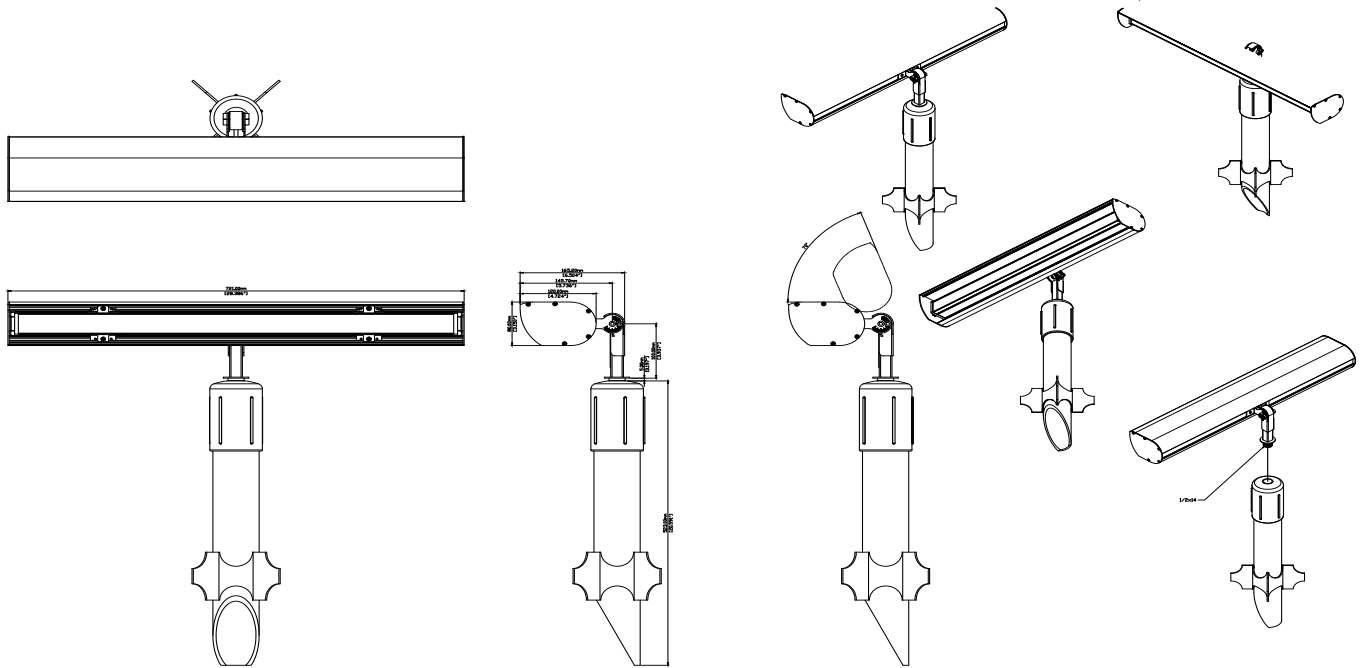

36" AND 48" EXTRUSIONS WITH TWO THREADED ARMS

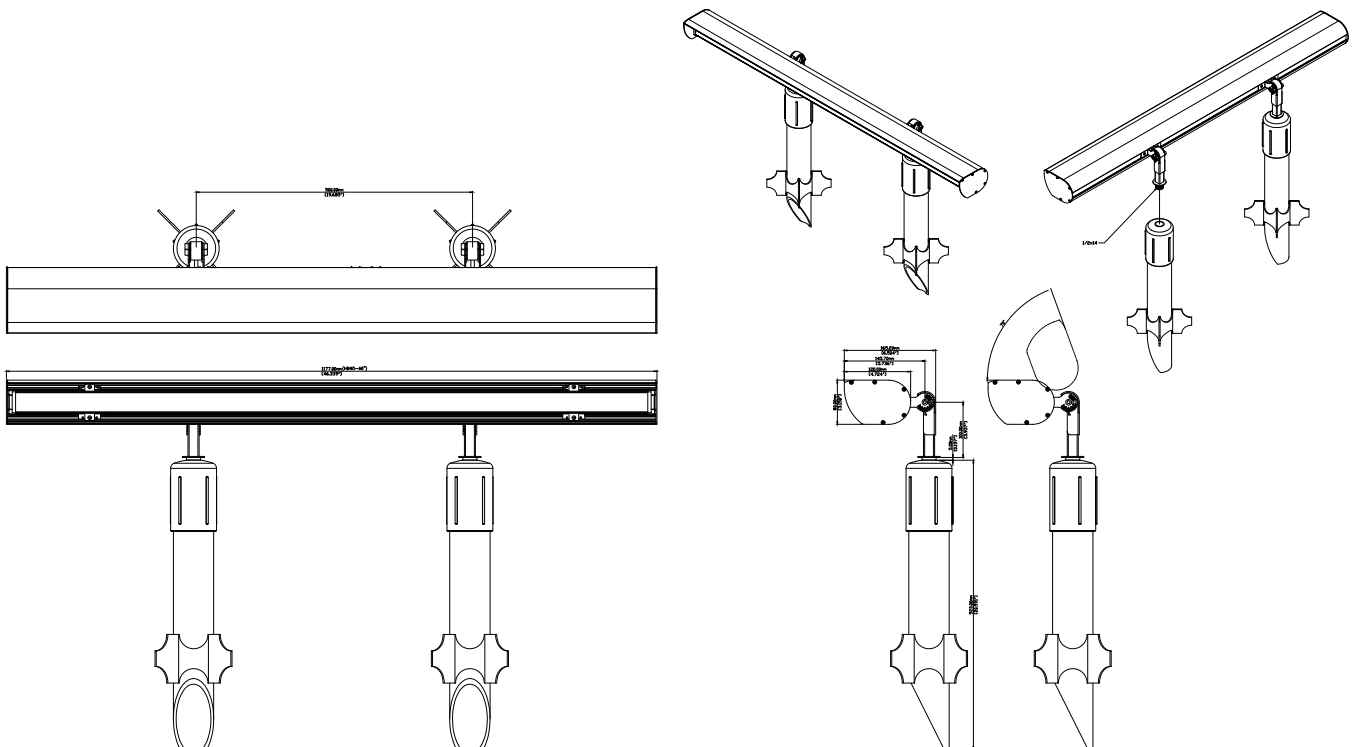

HB30 Louvers

FIXTURES SOLD SEPARATELY

LOUVERS

