

HB3014

EXTERIOR LINEAR LED LIGHTBAR

Designed for Low Profile Illumination

Date: | Firm: | Project: | Contact:

24vdc 480 lm/ft. 6.5w/ft.

APPLICATION

The HB3014 is an architectural high performance, LED linear exterior specification grade luminaire in a low-profile package perfect for flood, wall washing, wall grazing and precise cove illumination with full saturation up to 12 feet.

Available in four lengths and many color temperatures. The HB3014 is powered by an external power supply. Nichia Bin sorted LEDs produce high quality illumination sought after by architects and lighting designers.

Our optical lenses are designed to produce more light using less power to achieve the desired effect. Our fixtures are constructed in an extruded anodized aluminum housing with tooled end caps. The LTW connectors provide a secure IP66 rated connection. Choose from a variety of mounting options.

FEATURES

- UL Listed
- Certified to CSA Standard, C22.2 No. 9
- Low-wattage, low voltage, very low heat operation
- User friendly, locking LTW connectors for easy installation
- HB3014R - Dome lens also available
- Optional Extrusions, Mounting Arms, and Louvers

PHYSICAL

Housing	Extruded Anodized Gray Aluminum
Fixture Lengths	12", 24", 36", 48"
LEDs per foot	14 LEDs per foot
Optics	15°, 20°, 30°, 45°, 120°, 30x60°
Lens	Frosted Flat Polycarbonate Lens
Connection	Bottom Wire/Connector Feed
Hardware	Stainless steel flat or adjustable brackets
Environment	IP66 Wet, Damp or Dry Locations, 0-100% non-condensing humidity

WARRANTY

Our fixtures are backed by a 5-year limited warranty



ELECTRICAL

Constant Voltage	24vdc
Driver	External remote driver
Fixture wattage	7 w/ft.
System wattage	6.5 w/ft.
Cable	PVC 2C 20 AWG.
Control	0-10v dimming
Max Load per	96w (14.75ft.)

PERFORMANCE

LED Type	Nichia
Color Accuracy	2 Step MacAdam Elipse
Color Options	28k, 30k, 35k, 41k, 50k, 65k
CRI	85 standard, 95 option
Lumen Output	480 lm/ft.
Temperature Range	-40°F to 122°F, (-40°C to +50°C)
Lifetime L70	>50,000 hours

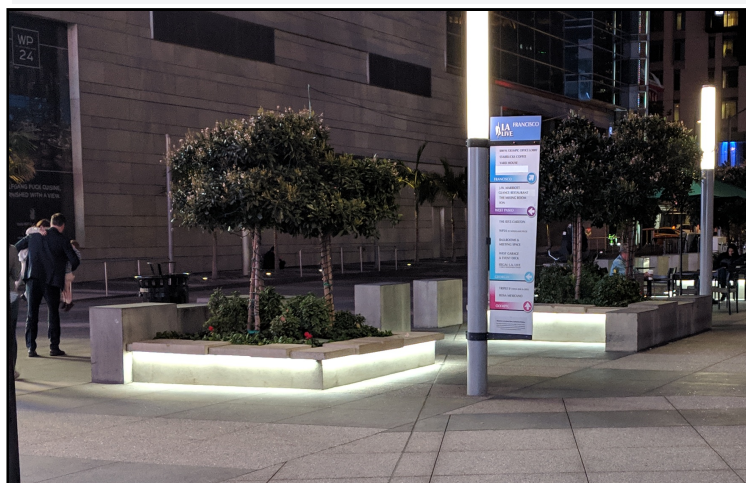

For more information visit us at...

thesmartlightingcompany.com

or call 949-346-3456

1731 Kaiser Ave.
Irvine, CA 92614



CREATE YOUR PART NUMBER HERE

MODEL	LENGTH	COLOR		VOLTAGE / DIMMING
HB3014	12" 12 inch	WHITE	MONO	15 15° beam
	24" 24 inch	28k 2800k	RED Red	20 20° beam
	36" 36 inch	30k 3000k	BLU Blue	30 30° beam
	48" 48 inch	35k 3500k	GRN Green	45 45° beam
		41k 4100k		120 120° beam
		50k 5000k		3060 30°x60° beam
		65k 6500k		

ACCESSORIES

STARTER CABLES

1 STARTER CABLE AND END CAP REQUIRED FOR EACH RUN

_____ AL-HB2P-LTW-72"FE-W/L	72" (6ft) Starter Cable
_____ AL-HB2P-LTW-xx"FE- W/L	xx" (CU) Starter Cable (custom length - consult factory)

JUMPER CABLES

_____ AL-HB2P-LTW-12"-J	12" (1ft) Jumper Cable
_____ AL-HB2P-LTW-72"-J	72" (6ft) Jumper Cable
_____ AL-HB2P-LTW-xx"-J	xx" (CU) Jumper Cable (custom length - consult factory)

END CAP

_____ AL-HB2P-END CAP	END CAP
-----------------------	---------

MOUNTING HARDWARE

2 MOUNTING BRACKETS REQUIRED PER FIXTURE

_____ AL-HB30 ADJ.BRACKET	HB30 Adjustable bracket
_____ AL-HB30-FLAT BRACKET	HB30 Flat bracket

SURGE PROTECTION DEVICE (A SURGE PROTECTION DEVICE MUST BE INSTALLED ON EACH SUPPLYING CIRCUIT TO COMPLY WITH TSLC'S 5-YEAR WARRANTY TERMS)

_____ LSP4-UNV 120/277V SURGE PROTECTOR

0-10v DIMMER SWITCH

_____ IP710-DLZ	0-10V Dimmer
-----------------	--------------

GLARE PROTECTION

_____ HB30-12" LOUVER	12" Louver
_____ HB30-24" LOUVER	24" Louver
_____ HB30-36" LOUVER	36" Louver
_____ HB30-48" LOUVER	48" Louver

MOUNTING OPTIONS

HOUSING AND EXTENDED ARMS (Fill in Quantity, then select housing length, paint color and extended arm length)

Finish options - BK-BLACK, BR-BRONZE, CU-CUSTOM

QTY HB30EXT-XXL-XXF-XXA (L=Length, F=Finish, A= Extended arm length)

_____ HB30EXT-12"	12" housing with extended arms
_____ HB30EXT-24"	24" housing with extended arms
_____ HB30EXT-36"	36" housing with extended arms
_____ HB30EXT-48"	48" housing with extended arms
_____ HBEXP-GPS	Ground post stakes

OPTICS

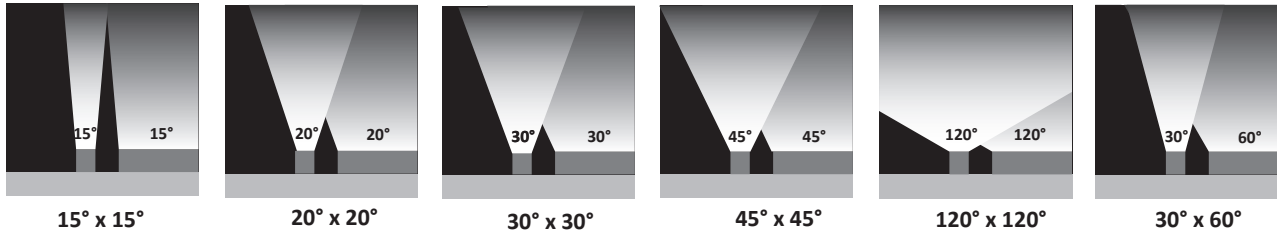

COLOR TEMPERATURES

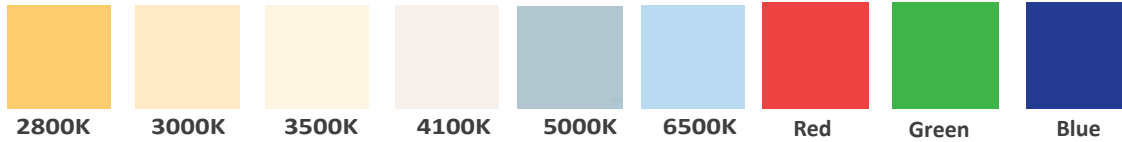

DIMENSIONS AND DATA

MODEL NUMBER	VOLTAGE	VIEW ANGLE	WATTS/FIXTURE	LUMENS/FIXTURE	LEDs/FT	EXTRUSION LENGTH	TOTAL LENGTH
HB3014-12-XXK-XXD-24V	24VDC	15°, 20°	7w	480lm	14	L=305.9mm	L=306.8mm (12.1")
HB3014-24-XXK-XXD-24V		30°, 45°	14w	960lm	28	L=606.8mm	L=611.8mm (24.1")
HB3014-36-XXK-XXD-24V		120°	21w	1440lm	42	L=911.4mm	L=916.4mm (36.1")
HB3014-48-XXK-XXD-24V		30°x60°	28w	1920lm	56	L=1216.2mm	L=1221.2mm (48.1")

PROFILE

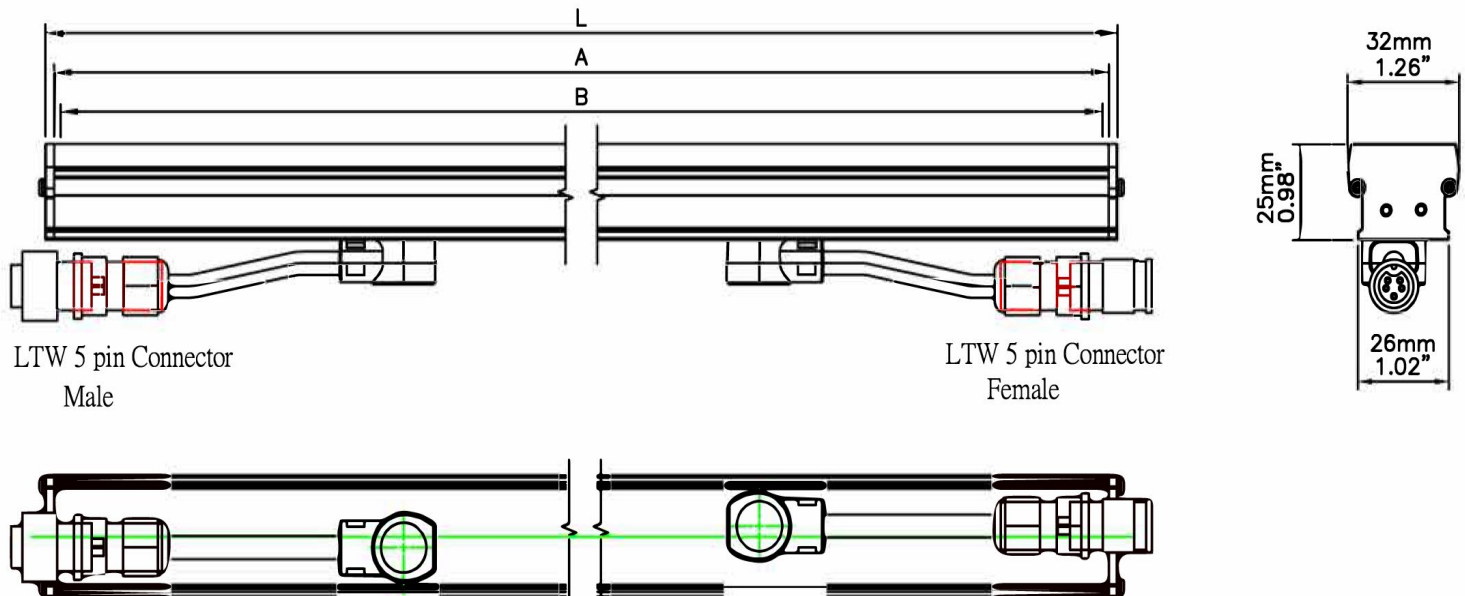

Date: Firm: Project: Contact:

WIRE LEAD

AL-HB2P-LTW-xx"FE- W/L 2 pin wire

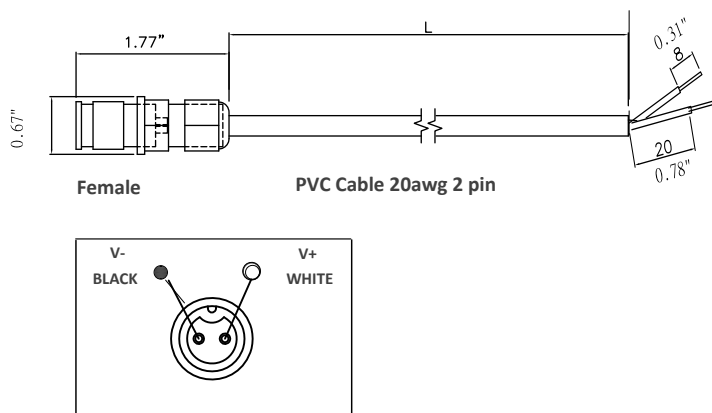

JUMPER CABLE

AL-HB2P-LTW-xx"FE- J2 pin jumper

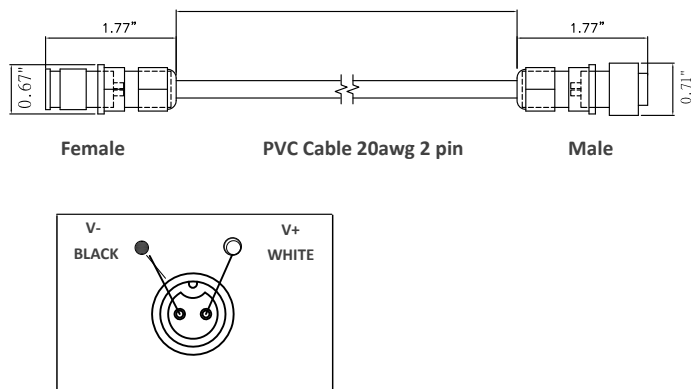

Date: Firm: Project: Contact:

ADJUSTABLE BRACKETS

DESCRIPTION

PART NUMBER

HB30 ADJUSTABLE BRACKET.....AL-HB30 ADJ.BRACKET

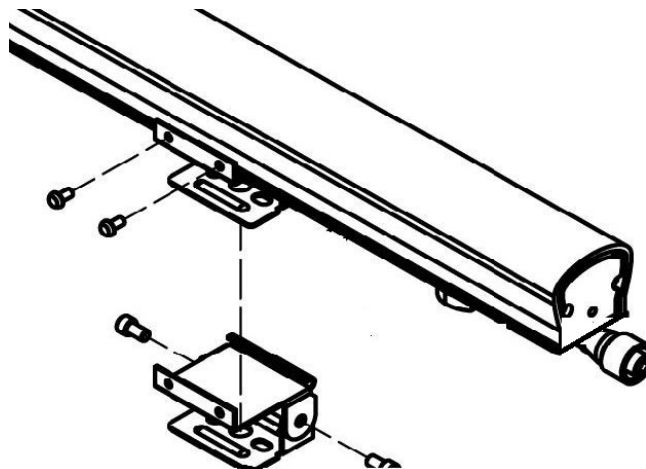
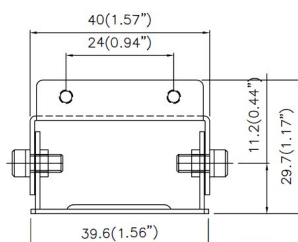
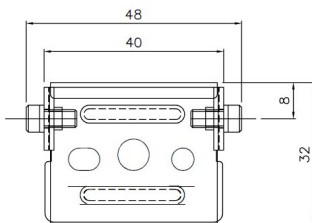
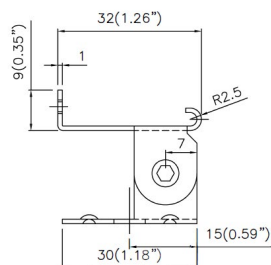

FLAT BRACKETS

DESCRIPTION

PART NUMBER

HB30 FLAT BRACKET.....AL-HB30-FLAT BRACKET

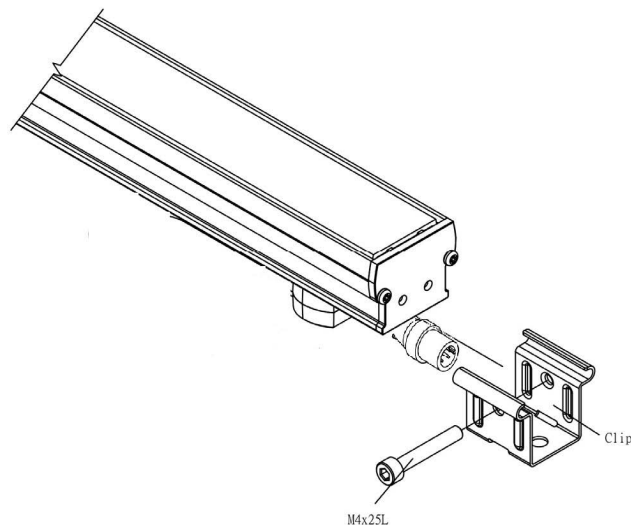
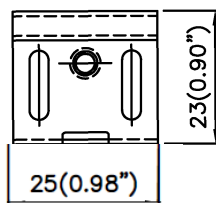
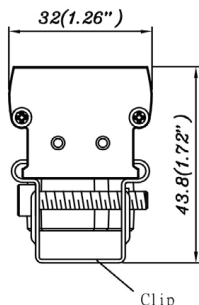
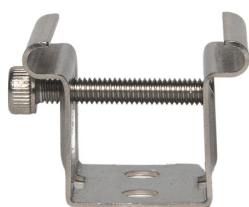
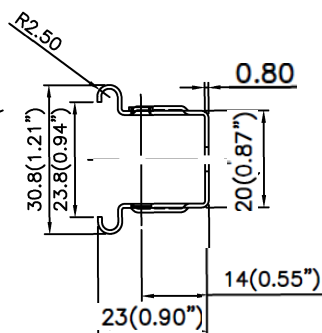
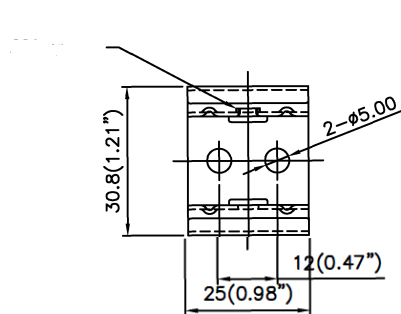

Date:

Firm:

Project:

Contact:

LOUVERS

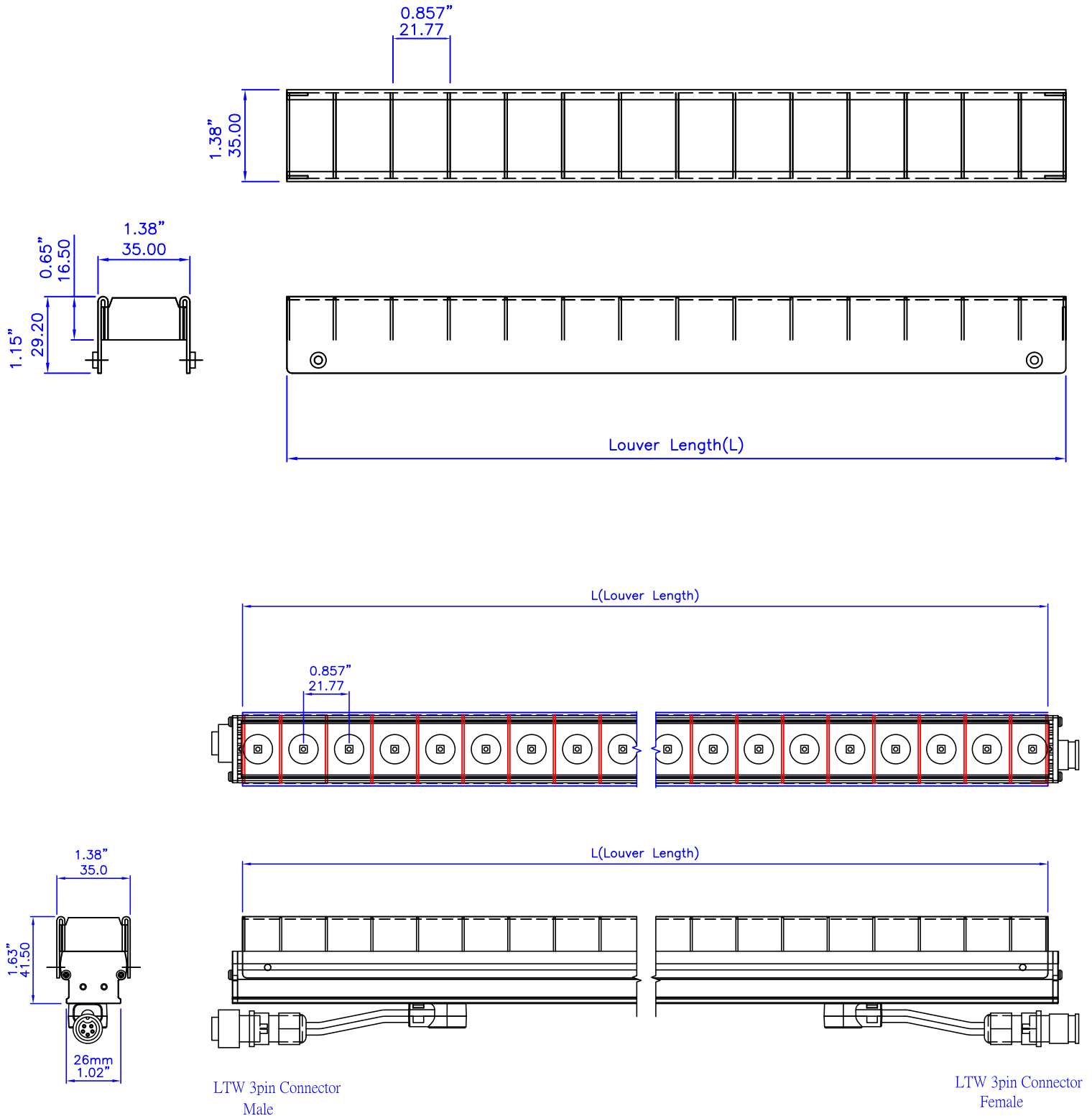

Date:

Firm:

Project:

Contact:

EXTRUSIONS AND EXTENDED ARMS

HB30EXT-XXL-XXF-XXA

(L=Length, F=Finish, A= Extended arm length)

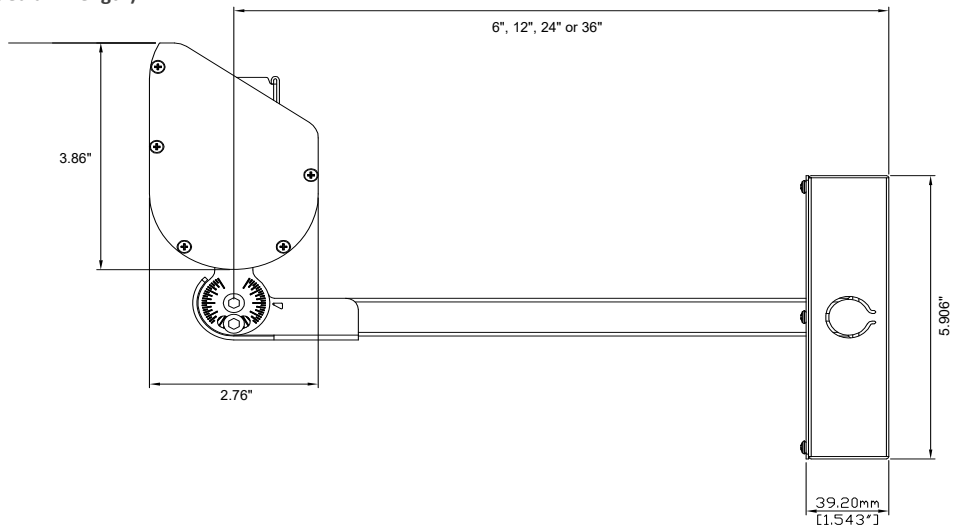

GROUND POST STAKES

HBEXP-GPS

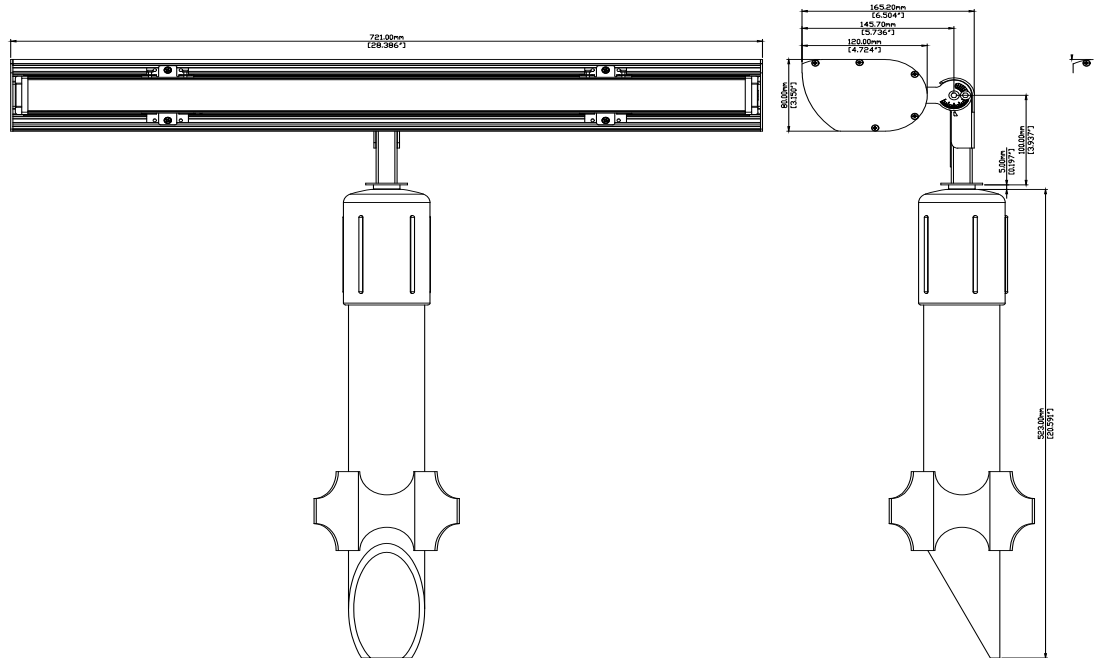

- * 1ft & 2ft extrusions require one HBEXP-GPS.
- * 3ft & 4ft extrusions require two HBEXP-GPS

Date:

Firm:

Project:

Contact: