

HB3014

EXTERIOR LINEAR LED LIGHTBAR

POWERFUL | COMPACT | LOW PROFILE
4.5w/ft | 486lm/ft - 7.0w/ft | 700lm/ft

Wall Washing | Grazing | Cove | Signage |
General Lighting



Meet The Smart Lighting Company HB3014 Series —economical, high-performance lighting in a compact form able to support run lengths of up to 300 feet and illumination heights over 15 feet. These linear fixtures are ingeniously designed to fit into the tightest of spaces, providing uniform, high-quality light courtesy of Nichia bin-sorted LEDs. The series boasts an extensive range of customizable features, from fixture output and length to color temperature and optical lenses, all available in various mounting options and finishes. An integrated universal power supply, coupled with full thermal management and a plug and play cable system, ensures installation is straightforward and efficient. The HB3014 also offers an assortment of accessories, like powder-coated housings with an integral glare shield, to enhance functionality. Ideal for precise grazing, impactful wall-washing, and vibrant sign lighting, this series adapts to your lighting needs without compromise.



SPECIFICATIONS

Date: _____

Type: _____

Project: _____

Firm: _____

PERFORMANCE

Output

4.5w/ft | 486m/ft, 7.0w/ft | 700lm/ft
(custom lower wattages available)

Color Temperatures

22k, 27k, 30k, 35k, 41k, 50k, 65k, R, G, B, A

Beam Angles

15°, 30°, 45°, 60°, 75°, 90°, 120°, 30°x60°

LEDs per Foot

14

LED's

Nichia bin-sorted

Color Consistency

2 SCDM

CRI

85 std, 95 optional

ELECTRICAL

Input Voltage

100-277vac

Power Supply

Integral

Control

0-10v dimming

Heat dissipation

Full thermal management system

Connection

Quick connect plug and play system

Projected Lumen Maintenance

>90,000 hours

PHYSICAL

Fixture Length Options

12", 24", 36", 48"

Max Run Length

4w - 295ft@277vac, 128ft@120vac

7w - 158ft@277vac, 68ft@120vac

Housing

Anodized extruded aluminum, tooled end caps

Lens

Polycarbonate

Fixture Finish (Standard)

Anodized aluminum

Powder Coated Finish (Optional)

Black, Bronze, White, CU

Standard Mounting

Stainless adjustable or flat brackets

Optional Mounting

Powder-coated housing | extended arms or
ground post stakes

Operating Temperature

-40°F to 122°F, (-40°C to 50°C)

ENVIRONMENT AND WARRANTY

IP Rating

IP66

Environment

Dry, Damp or Wet locations

0-100% non condensing humidity

Certifications

UL, cUL

Warranty

5 year limited warranty

HB3014 EXTERIOR LINEAR LED LIGHTBAR

SPECIFICATIONS

Date:

Type:

Project:

Firm:

OPTICS

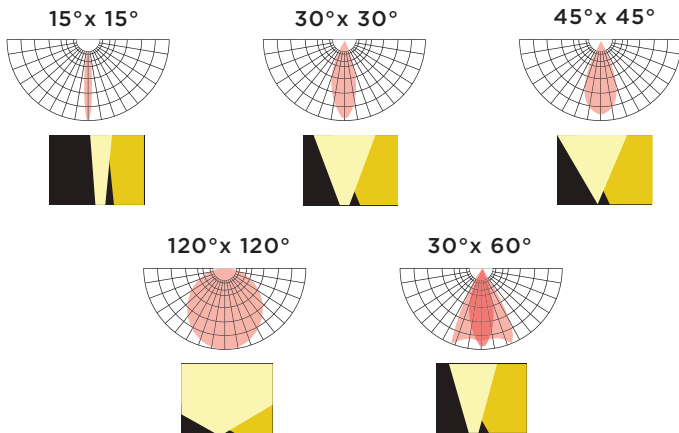

COLOR TEMPERATURES

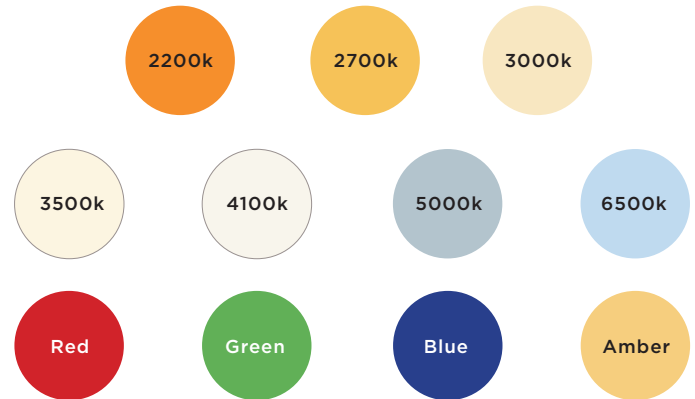

DIMENSIONS AND DATA

4.5w/ft	Voltage	View Angle	Watts/Fixture	Lumens/Fixture	LEDs/Fixture	Extrusion Length	Total Length
HB3014-12-XXK-XXD-ACD-4	100-277VAC	15°, 30°	4.5w	486	14	L=305.9mm	L=306.8mm (12.1")
HB3014-24-XXK-XXD-ACD-4		45°, 60°	9w	972	28	L=606.8mm	L=611.8mm (24.1")
HB3014-36-XXK-XXD-ACD-4		75°, 90°	13.5w	1458	42	L=911.4mm	L=916.4mm (36.1")
HB3014-48-XXK-XXD-ACD-4		30°x60° 120°	18w	1944	56	L=1216.2mm	L=1221.2mm (48.1")
7.0w/ft	Voltage	View Angle	Watts/Fixture	Lumens/Fixture	LEDs/Fixture	Extrusion Length	Total Length
HB3014-12-XXK-XXD-ACD-7	100-277VAC	15°, 30°	7w	700	14	L=305.9mm	L=306.8mm (12.1")
HB3014-24-XXK-XXD-ACD-7		45°, 60°	14w	1400	28	L=606.8mm	L=611.8mm (24.1")
HB3014-36-XXK-XXD-ACD-7		75°, 90°	24w	2100	42	L=911.4mm	L=916.4mm (36.1")
HB3014-48-XXK-XXD-ACD-7		30°x60° 120°	28w	2800	56	L=1216.2mm	L=1221.2mm (48.1")

PROFILE

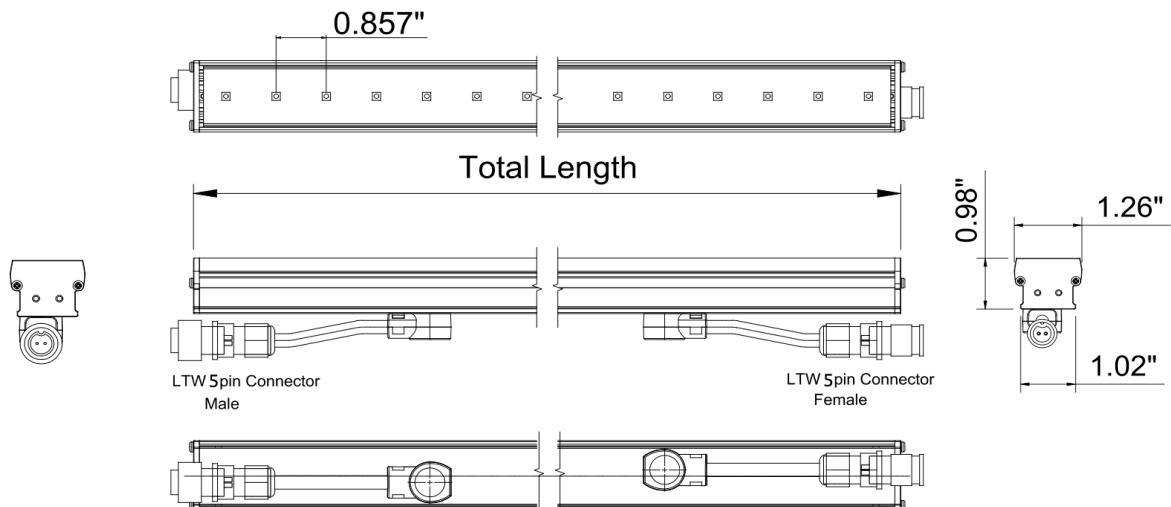

ORDER FORM

Date: _____

Type: _____

Project: _____

Firm: _____

CREATE YOUR FIXTURE

Ex. HB3014-48-30K-45-ACD-4

MODEL	LENGTH	COLOR	OPTICS
HB3014	12" 12 inches 24" 24 inches 36" 36 inches 48" 48 inches	22k 2200k R Red 27k 2700k G Green 30k 3000k B Blue 35k 3500k A Amber 41k 4100k * RGBA not available in 7w/ft 50k 5000k 65k 6500k	15 15°x15° 30 30°x30° 45 45°x45° 60 60°x60° 75 75°x75° 90 90°x90° 120 120°x120° 3060 30°x60°
VOLTAGE	CONTROL	POWER	
AC 100-277vac	D 0-10v Dimming ND Non Dimming	4 4.5w/ft 7 7.0w/ft	

SELECT CONNECTION

Wire Lead

QTY	POWER/SIGNAL	
	AL-HB5P-72"-W/L	72" (6ft) Wire lead 5pin
	AL-HB5P-xx"-W/L	xx" (CU) Wire lead 5pin
QTY	POWER	
	AL-HB3P-72"-W/L	72" (6ft) Wire lead 3pin
	AL-HB3P-xx"-W/L	xx" (CU) Wire lead 3pin

* 1 wire lead required for each run.

End Cap

QTY	**Select 5p for dimming or 3p for non-dimming	
	AL-HBxP-ENDCAP	For fixture output at end of run

* 1 End cap required at the end of each run

Jumper Cable

QTY	POWER/SIGNAL	
	AL-HB5P-12"-J	12" (1ft) jumper 5pin
	AL-HB5P-72"-J	72" (6ft) jumper 5pin
	AL-HB5P-xx"-J	xx" (CU) jumper 5pin
QTY	POWER	
	AL-HB3P-12"-J	12" (1ft) jumper 3pin
	AL-HB3P-72"-J	72" (6ft) jumper 3pin
	AL-HB3P-xx"-J	xx" (CU) jumper 3pin

* Fixtures are end to end connected. Use jumpers if space is needed between fixtures.

SELECT MOUNTING

QTY	MOUNTING BRACKETS - 2 PER FIXTURE	
	AL-HB30-ADJ BRACKET	HB30 Adjustable bracket
	AL-HB30-FLAT BRACKET	HB30 Flat bracket

* Select flat brackets if fixture is mounted in powder coated housing

ADDITIONAL OPTIONS

Optional Powder Coated Finish

QTY	Powder coated finishes available for additional cost	
	BK	Black
	BZ	Bronze
	WH	White
	CU	Custom

* Fixture housing is anodized aluminum standard

0-10V Dimmer

QTY		
	LUT-DVSTV-WH	0-10v dimming wall switch

Surge Protection

QTY		
	LSP4-UNV	120/277v surge protector

ADDITIONAL MOUNTING OPTIONS

Housing and Extended Arms

Fixture can be mounted in a powder coated housing with integral glare shield

QTY	Housing	(L) Housing Length	(F) Finish	(A) Extended Arm Length
	HB30EXT-	12"	BK - Black	6"
		24"	BZ- Bronze	12"
		36"	WH - White	18"
		48"	SI - Silver	24"
			CU - Custom	36"
				GPA (Ground Post Arm)

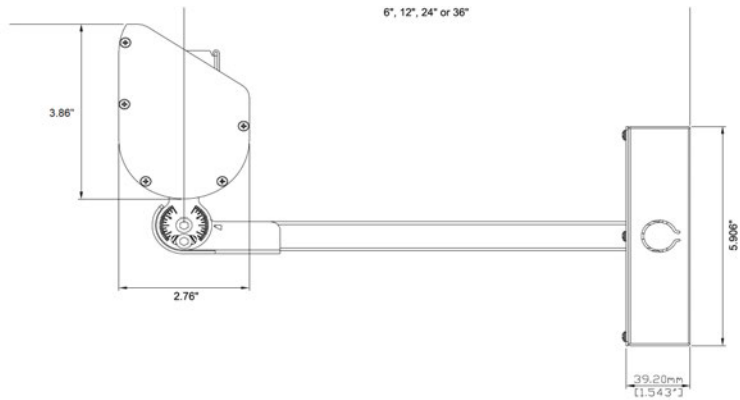

Ground Posts

QTY	Select when using GPA above (1 per fixture for 12" & 24" housing and 2 for 36" & 48" housing)
HBEXT-GPS	Ground post mount

1ft & 2ft extrusions require one HBEXT-GPS. 3ft & 4ft extrusions require two HBEXT-GPS.

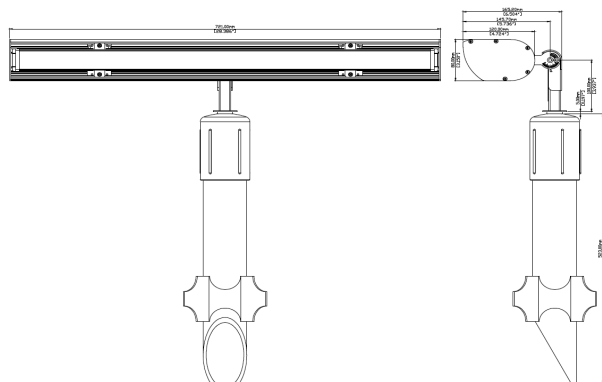

LOUVERS

Glare Control

Standard black finish powder coated louvers

QTY	Housing	(L) Housing Length	(F) Finish
	HB30-12" LOUVER	12"	BK - Black
	HB30-24" LOUVER	24"	BZ - Bronze
	HB30-36" LOUVER	36"	WH - White
	HB30-48" LOUVER	48"	SI - Silver
			CU - Custom

* Other powder coated finishes available for additional cost

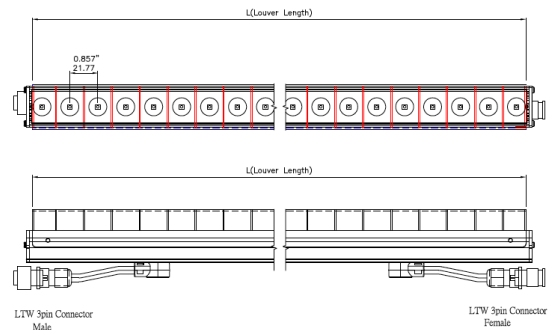
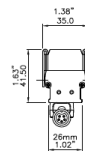
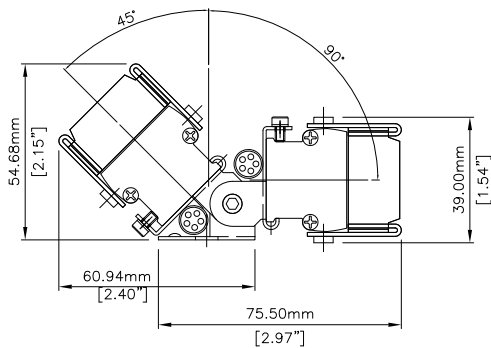
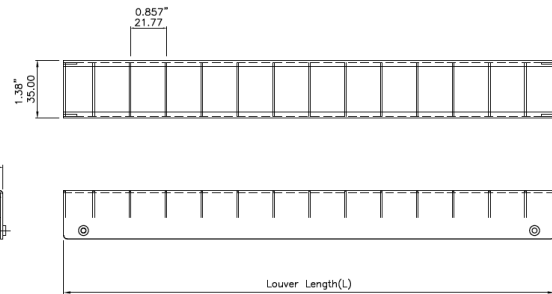
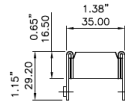
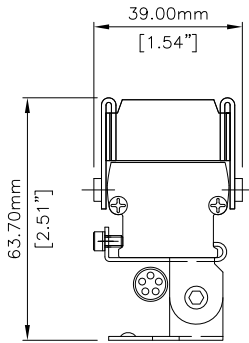

WIRE LEAD

DESCRIPTION

5 pin power / signal wire

PART NUMBER

AL-HB5P-xx"-W/L

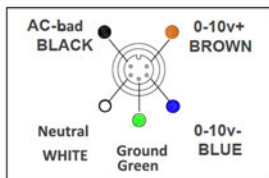
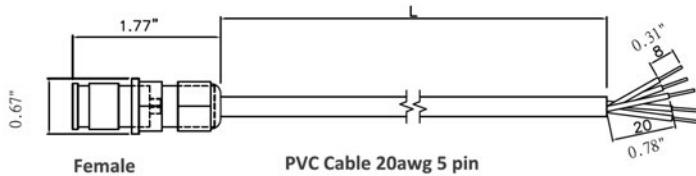

DESCRIPTION

3 pin power wire

PART NUMBER

AL-HB3P-xx"-W/L

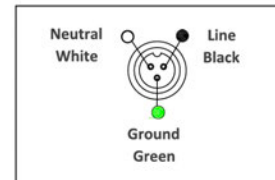
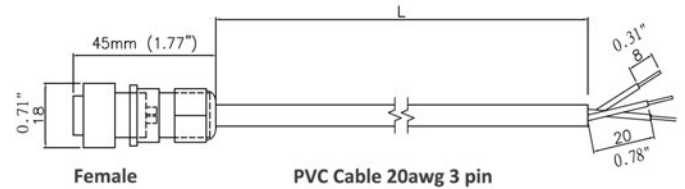

JUMPER CABLE

DESCRIPTION

5 pin power / signal jumper

PART NUMBER

AL-HB5P-xx"-W/L

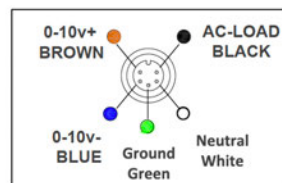
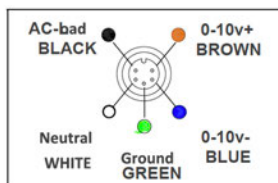
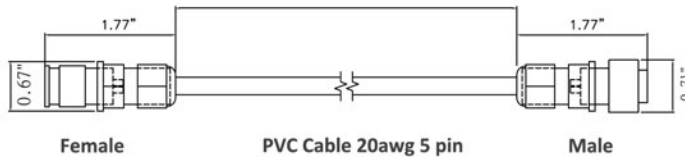

DESCRIPTION

3 pin power jumper

PART NUMBER

AL-HB3P-xx"- J

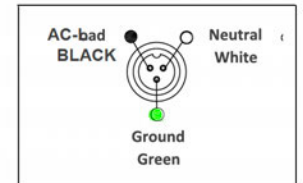
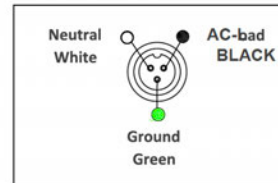
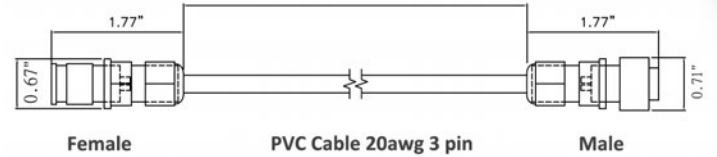

ADJUSTABLE BRACKETS

DESCRIPTION

HB30 Adjustable Bracket

PART NUMBER

AL-HB30 ADJ.Bracket

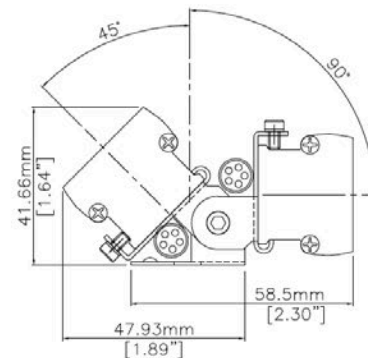
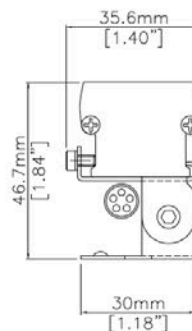
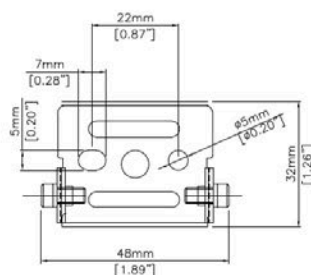
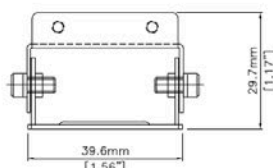
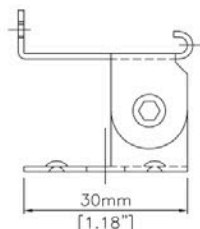

FLAT BRACKETS

DESCRIPTION

HB30 Flat Bracket

PART NUMBER

AL-HB30-Flat Bracket

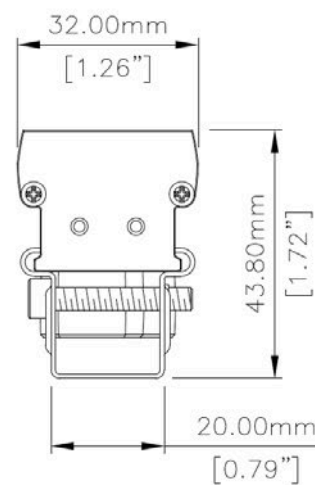
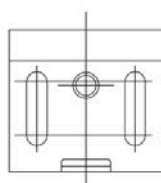
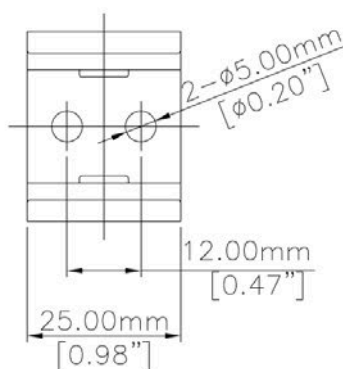
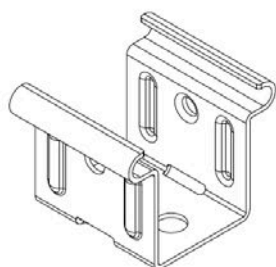

SURGE PROTECTION

DESCRIPTION

Surge Protection Device

PART NUMBER

AL-LSP-UNV

The use of a surge protection device is necessary to maintain your warranty. Specifications are subject to change without notice.

SPECIFICATIONS

Input Voltage	120-277V (+/- 5%)		
Frequency	50Hz-60Hz		
Maximum Continuous Voltage	320V		
Maximum Discharge Current	L-N 20kA; L-G, N-G 10kA (8/20Qs standard wave)		
Nominal Discharge Current	5kA		
Measured Limiting Voltage (VpK)	L-N	L-G	N-G
	1200	1320	1320
Max Case Temperature	85°C		

PULSE RATING (8 X 20 SEC)		
Surge Level	# of Strikes	
	L-N	L-G, N-G
10,000A	*2	1
6,500A	4	2
5,000A	30	15
2,000A	200	100
700A	20000	1000

*1 strike at 20,000A

MECHANICAL DIMENSIONS : IN (MM)

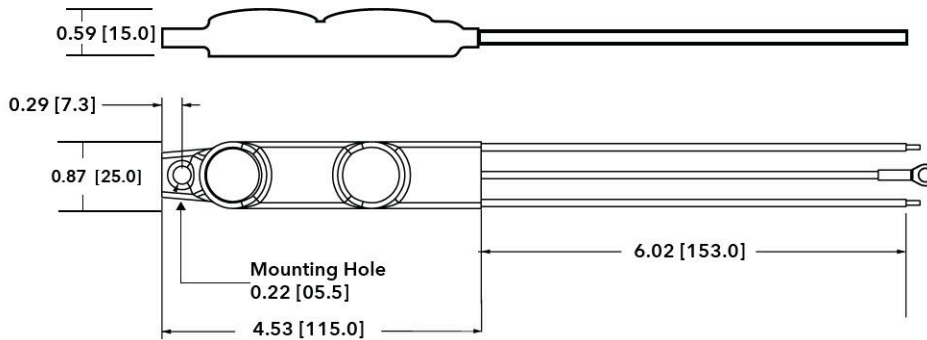

WIRING DIAGRAM

