



HB3014IR

POWERFUL | COMPACT | LOW PROFILE
4.5w/ft-7w/ft | 365-458lm/ft

INTERIOR LINEAR LED LIGHTBAR

Direct View | Accent | General Lighting

The Smart Lighting Company HB3014ir Series is an affordable, specification-grade fixture for challenging spaces that demand compact, yet high-performance lighting. This luminaire serves as an energy and maintenance saving replacement for fluorescent tubes, offering superior accent to highlight building lines, our general illumination, such as under a canopy. It boasts a dome lens within its slim profile, and is available in two power options—4.5w/ft for an output of 365lm/ft and 7w/ft for a higher output of 458lm/ft. Its versatility shines with a universal 100/277VAC integral driver, availability in four sizes, and a wide selection of color temperatures to complement any design aesthetic. The HB3014ir has a compact size that fits unobtrusively into narrow spaces while providing even, high-quality light from Nichia bin-sorted LEDs. Customization is key, with an assortment of fixture lengths, mounting styles, and finishes available. Each fixture is built with a comprehensive thermal management system and a convenient Plug and Play cable system, ensuring installation is both straightforward and adaptable, with options for bottom or side wire feed for a lower profile. Capable of extended single runs over 250 feet, the HB3014ir is the ideal solution for consistent, high-quality illumination.



HB30i Series



SPECIFICATIONS

PERFORMANCE

Output

4.5w/ft - 365lm/ft | 7w/ft - 458m/ft

Color Temperatures

22k, 25k, 27k, 30k, 35k, 41k, 50k, 65k, R, G, B, A

Beam Angles

120°

LEDs per Foot

14

LED's

Nichia bin-sorted

Color Consistency

2 SCDM

CRI

85 standard, 95 optional

ELECTRICAL

Input Voltage

100-277vac

Power Supply

Integral

Control

0-10v dimming

Heat dissipation

Full thermal management system

Connection

Quick connect plug and play system
(power and signal in one cable)

Projected Lumen Maintenance

>90,000 hours

PHYSICAL

Fixture Length Options

1', 2', 3' 4'

Max Run Length

4.5w - 251ft@277vac, 109ft@120vac

7.5w - 147ft@277vac, 64ft@120vac

Housing

Anodized extruded aluminum, tooled end caps

Lens

Polycarbonate

Fixture Finish (Standard)

Anodized aluminum

Powder Coated Finish (Optional)

Black, Bronze, White, CU

Standard Mounting

Stainless adjustable or flat brackets

Operating Temperature

-40°F to 122°F, (-40°C to 50°C)

ENVIRONMENT AND WARRANTY

IP Rating

IP40

Environment

Dry locations

Certifications

UL, cUL

Warranty

5 year limited warranty

OPTICS

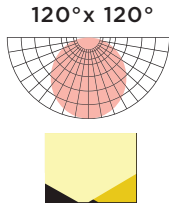

COLOR TEMPERATURES



DIMENSIONS AND DATA

	Voltage	View Angle	Watts/ Fixture	Lumens/ Fixture	LEDs/ Fixture	Extrusion Length	Total Length
HB3014ir-1-XXK-XXD-ACD-4	100-277VAC	15°, 30° 45°, 120° 30°x60°	4.9w	365	14	L=305.9mm	L=306.8mm (12.1")
HB3014ir-2-XXK-XXD-ACD-4			9.6w	730	28	L=606.8mm	L=611.8mm (24.1")
HB3014ir-3-XXK-XXD-ACD-4			13.2w	1095	42	L=911.4mm	L=916.4mm (36.1")
HB3014ir-4-XXK-XXD-ACD-4			17.6w	1460	56	L=1216.2mm	L=1221.2mm (48.1")
HB3014ir-1-XXK-XXD-ACD-7	100-277VAC	15°, 30° 45°, 120° 30°x60°	7.0w	456	14	L=305.9mm	L=306.8mm (12.1")
HB3014ir-2-XXK-XXD-ACD-7			14.0w	912	28	L=606.8mm	L=611.8mm (24.1")
HB3014ir-3-XXK-XXD-ACD-7			21.0w	1370	42	L=911.4mm	L=916.4mm (36.1")
HB3014ir-4-XXK-XXD-ACD-7			28.0w	1828	56	L=1216.2mm	L=1221.2mm (48.1")

PROFILES

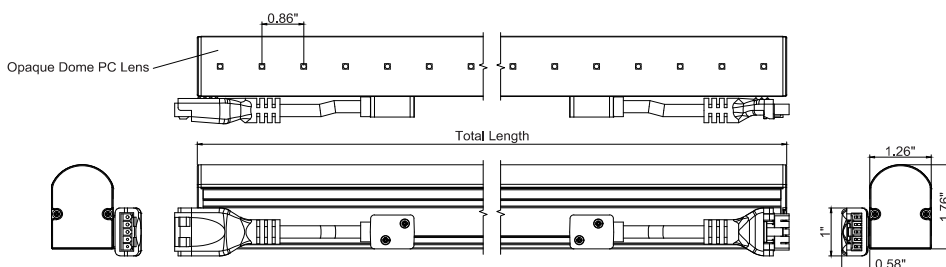
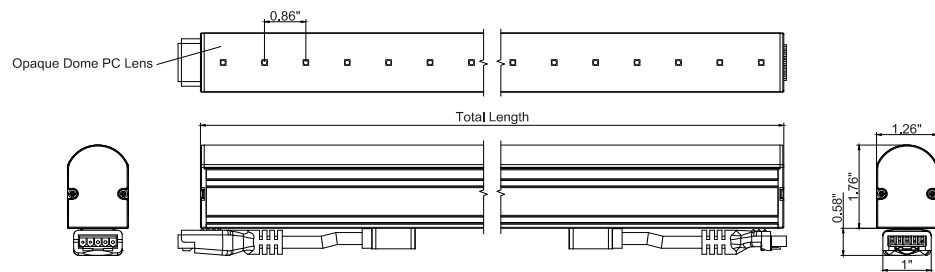

ORDER FORM

Date: _____

Type: _____

Project: _____

Firm: _____

CREATE YOUR FIXTURE

Ex. HB3014ir-4-30K-120-ACD

MODEL	LENGTH	COLOR	OPTICS
HB3014ir	1' 12 inches 2' 24 inches 3' 36 inches 4' 48 inches	22k 2200k R Red 25k 2500k G Green 27k 2700k B Blue 30k 3000k A Amber 35k 3500k 41k 4100k 50k 5000k 65k 6500k	120 120°x120°
VOLTAGE	CONTROL	POWER	
AC 100-277vac	D 0-10v Dimming ND Non Dimming	4 4.5w/ft 7 7.0w/ft	

SELECT CONNECTION

Wire Lead

QTY	POWER/SIGNAL	
	AL-ID5P-72"-W/L	72" (6ft) Wire lead 5pin
	AL-ID5P-xx"-W/L	xx" (CU) Wire lead 5pin
QTY	POWER	
	AL-ID3P-72"-W/L	72" (6ft) Wire lead 3pin
	AL-ID3P-xx"-W/L	xx" (CU) Wire lead 3pin

* 1 wire lead required for each run.

End Cap

QTY		
	AL-ID3P-ENDCAP	End cap for fixture output at end of run

* 1 End cap required at the end of each run

Jumper Cable

QTY	POWER/SIGNAL	
	AL-ID5P-12"-J	12" (1ft) jumper 5pin
	AL-ID5P-72"-J	72" (6ft) jumper 5pin
	AL-ID5P-xx"-J	xx" (CU) jumper 5pin
QTY	POWER	
	AL-ID3P-12"-J	12" (1ft) jumper 3pin
	AL-ID3P-72"-J	72" (6ft) jumper 3pin
	AL-ID3P-xx"-J	xx" (CU) jumper 3pin

* Fixtures are end to end connected. Use jumpers if space is needed between fixtures.

ADDITIONAL OPTIONS

Optional Powder Coated Finish

QTY	Powder coated finishes available for additional cost
	BK Black
	BZ Bronze
	WH White
	CU Custom

* Fixture housing is anodized aluminum standard

0-10V Dimmer

QTY		
	LUT-DVSTV-WH	0-10v dimming wall switch

Surge Protection

QTY		
	LSP4-UNV	120/277v surge protector

SELECT MOUNTING

QTY	MOUNTING BRACKETS - 2 PER FIXTURE	
	AL-ID30-ADJ BRACKET	HB30i Adjustable bracket
	AL-ID30-FLAT BRACKET	HB30i Flat bracket bottom wire feed
	AL-ID30-FSF BRACKET	HB30i Flat bracket side wire feed

WIRE LEAD

DESCRIPTION

5 pin power / signal wire

PART NUMBER

AL-ID5P-xx"-W/L

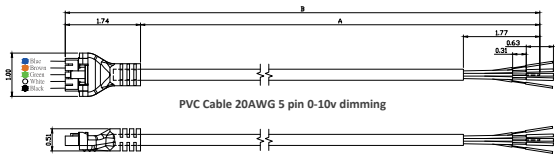

Wire color	Description
● Black	AC_L
○ White	AC_N
● Green	Ground
● Brown	1~10V+ or DMX+
● Blue	1~10V- or DMX-

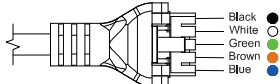

5Pin Female



DESCRIPTION

3 pin power wire

PART NUMBER

AL-ID3P-xx"-W/L

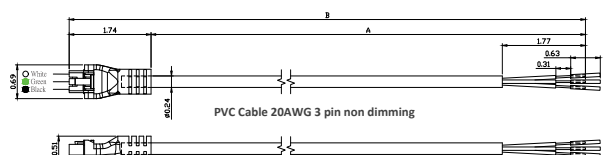

Wire color	Description
● Black	AC_L
○ White	AC_N
● Green	Ground

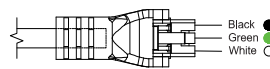

3Pin Female

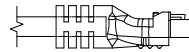

JUMPER CABLE

DESCRIPTION

5 pin power / signal jumper

PART NUMBER

AL-ID5P-xx"-J

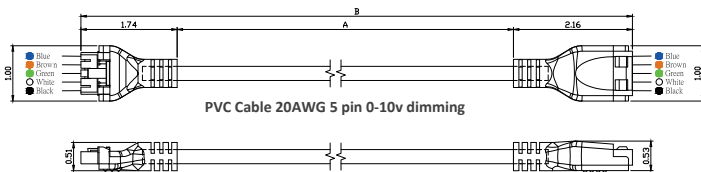

Wire color	Description
● Black	AC_L
○ White	AC_N
● Green	Ground
● Brown	1~10V+ or DMX+
● Blue	1~10V- or DMX-



5Pin Female

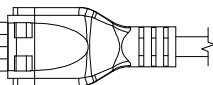

5Pin Male

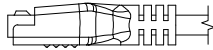

DESCRIPTION

3 pin power jumper

PART NUMBER

AL-ID3P-xx"- J

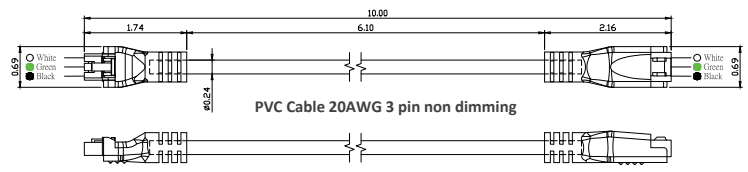

Wire color	Description
● Black	AC_L
○ White	AC_N
● Green	Ground



3Pin Female

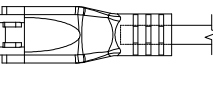

3Pin Male

MOUNTING BRACKETS

ADJUSTABLE BRACKETS

DESCRIPTION

HB30i Adjustable Bracket

PART NUMBER

AL-ID30 ADJ.Bracket

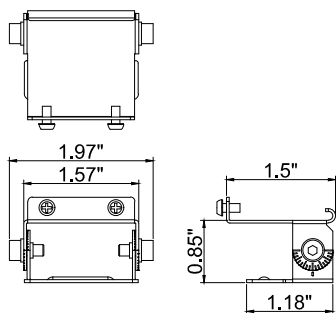

Clip C

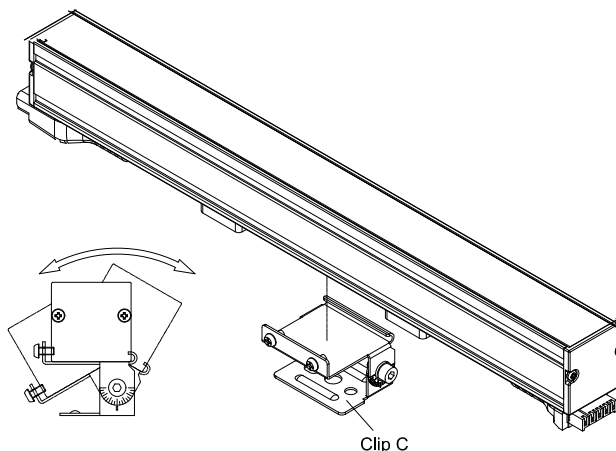

FLAT BOTTOM FEED BRACKETS

DESCRIPTION

HB30 Flat Bracket -
bottom wire feed

PART NUMBER

AL-ID30-Flat Bracket

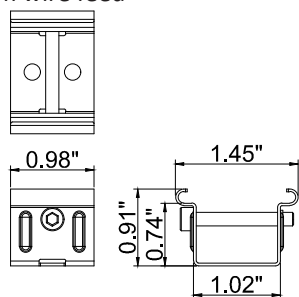

Clip B

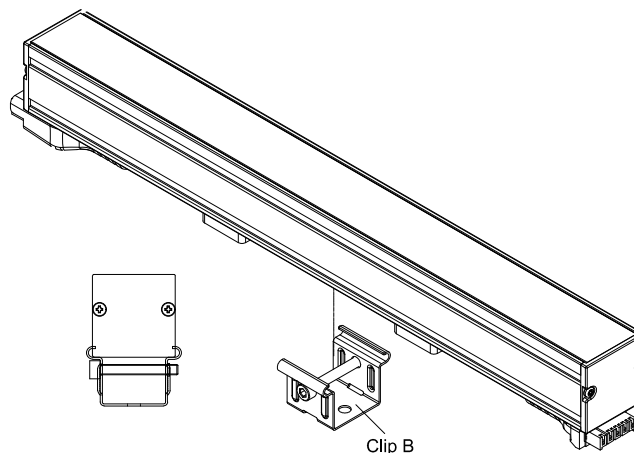

FLAT SIDE FEED BRACKETS

DESCRIPTION

HB30 Flat Bracket -
side wire feed

PART NUMBER

AL-ID30-FSF Bracket

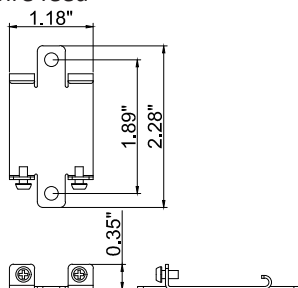

Clip A

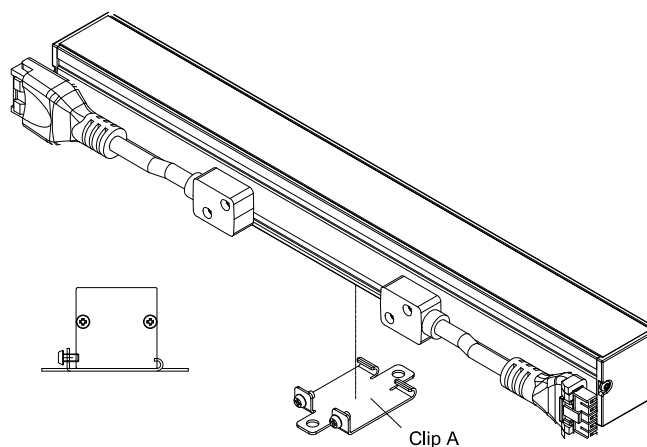

SURGE PROTECTION DEVICE

SURGE PROTECTION

DESCRIPTION

Surge Protection Device

PART NUMBER

AL-LSP-UNV

The use of a surge protection device is necessary to maintain your warranty. Specifications are subject to change without notice.

SPECIFICATIONS

Input Voltage	120-277V (+/- 5%)		
Frequency	50Hz-60Hz		
Maximum Continuous Voltage	320V		
Maximum Discharge Current	L-N 20kA; L-G, N-G 10kA (8/20Qs standard wave)		
Nominal Discharge Current	5kA		
Measured Limiting Voltage (VpK)	L-N	L-G	N-G
	1200	1320	1320
Max Case Temperature	85°C		

PULSE RATING (8 X 20 SEC)		
Surge Level	# of Strikes	
	L-N	L-G, N-G
10,000A	*2	1
6,500A	4	2
5,000A	30	15
2,000A	200	100
700A	20000	1000

*1 strike at 20,000A

MECHANICAL DIMENSIONS : IN (MM)

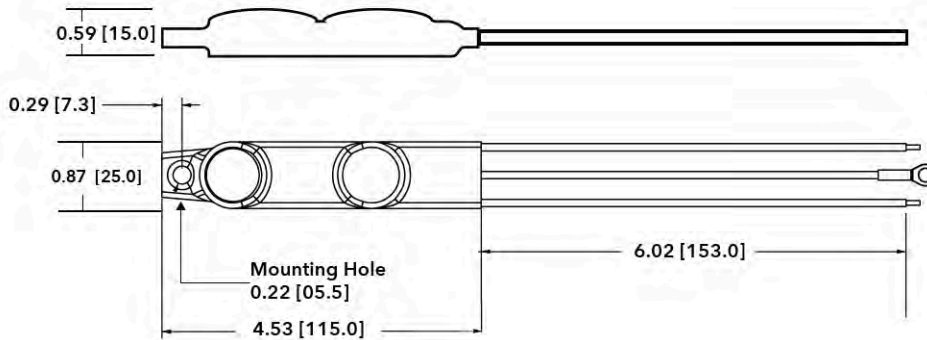

WIRING DIAGRAM

