



HB3015 RGB

EXTERIOR LINEAR LED LIGHTBAR

POWERFUL | COMPACT | LOW PROFILE
6w/ft | RGB | DMX

Wall Washing | Grazing | Cove Lighting

Maximize the impact of exterior lighting with The Smart Lighting Company HB3015 RGB Series, a sophisticated and high-performance linear luminaire. This DMX controlled, RGB color-changing fixture is engineered in a sleek, low-profile form, making it perfect for intricate wall grazing, washing, and vibrant cove lighting at an efficient 6 watts per foot. Available in four lengths, the HB3015 RGB is equipped with a universal 100/277VAC integral driver and utilizes Nichia bin-sorted LEDs for precise, even illumination highly regarded by industry experts. Crafted for durability, it boasts an extruded anodized aluminum housing with precision-tooled end caps and has multiple options for fixture length, optics, mounting, and finishes. The robust Plug and Play connectors ensure a secure IP66 rated connection and simplify installation. With DMX control and self-addressing capability for easy programming and operation and various accessory choices, including louvers and mounting options, the HB3015 RGB stands as the economical lighting solution for dynamic, high-quality outdoor illumination.



SPECIFICATIONS

Date: _____
Type: _____
Project: _____
Firm: _____

PERFORMANCE

Output

6w/ft

Color Temperatures

RGB

Beam Angles

15°, 30°, 45°, 60°, 75°, 90°, 120°, 30°x60°

LEDs per Foot

15 (5R, 5G, 5B)

LED's

Nichia bin-sorted

Color Consistency

2 SCDM

ELECTRICAL

Input Voltage

100-277vac

Power Supply

Integral

Control

DMX

Resolution

Per 12" or per fixture

Heat dissipation

Full thermal management system

Connection

Quick connect plug and play system

Projected Lumen Maintenance

>90,000 hours

PHYSICAL

Fixture Length Options

12", 24", 36", 48"

Max Run Length

197ft@277vac, 85ft@120vac

Housing

Anodized extruded aluminum, tooled end caps

Lens

Polycarbonate

Fixture Finish (Standard)

Anodized aluminum

Powder Coated Finish (Optional)

Black, Bronze, White, CU

Standard Mounting

Stainless adjustable or flat brackets

Optional Mounting

Powder-coated housing | extended arms or ground post stakes

Operating Temperature

-40°F to 122°F, (-40°C to 50°C)

ENVIRONMENT AND WARRANTY

IP Rating

IP66

Environment

Dry, Damp or Wet locations
0-100% non-condensing humidity

Certifications

UL, cUL

Warranty

5 year limited warranty

SPECIFICATIONS

Date: _____

Type: _____

Project: _____

Firm: _____

OPTICS

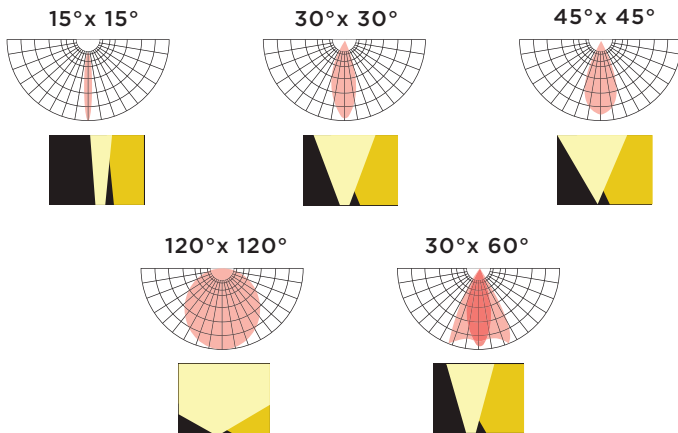

COLOR TEMPERATURES



DIMENSIONS AND DATA

6w/ft	Voltage	View Angle	Watts/ Fixture	Lumens/ Fixture	LEDs/ fixture	Extrusion Length	Total Length
HB3015-12-RGB-XXD-AC-DX	100-277VAC	15°, 30°, 45°	6w	TBD	5R,5G,5B	L=301.8mm	L=306.8mm (12.1")
HB3015-24-RGB-XXD-AC-DX		60°, 75°, 90°, 120°	11.4w	TBD	10R, 10G, 10B	L=606.8mm	L=611.8mm (24.1")
HB3015-36-RGB-XXD-AC-DX		30°x60°	16.8w	TBD	15R, 15G, 15B	L=911.4mm	L=916.4mm (36.1")
HB3015-48-RGB-XXD-AC-DX			22.4w	TBD	20R, 20G, 20B	L=1216.2mm	L=1221.2mm (48.1")

PROFILE

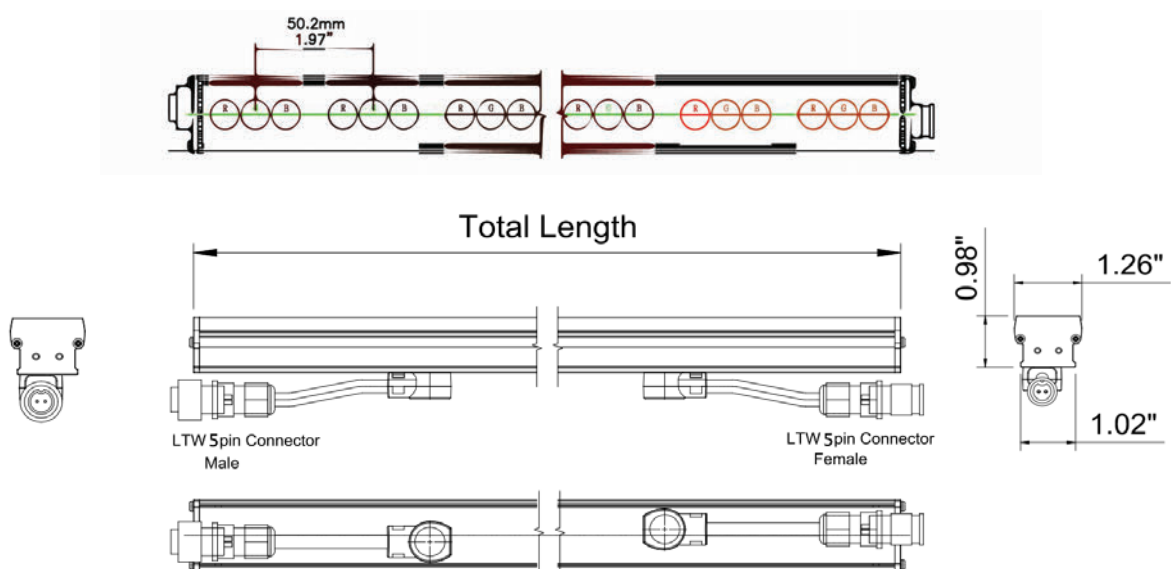

ORDER FORM

Date: _____

Type: _____

Project: _____

Firm: _____

Ex. HB3015-48-RGB-15-AC-DM

CREATE YOUR FIXTURE

MODEL HB3015	LENGTH 12" 12 inches 24" 24 inches 36" 36 inches 48" 48 inches	COLOR RGB RGB	OPTICS 15 15°x15° 30 30°x30° 45 45°x45° 60 60°x60° 75 75°x75° 90 90°x90° 120 120°x120° 3060 30°x60°
VOLTAGE AC 100-277vac	CONTROL DM Addressable/12" DS Addressable/fixture		

SELECT CONNECTION

Wire Lead

QTY	POWER/SIGNAL	
	AL-HB5P-72"-W/L	72" (6ft) Wire lead 5pin
	AL-HB5P-xx"-W/L	xx" (CU) Wire lead 5pin

* 1 wire lead required for each run.

End Cap

QTY		
	AL-HB5P-ENDCAP	End cap for fixture output at end of run

* 1 End cap required at the end of each run

Jumper Cable

QTY	POWER/SIGNAL	
	AL-HB5P-12"-J	12" (1ft) jumper 5pin
	AL-HB5P-72"-J	72" (6ft) jumper 5pin
	AL-HB5P-xx"-J	xx" (CU) jumper 5pin

* Fixtures are end to end connected. Use jumpers if space is needed between fixtures.

ADDITIONAL OPTIONS

Optional Powder Coated Finish

QTY	Powder coated finishes available for additional cost
	BK Black
	BZ Bronze
	WH White
	CU Custom

* Fixture housing is anodized aluminum standard

DMX Controller

QTY		
	NIC-DMX-STICK-DE3	DMX Controller

Surge Protection

QTY		
	LSP4-UNV	120/277v surge protector

Junction Boxes

QTY		
	AC5A-DMX-3WB3	Power and signal wire lead splitter
	AC5A-DMX-3WB2	AC Power amplifier for long run lengths

* Used in place of wire leads to separate power and signal

SELECT MOUNTING

QTY	MOUNTING BRACKETS - 2 PER FIXTURE
	AL-HB30-ADJ BRACKET HB30 Adjustable bracket
	AL-HB30-FLAT BRACKET HB30 Flat bracket

* Select flat brackets if fixture is mounted in powder coated housing

Housing and Extended Arms

	Housing	(L) Housing Length	(F) Finish	(A) Extended Arm Length
QTY				
	HB30EXT-	12"	BK - Black	6"
		24"	BZ- Bronze	12"
		36"	WH - White	18"
		48"	SI - Silver	24"
			CU - Custom	36"
				GPA (Ground Post Arm)

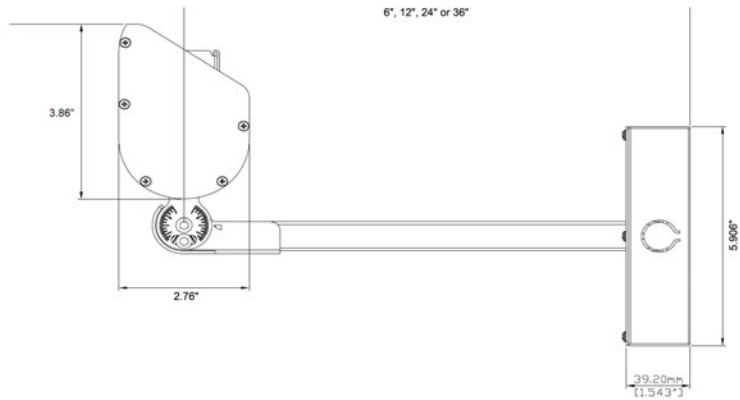

1ft & 2ft extrusions require one HBEXT-GPS. 3ft & 4ft extrusions require two HBEXT-GPS.

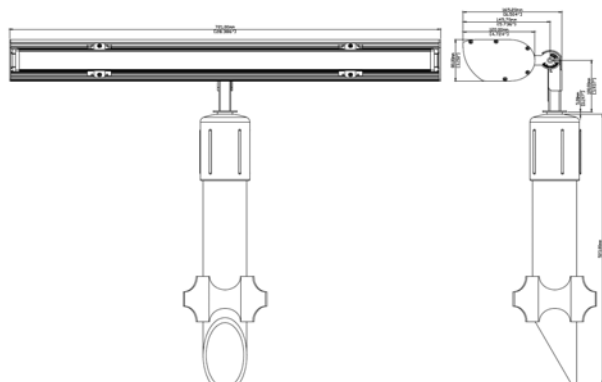

LOUVERS

Glare Control
Standard black finish powder coated louvers

QTY	Housing	(L) Housing Length	(F) Finish
	HB30-12" LOUVER	12"	BK - Black
	HB30-24" LOUVER	24"	BZ- Bronze
	HB30-36" LOUVER	36"	WH - White
	HB30-48" LOUVER	48"	SI - Silver
			CU - Custom

* Other powder coated finishes available for additional cost

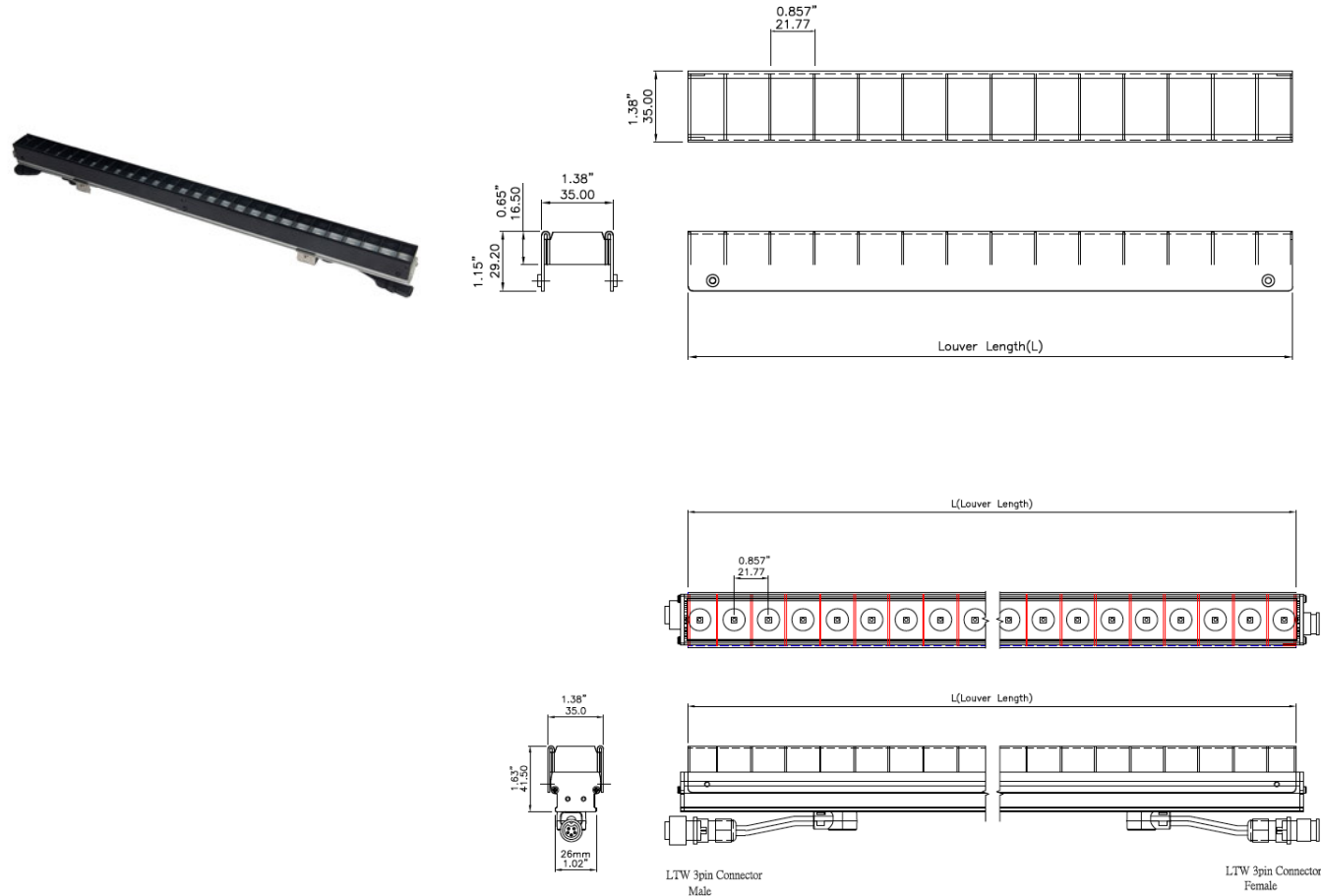

WIRE LEAD

DESCRIPTION

5 pin power / signal wire

PART NUMBER

AL-HB5P-xx"-W/L

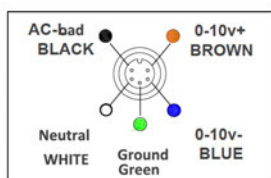
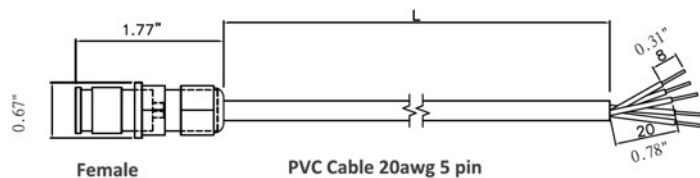

JUMPER CABLE

DESCRIPTION

5 pin power / signal jumper

PART NUMBER

AL-HB5P-xx"-W/L

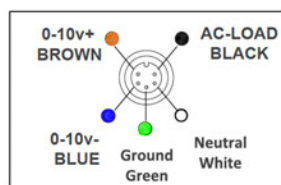
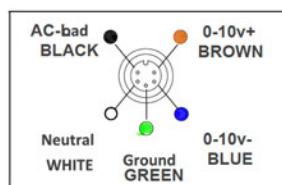
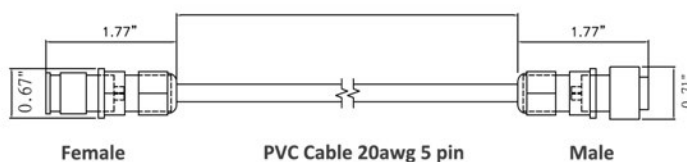

POWER/SIGNAL

DISTRIBUTION BOXES

Date: _____

Type: _____

Project: _____

Firm: _____

JUNCTION BOX - POWER AND SIGNAL SPLITTER

JUNCTION BOX

AC5A-DMX-3WB3

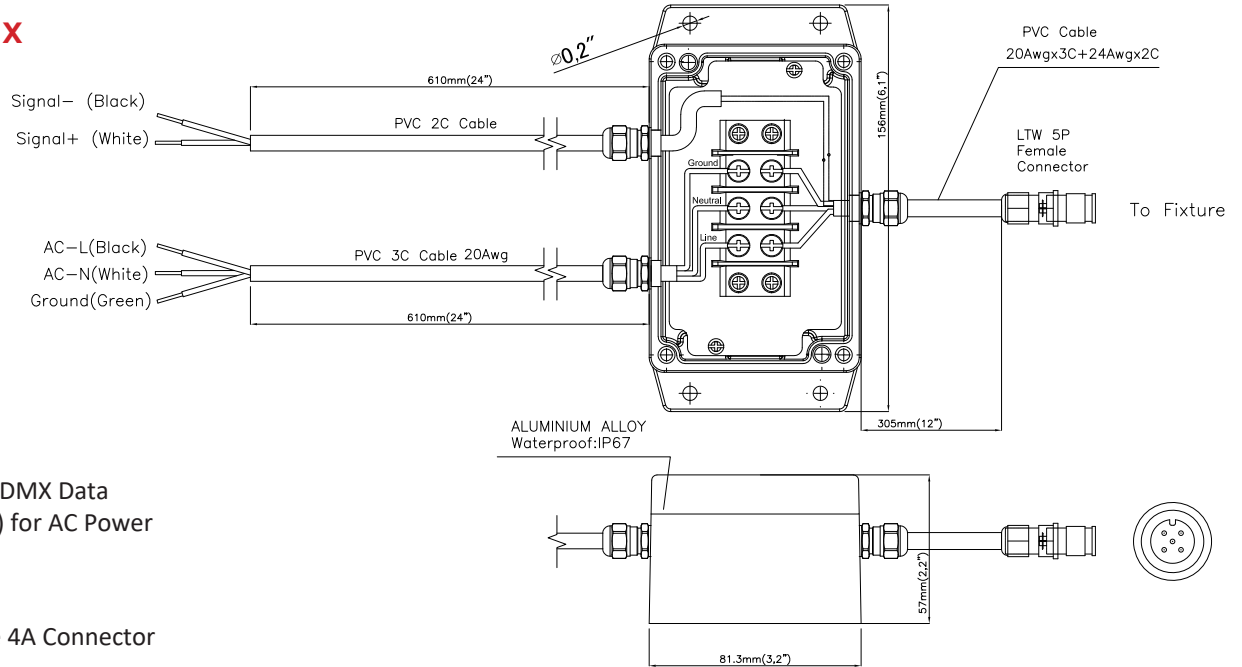

INPUT

24" Cable (2 leads) for DMX Data
24" PVC Cable (3 leads) for AC Power

OUTPUT

12" Cable w 5P Female 4A Connector

JUNCTION BOX-AC POWER AMPLIFIER FOR LONG RUN LENGTHS

JUNCTION BOX

AC5A-DMX-3WB2

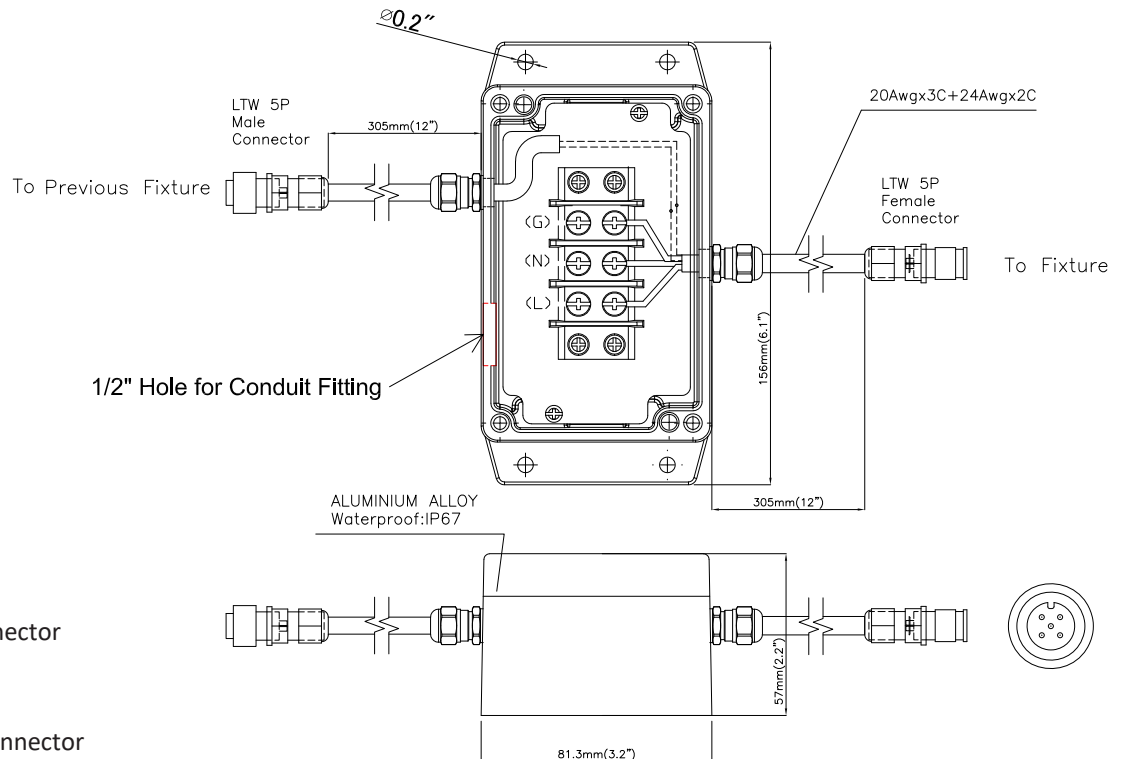

INPUT

12" PVC Cable w/ 5P Male 4A Connector

OUTPUT

12" PVC Cable w/ 5P Female 4A Connector

ADJUSTABLE BRACKETS

DESCRIPTION

HB30 Adjustable Bracket

PART NUMBER

AL-HB30 ADJ.Bracket

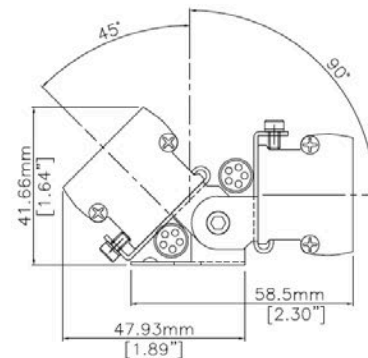
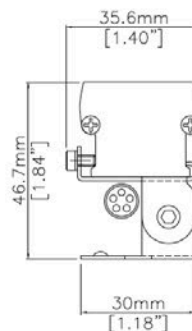
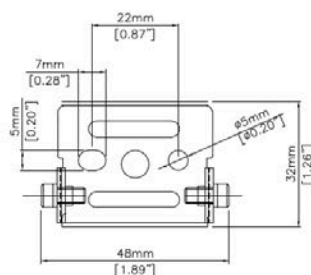
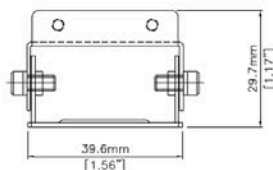
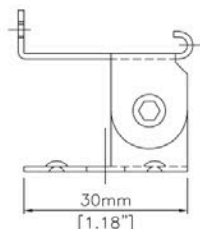

FLAT BRACKETS

DESCRIPTION

HB30 Flat Bracket

PART NUMBER

AL-HB30-Flat Bracket

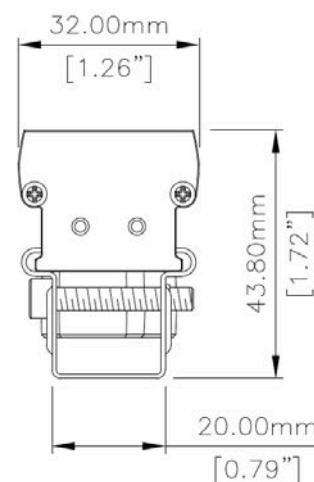
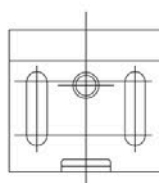
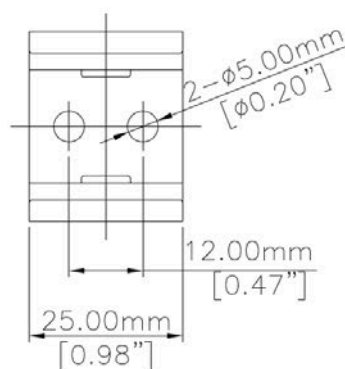
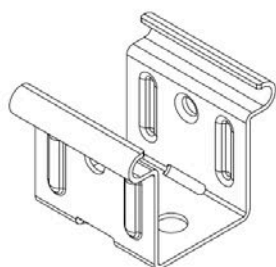

SURGE PROTECTION

DESCRIPTION

Surge Protection Device

PART NUMBER

AL-LSP-UNV

The use of a surge protection device is necessary to maintain your warranty. Specifications are subject to change without notice.

SPECIFICATIONS

Input Voltage	120-277V (+/- 5%)		
Frequency	50Hz-60Hz		
Maximum Continuous Voltage	320V		
Maximum Discharge Current	L-N 20kA; L-G, N-G 10kA (8/20Qs standard wave)		
Nominal Discharge Current	5kA		
Measured Limiting Voltage (VpK)	L-N	L-G	N-G
	1200	1320	1320
Max Case Temperature	85°C		

PULSE RATING (8 X 20 SEC)		
Surge Level	# of Strikes	
	L-N	L-G, N-G
10,000A	*2	1
6,500A	4	2
5,000A	30	15
2,000A	200	100
700A	20000	1000

*1 strike at 20,000A

MECHANICAL DIMENSIONS : IN (MM)

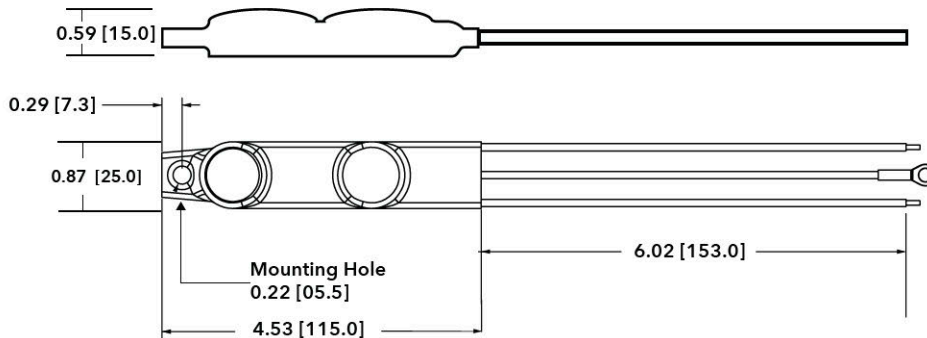

WIRING DIAGRAM

