



HB3016 RGBW

EXTERIOR LINEAR LED LIGHTBAR

POWERFUL | COMPACT | LOW PROFILE
6w/ft | 226lm/ft | RGBW | DMX

Grazing | Wall Washing | Cove | General Lighting

The Smart Lighting Company HB3016 RGBW Series is an economical high-performance, color-changing LED luminaire encased in a compact, low-profile package, engineered to deliver exceptional lighting for grazing, washing, cove, and general applications. Powered by a universal 100/277VAC driver and available in four adaptable sizes, it offers a spectrum of color temperatures to meet your design requirements. Our selection of Nichia bin-sorted LEDs ensures a bright, uniform output, renowned for its quality among architects and lighting designers. The energy-efficient optical lenses are fine-tuned to maximize luminosity with minimal power usage. Robustly built with an extruded anodized aluminum housing and precise tooled end caps, the fixture is IP66 rated. The HB3016 RGBW is designed for quick and efficient installation, featuring Plug and Play connectors and self-addressing for easy integration into DMX control systems. It offers extensive customization options, including adjustable length, various optics, multiple mounting choices, and a range of finishes.



SPECIFICATIONS

Date: _____

Type: _____

Project: _____

Firm: _____

PERFORMANCE

Output

6w/ft (5.4w/ft System) | 217lm/ft

Color Temperatures

RGBW

Beam Angles

15°, 30°, 45°, 60°, 75°, 90° 120°, 30°x60°

LEDs per Foot

16 (4R, 4G, 4B, 4W)

LED's

Nichia bin-sorted

Color Consistency

2 SCDM

ELECTRICAL

Input Voltage

100-277vac

Power Supply

Integral

Control

DMX

Resolution

Per 12" or per fixture

Heat dissipation

Full thermal management system

Connection

Quick connect plug and play system (one cable for power and signal)

Lumen Maintenance

90,000hrs

PHYSICAL

Fixture Length Options

12", 24", 36", 48"

Max Run Length

197ft@277vac, 85ft@120vac

Housing

Anodized extruded aluminum, tooled end caps

Lens

Polycarbonate

Fixture Finish (Standard)

Anodized aluminum

Powder Coated Finish (Optional)

Black, Bronze, White, CU

Standard Mounting

Stainless adjustable or flat brackets

Optional Mounting

Powder-coated housing | extended arms or ground post stakes

Operating Temperature

-40°F to 122°F, (-40°C to 50°C)

ENVIRONMENT AND WARRANTY

IP Rating

IP66

Environment

Dry, Damp or Wet locations
0-100% non-condensing humidity

Certifications

UL, cUL

Warranty

5 year limited warranty

SPECIFICATIONS

Date: _____

Type: _____

Project: _____

Firm: _____

OPTICS

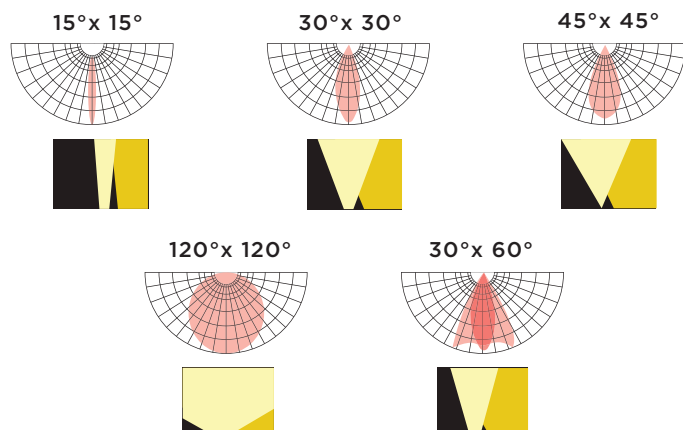

COLOR TEMPERATURES



RGBW

DIMENSIONS AND DATA

6w/ft	Voltage	View Angle	Watts/ Fixture	Lumens/ Fixture	LEDs/ fixture	Extrusion Length	Total Length
HB3016-12-RGBW-XXD-AC-DX	100-277VAC	15°, 30°	6w	226	4R,4G,4B,4W	L=301.8mm	L=306.8mm (12.1")
HB3016-24-RGBW-XXD-AC-DX		45°, 60°	11.4w	452	8R,8G,8B,8W	L=606.8mm	L=611.8mm (24.1")
HB3016-36-RGBW-XXD-AC-DX		75°, 90°	16.8w	678	12R,12G,12B,12W	L=911.4mm	L=916.4mm (36.1")
HB3016-48-RGBW-XXD-AC-DX		120°	22.4w	904	16R,16G,16B,16W	L=1216.2mm	L=1221.2mm (48.1")
		30°x60°					

PROFILE

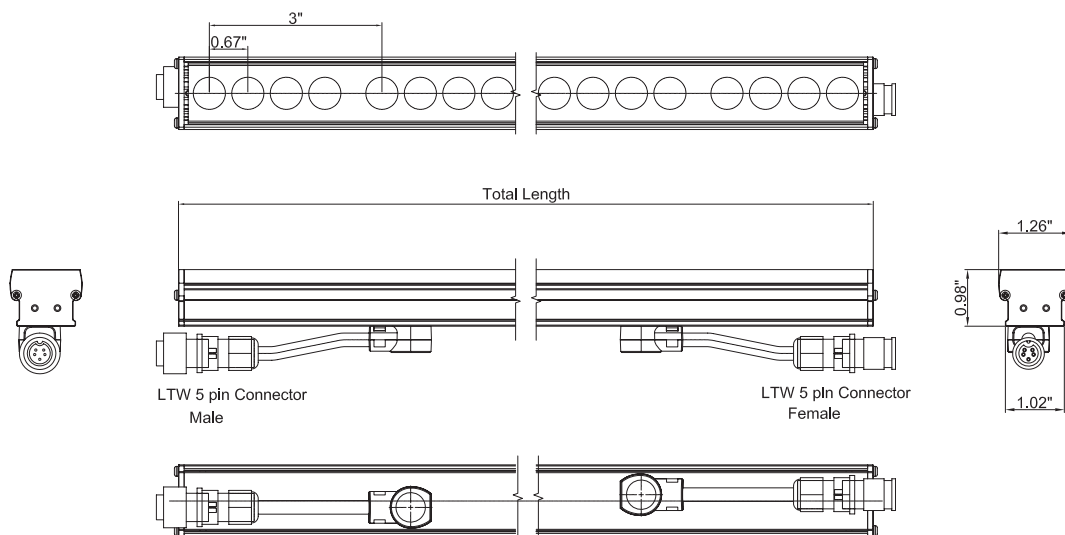

ORDER FORM

Date: _____
Type: _____
Project: _____
Firm: _____

CREATE YOUR FIXTURE

Ex: HB3016-48-RGBW65-30-AC-DM

MODEL	LENGTH	COLOR	OPTICS
HB3016	12"	RGBW	15
6w/ft	12 inches	27k	15°x15°
	24"	30k	30
	24 inches	35k	30°x30°
	36"	41k	45°
	36 inches	50k	45°x45°
	48"	65k	60°
	48 inches	6500k	60°x60°
		A	75°
		Amber	75°x75°
			90°
			90°x90°
			120
			120°x120°
			3060
			30°x60°

VOLTAGE	CONTROL
AC	DM
100-277vac	Addressable/12"
	DS
	Addressable/fixture

SELECT CONNECTION

Wire Lead

QTY	POWER/SIGNAL	
	AL-HB5P-72"-W/L	72" (6ft) Wire lead 5pin
	AL-HB5P-xx"-W/L	xx" (CU) Wire lead 5pin

* 1 wire lead required for each run.

End Cap

QTY		
	AL-HB5P-ENDCAP	End cap for fixture output at end of run

* 1 End cap required at the end of each

Jumper Cable

QTY	POWER/SIGNAL	
	AL-HB5P-12"-J	12" (1ft) jumper 5pin
	AL-HB5P-72"-J	72" (6ft) jumper 5pin
	AL-HB5P-xx"-J	xx" (CU) jumper 5pin

* Fixtures are end to end connected. Use jumpers if space is needed between fixtures.

ADDITIONAL OPTIONS

Optional Powder Coated Finish

QTY	Powder coated finishes available for additional cost
	BK Black
	BZ Bronze
	WH White
	CU Custom

* Fixture housing is anodized aluminum standard

DMX Controller

QTY		
	NIC-DMX-STICK-DE3	DMX Controller

Surge Protection

QTY		
	LSP4-UNV	120/277v surge protector

Junction Boxes

QTY		
	AC5A-DMX-3WB3	Power and signal wire splitter
	AC5A-DMX-3WB2	AC Power amplifier for long run lengths

* Used in place of wire leads to separate power and signal

SELECT MOUNTING

QTY	MOUNTING BRACKETS - 2 PER FIXTURE
	AL-HB30-ADJ BRACKET HB30 Adjustable bracket
	AL-HB30-FLAT BRACKET HB30 Flat bracket

* Select flat brackets if fixture is mounted in powder coated housing

ADDITIONAL MOUNTING OPTIONS

Housing and Extended Arms

Fixture can be mounted in a powder coated housing with integral glare shield

	Housing	(L) Housing Length	(F) Finish	(A) Extended Arm Length
QTY				
	HB30EXT-	12"	BK - Black	6"
		24"	BZ- Bronze	12"
		36"	WH - White	18"
		48"	SI - Silver	24"
			CU - Custom	36"
				GPA (Ground Post Arm)

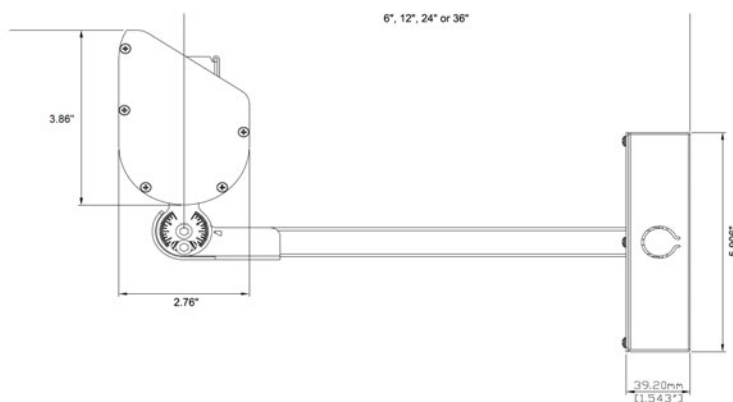

Ground Posts

QTY Select when using GPA above (1 per fixture for 12" & 24" housing and 2 for 36" & 48" housing)

HBEXT-GPS Ground post mount

1ft & 2ft extrusions require one HBEXT-GPS. 3ft & 4ft extrusions require two HBEXT-GPS.

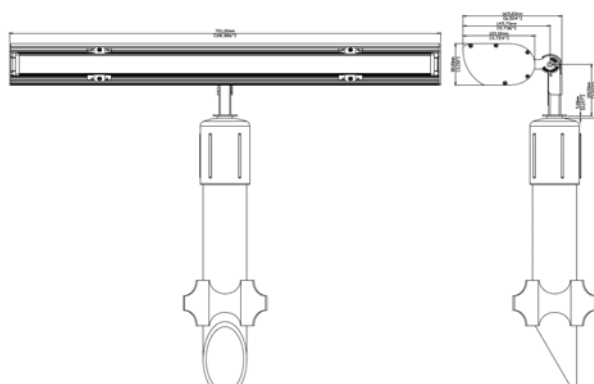

LOUVERS

Glare Control

Standard black finish powder coated louvers

QTY	Housing	(L) Housing Length	(F) Finish
	HB30-12" LOUVER	12"	BK - Black
	HB30-24" LOUVER	24"	BZ - Bronze
	HB30-36" LOUVER	36"	WH - White
	HB30-48" LOUVER	48"	SI - Silver
			CU - Custom

* Other powder coated finishes available for additional cost

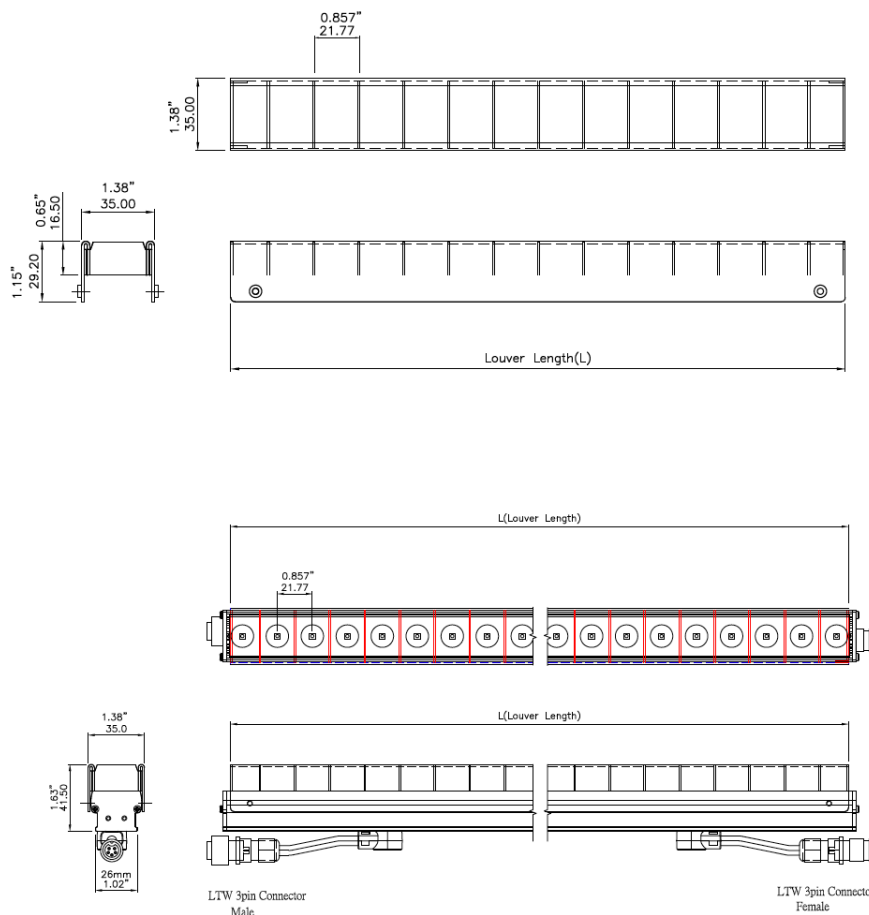

WIRE LEAD

DESCRIPTION

5 pin power / signal wire

PART NUMBER

AL-HB5P-xx"-W/L

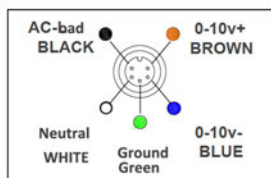
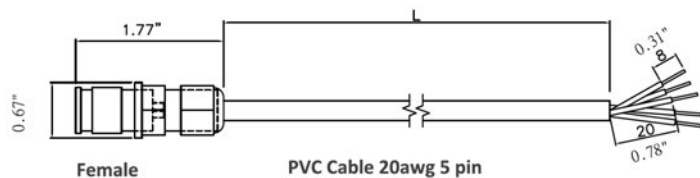

JUMPER CABLE

DESCRIPTION

5 pin power / signal jumper

PART NUMBER

AL-HB5P-xx"-W/L

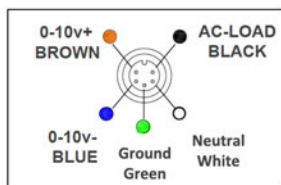
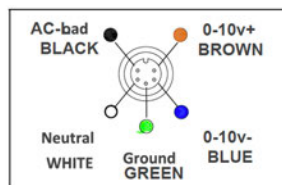
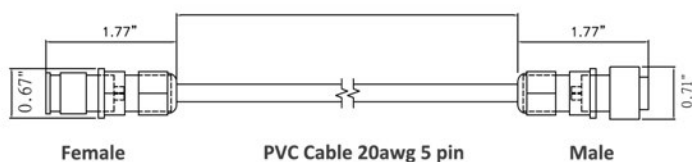

POWER/SIGNAL

DISTRIBUTION BOXES

Date: _____

Type: _____

Project: _____

Firm: _____

JUNCTION BOX - POWER AND SIGNAL SPLITTER

JUNCTION BOX

AC5A-DMX-3WB3

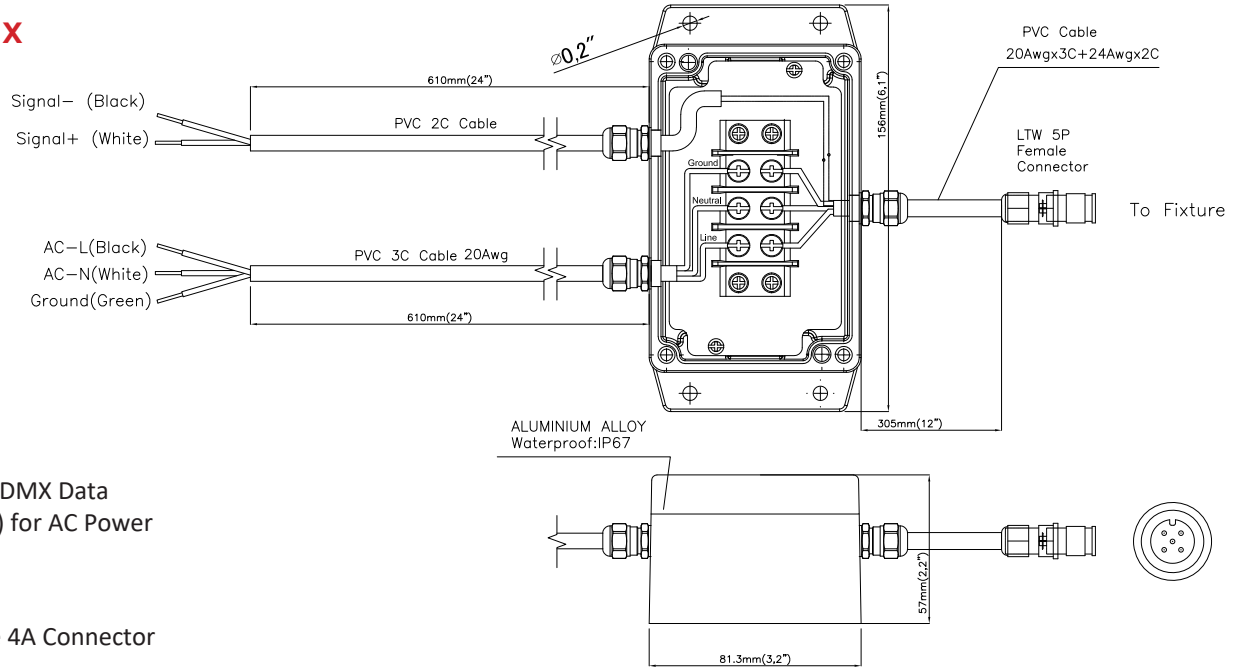

INPUT

24" Cable (2 leads) for DMX Data
24" PVC Cable (3 leads) for AC Power

OUTPUT

12" Cable w 5P Female 4A Connector

JUNCTION BOX-AC POWER AMPLIFIER FOR LONG RUN LENGTHS

JUNCTION BOX

AC5A-DMX-3WB2

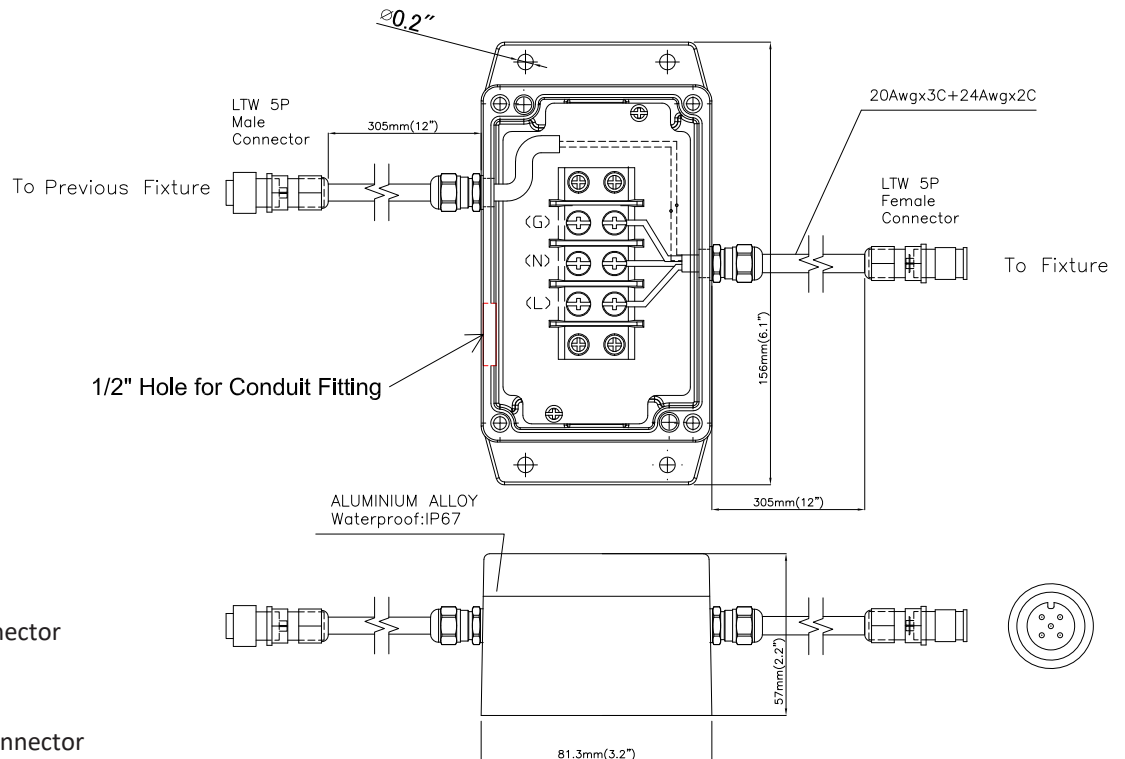

INPUT

12" PVC Cable w/ 5P Male 4A Connector

OUTPUT

12" PVC Cable w/ 5P Female 4A Connector

ADJUSTABLE BRACKETS

DESCRIPTION

HB30 Adjustable Bracket

PART NUMBER

AL-HB30 ADJ.Bracket

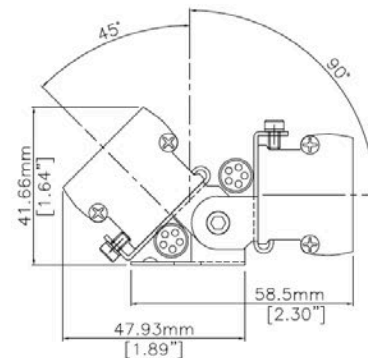
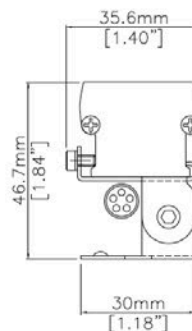
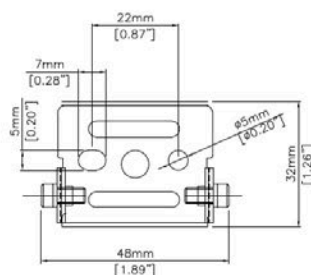
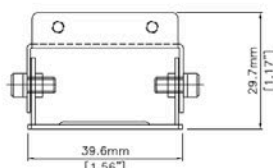
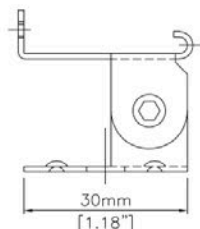

FLAT BRACKETS

DESCRIPTION

HB30 Flat Bracket

PART NUMBER

AL-HB30-Flat Bracket

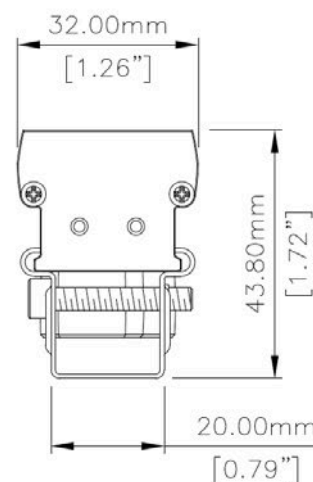
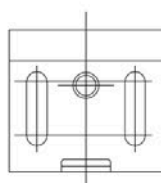
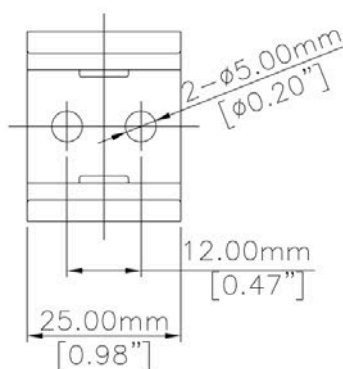
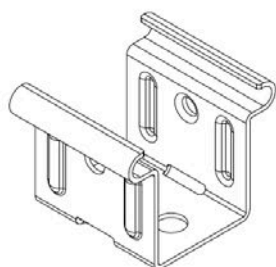

SURGE PROTECTION

DESCRIPTION

Surge Protection Device

PART NUMBER

AL-LSP-UNV

The use of a surge protection device is necessary to maintain your warranty. Specifications are subject to change without notice.

SPECIFICATIONS

Input Voltage	120-277V (+/- 5%)		
Frequency	50Hz-60Hz		
Maximum Continuous Voltage	320V		
Maximum Discharge Current	L-N 20kA; L-G, N-G 10kA (8/20Qs standard wave)		
Nominal Discharge Current	5kA		
Measured Limiting Voltage (VpK)	L-N	L-G	N-G
	1200	1320	1320
Max Case Temperature	85°C		

PULSE RATING (8 X 20 SEC)		
Surge Level	# of Strikes	
	L-N	L-G, N-G
10,000A	*2	1
6,500A	4	2
5,000A	30	15
2,000A	200	100
700A	20000	1000

*1 strike at 20,000A

MECHANICAL DIMENSIONS : IN (MM)

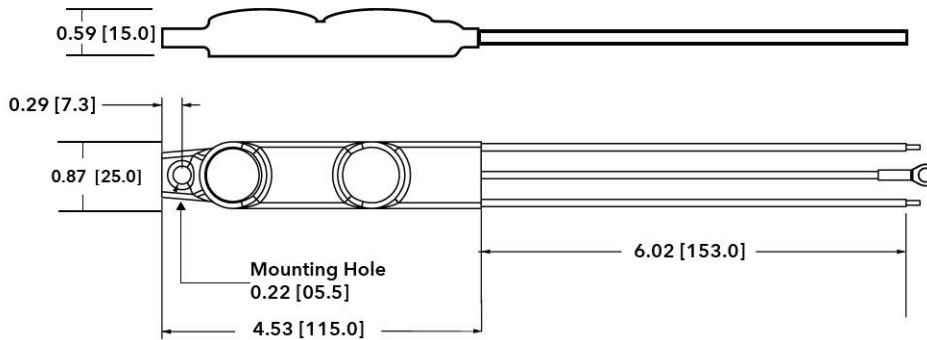

WIRING DIAGRAM

