



HB3024PD

EXTERIOR LINEAR LED LIGHTBAR

DIRECT VIEW | LOW PROFILE
4.4w/ft | 346lm/ft

Edge | Direct View | Accent Lighting

Engineered for the discerning needs of architectural applications, The Smart Lighting Company HB3024PD Series linear LED fixture marries high performance with sleek design. Its one-piece polycarbonate extruded housing is crafted for both durability and sophisticated edge and accent lighting. Fixtures can be quickly connected to form one long continuous line of light—perfect for emphasizing building lines. The fixture’s domed lens is meticulously designed to emit a smooth, consistent glow at an efficient 4.5 watts per foot, effectively banishing pixelation. With a universal 100/277VAC integral driver and 0-10v dimming, the HB3024PD adapts seamlessly to various installation conditions, offered in four lengths to suit your design. Using Nichia bin-sorted LEDs, it delivers the superior illumination that architects and lighting designers trust. Quality tested to ensure less than a 1% failure rate, this fixture is not only built to last but also backed by a solid 5-year warranty, reflecting our commitment to reliable, high-quality lighting solutions at an accessible price point.

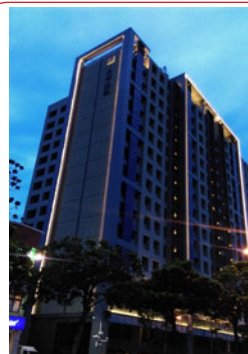
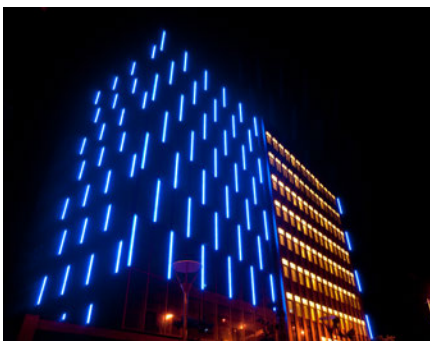

SPECIFICATIONS

PERFORMANCE

Output

4.4w/ft | 346lm/ft

Color Temperatures

22k, 27k, 30k, 35k, 41k, 50k, 65k, R, G, B, A

Beam Angles

120°

LEDs per Foot

24

LED's

Nichia bin-sorted

Color Consistency

2 SCDM

ELECTRICAL

Input Voltage

100-277vac

Power Supply

Integral

Control

0-10v dimming

Heat dissipation

Full thermal management system

Connection

Quick connect plug and play system

Projected Lumen Maintenance

>90,000 hours

PHYSICAL

Fixture Length Options

12", 24", 36", 48"

Max Run Length

197ft@277vac, 108ft@120vac

Housing

One piece polycarbonate

Lens

Polycarbonate diffused

Standard Mounting

Stainless adjustable or flat brackets

Optional Mounting

Stainless joint connectors

Operating Temperature

-40°F to 122°F, (-40°C to 50°C)

ENVIRONMENT AND WARRANTY

IP Rating

IP66

Environment

Dry, Damp or Wet locations
0-100% non-condensing humidity

Certifications

UL, cUL

Warranty

5 year limited warranty

SPECIFICATIONS

OPTICS

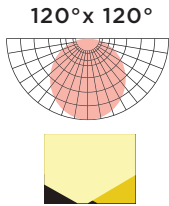

COLOR TEMPERATURES

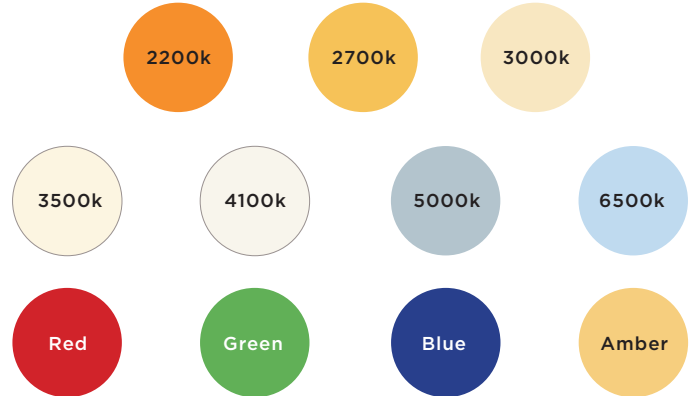

DIMENSIONS AND DATA

4.4w/ft	Voltage	View Angle	Watts/ Fixture	Lumens/ Fixture	LEDs/ Fixture	Extrusion Length	Total Length
HB3024PD-12-XXK-120D-ACD	100-277VAC	120°	4.4w	346	24	L=294.8mm	L=304.8mm (12")
HB3024PD-24-XXK-120D-ACD			8.8w	692	48	L=599.6mm	L=609.6mm (24")
HB3024PD-36-XXK-120D-ACD			13.2w	1038	72	L=904.4mm	L=914.4mm (36")
HB3024PD-48-XXK-120D-ACD			17.8w	1384	96	L=1209.2mm	L=1219.2mm (48")

PROFILE

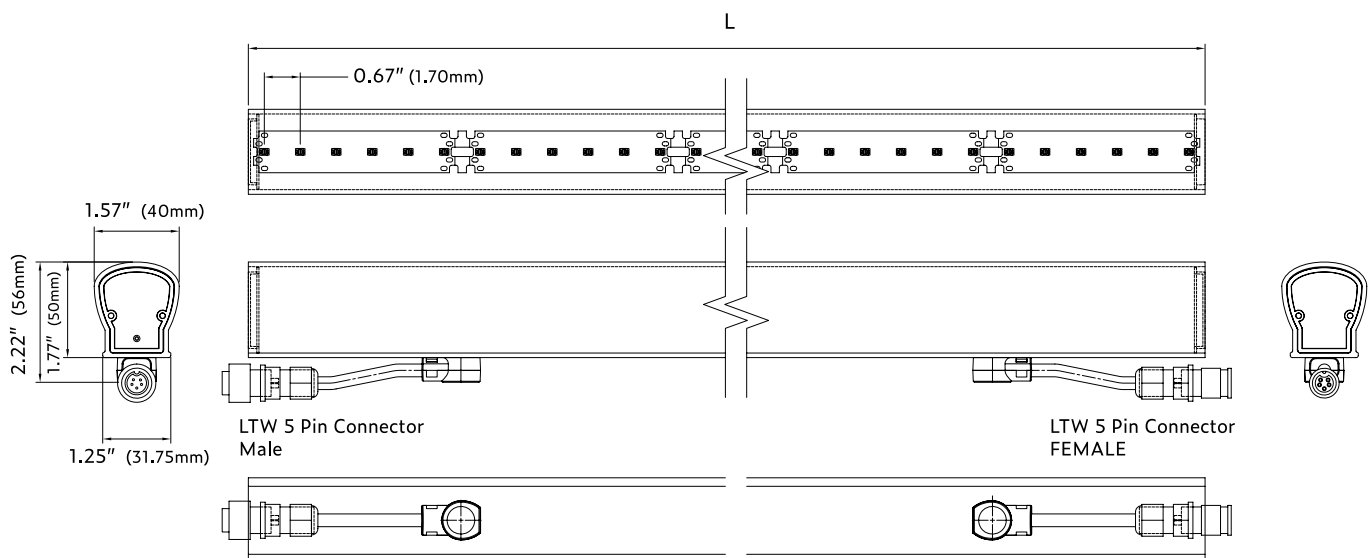

ORDER FORM

Date: _____
Type: _____
Project: _____
Firm: _____

Ex. HB3024PD-48-30K-120-ACD

CREATE YOUR FIXTURE

MODEL	LENGTH	COLOR	OPTICS
HB3024PD	12" 12 inches 24" 24 inches 36" 36 inches 48" 48 inches	22k 2200k 65k 6500k 27k 2700k R Red 30k 3000k G Green 35k 3500k B Blue 41k 4100k A Amber 50k 5000k	120 120°x120°
VOLTAGE	CONTROL		
AC 100-277vac	D 0-10v Dimming ND Non Dimming		

SELECT CONNECTION

Wire Lead

QTY	DIMMING	
	AL-HB5P-72"-W/L	72" (6ft) Wire lead 5pin
	AL-HB5P-xx"-W/L	xx" (CU) Wire lead 5pin
QTY	NON DIMMING	
	AL-HB3P-72"-W/L	72" (6ft) Wire lead 3pin
	AL-HB3P-xx"-W/L	xx" (CU) Wire lead 3pin

* 1 wire lead required for each run.

End Cap

QTY		
	AL-HB3P-ENDCAP	End cap for fixture output at end of run

* 1 End cap required at the end of each

Jumper Cable

QTY	DIMMING	
	AL-HB5P-12"-J	12" (1ft) jumper 5pin
	AL-HB5P-72"-J	72" (6ft) jumper 5pin
	AL-HB5P-xx"-J	xx" (CU) jumper 5pin
QTY	NON DIMMING	
	AL-HB3P-12"-J	12" (1ft) jumper 3pin
	AL-HB3P-72"-J	72" (6ft) jumper 3pin
	AL-HB3P-xx"-J	xx" (CU) jumper 3pin

* Fixtures are end to end connected. Use jumpers if space is needed between fixtures.

SELECT MOUNTING

QTY	MOUNTING BRACKETS - 2 PER FIXTURE	
	AL-ID/PD30-ADJ BRACKET	Adjustable bracket
	AL-ID/PD30-FLAT	Flat bracket
	BRACKET AL-PD-JNT*	Joint connection bracket

* Used to join two fixtures together

ADDITIONAL OPTIONS

0-10V Dimmer

QTY		
	LUT-DVSTV-WH	0-10v AC Wall switch

Surge Protection

QTY		
	LSP4-UNV	120/277v surge protector

WIRING OPTIONS

WIRE LEAD

DESCRIPTION

5 pin power / signal wire

PART NUMBER

AL-HB5P-xx"-W/L

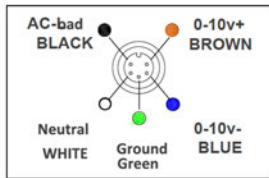
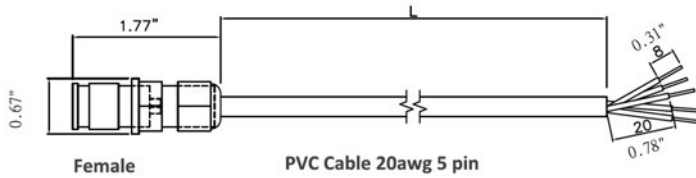

DESCRIPTION

3 pin power wire

PART NUMBER

AL-HB3P-xx"-W/L

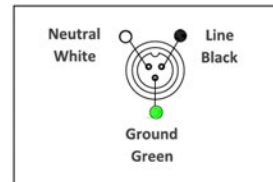
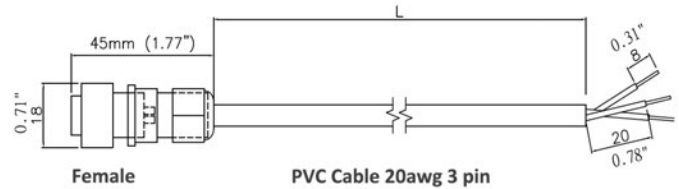

JUMPER CABLE

DESCRIPTION

5 pin power / signal jumper

PART NUMBER

AL-HB5P-xx"-J

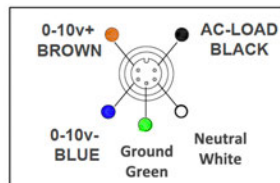
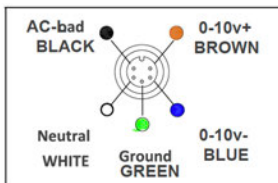
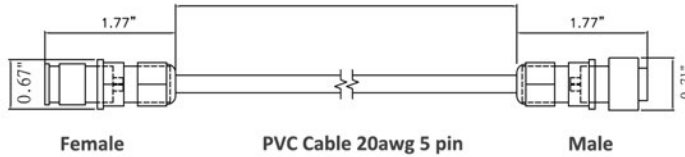

DESCRIPTION

3 pin power jumper

PART NUMBER

AL-HB3P-xx"-J

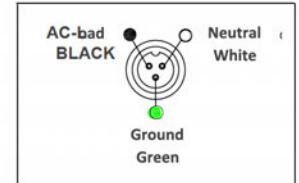
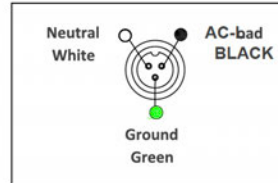
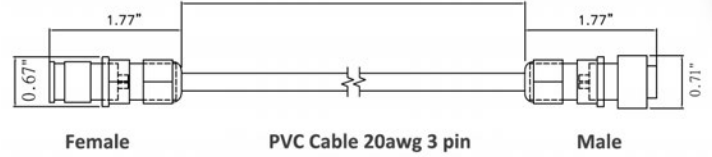

MOUNTING BRACKETS

ADJUSTABLE BRACKETS

DESCRIPTION

HB30PD Adjustable Bracket

PART NUMBER

AL-ID/PD30 ADJ.Bracket

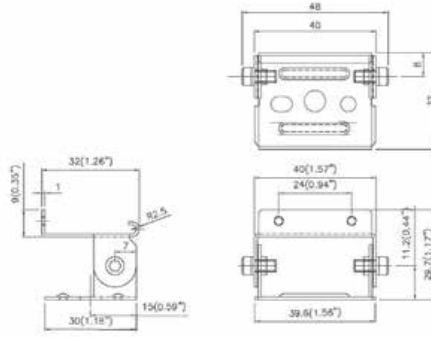
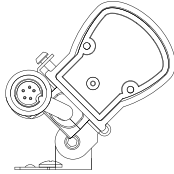
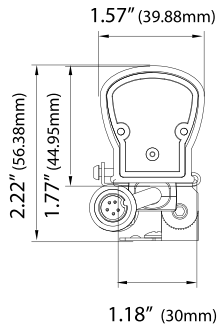

FLAT BRACKETS

DESCRIPTION

HB30PD Flat Bracket

PART NUMBER

AL-ID/PD30-FBF BKT

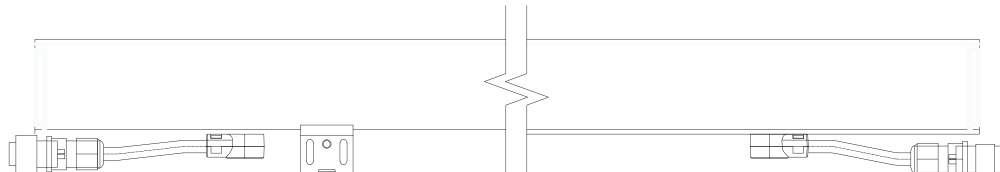
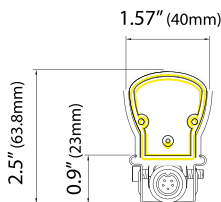
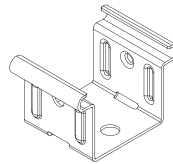
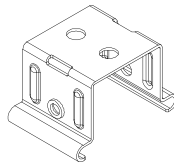
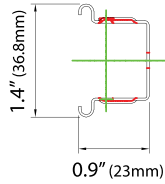
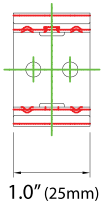

JOINT CLIP

DESCRIPTION

HB30PD Joint Connector

PART NUMBER

AL-ID/PD30-JNT BKT



SURGE PROTECTION DEVICE

SURGE PROTECTION

DESCRIPTION

Surge Protection Device

PART NUMBER

AL-LSP-UNV

The use of a surge protection device is necessary to maintain your warranty. Specifications are subject to change without notice.

SPECIFICATIONS

Input Voltage	120-277V (+/- 5%)		
Frequency	50Hz-60Hz		
Maximum Continuous Voltage	320V		
Maximum Discharge Current	L-N 20kA; L-G, N-G 10kA (8/20Qs standard wave)		
Nominal Discharge Current	5kA		
Measured Limiting Voltage (VpK)	L-N	L-G	N-G
	1200	1320	1320
Max Case Temperature	85°C		

PULSE RATING (8 X 20 SEC)		
Surge Level	# of Strikes	
	L-N	L-G, N-G
10,000A	*2	1
6,500A	4	2
5,000A	30	15
2,000A	200	100
700A	20000	1000

*1 strike at 20,000A

MECHANICAL DIMENSIONS : IN (MM)

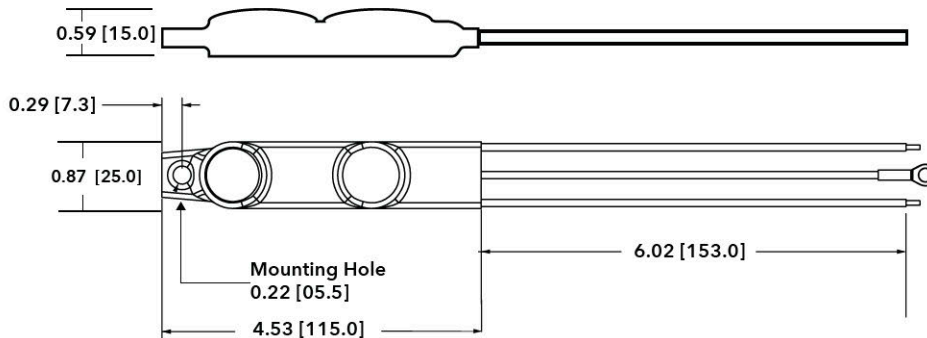

WIRING DIAGRAM

