

# HB50 Mounting

## Extrusions, Extended Arms, Louvers

For use with our HB50 series fixtures for applications between 20 and 80 feet.



### APPLICATION

Designed to illuminate signage, facades, monuments and more.

The Extrusion package allows you to easily mount your HB50 fixture in an architectural powder-coated extrusion with your choice of mounting arms or ground post stakes. Standard finishes available. Fixtures are able to be mounted as a stand-alone fixture or in a seamless row. Wires connect from the fixture through the extended arm into the junction box. The wall mounted box has knock outs on all four sides as well as through the back. Row mounted fixtures are wired end to end. The housing angle is adjustable on the extended arms. Louvers are available as an option to reduce glare.

### FEATURES

- Extruded aluminum housing with stainless steel hardware
- Black or Bronze Powder-coat finish standard - RAL custom colors available
- Extended arms 6", 12", 18", 24" or 36"
- Ground post mounting
- No visible wires or mounting hardware
- Integrated Glare Shield and optional Louvers
- Stand-alone or Row mounted
- Adjustable housing with calibrated system for precise angle up to 25°+/-
- Mounted direct or indirect, horizontally or vertically

### WARRANTY

Our fixtures are backed by a 5-year limited warranty.

### PHYSICAL

<b>Housing</b>	Extruded Anodized Aluminum
<b>Fixture Lengths</b>	12", 24", 36", 48"
<b>Housing Colors</b>	Bronze, Black, White, Silver, custom
<b>Connection</b>	Quick connect plug and play
<b>Mounting</b>	Extended arms or ground post
<b>Environment</b>	IP66 Wet, Damp or Dry Locations
<b>Glare Protection</b>	Integrated glare shield - optional louvers

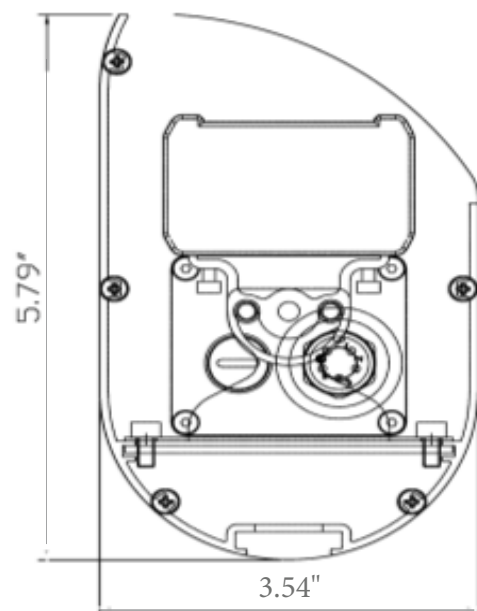

# HB50 Mounting

FIXTURE SOLD SEPARATELY

DATE
FIRM
PROJECT
CONTACT

## PART NUMBER

MODEL	LENGTH	FINISH	MOUNTING	OPTIONS
HB50EXT	12 1 foot 24 2 foot 36 3 foot 48 4 foot	BZ Bronze BK Black WH White SI Silver CU Custom RAL _____	6" 6" Arm 12" 12" Arm 18" 18" Arm 24" 24" Arm 36" 36" Arm GPS Ground Post	L Louvers N None

Standard fixture housing is anodized aluminum. Powder coating is available from factory in Black, Bronze, White, or custom. There is a minimum quantity for powder coating or a surcharge will be added.

## ACCESSORIES

### MOUNTING HARDWARE

AL-HB50 ADJ.BRACKET	HB30 Adjustable Bracket
HBEXT-GPS	Ground post stake

1ft & 2ft extrusions require one ground post stake (HBEXP-GPS). 3ft & 4ft extrusions require two ground post stakes (HBEXP-GPS).

### GLARE PROTECTION

HB50-12" LOUVER	12" Louver
HB50-24" LOUVER	24" Louver
HB50-36" LOUVER	36" Louver
HB50-48" LOUVER	48" Louver

Standard louvers are in Black. Special order for Bronze, White, Silver or custom.

# HB50 Extended Arm Mounting

FIXTURE SOLD SEPARATELY

## 12" AND 24" EXTRUSIONS WITH SINGLE MOUNTING ARMS

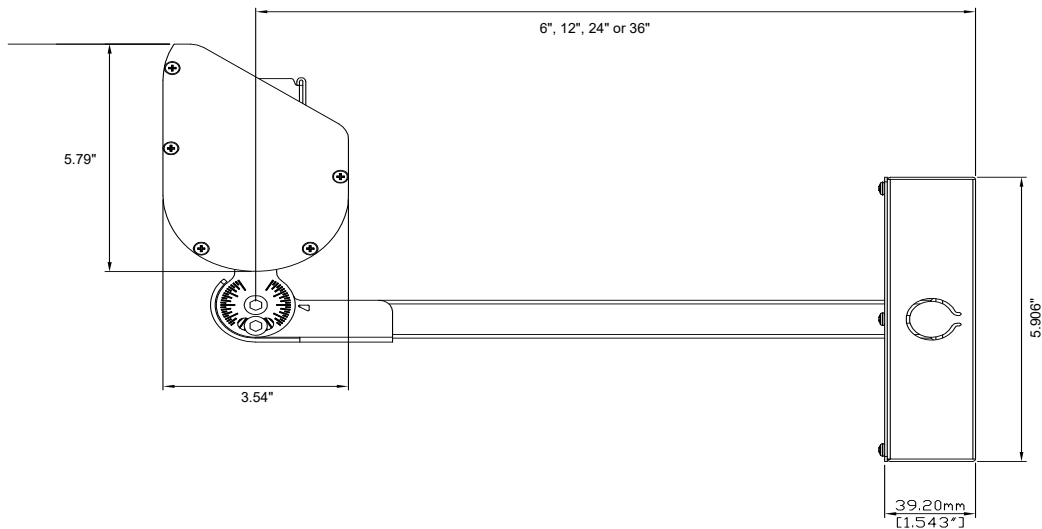
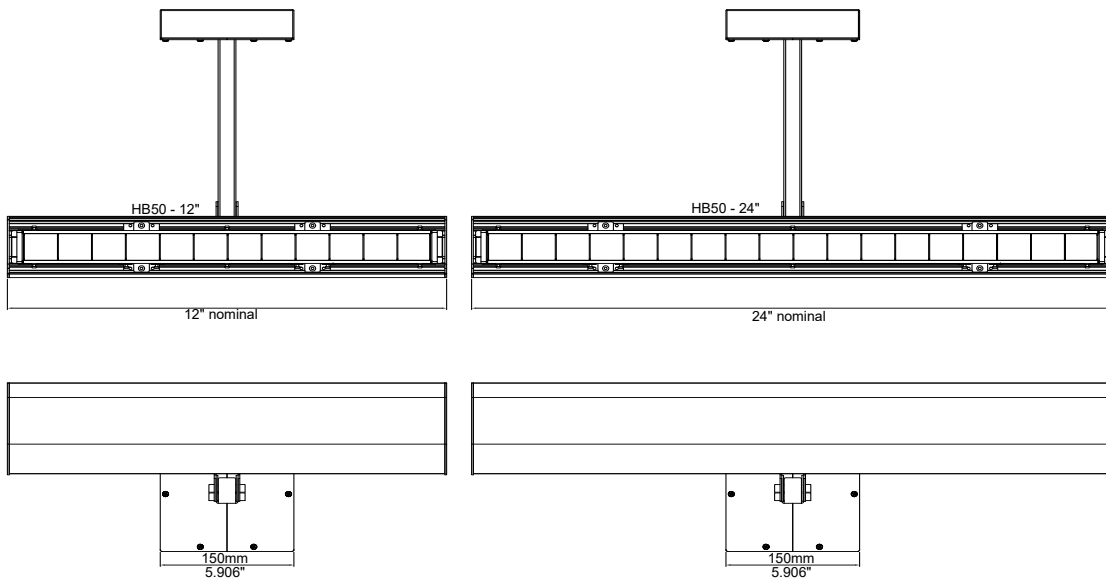
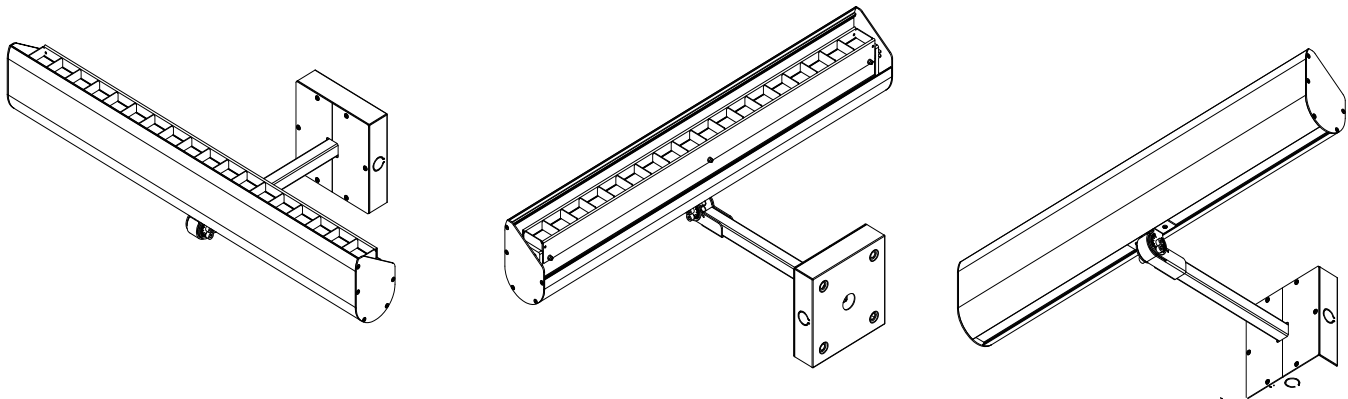

# HB50 Extended Arm Mounting

FIXTURE SOLD SEPARATELY

## 36" AND 48" EXTRUSIONS WITH DOUBLE MOUNTING ARMS

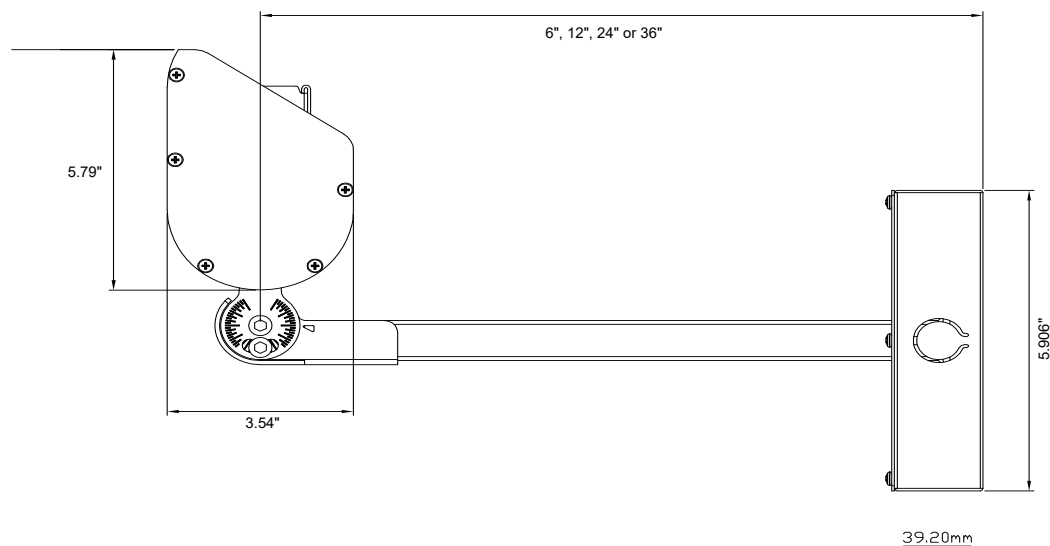
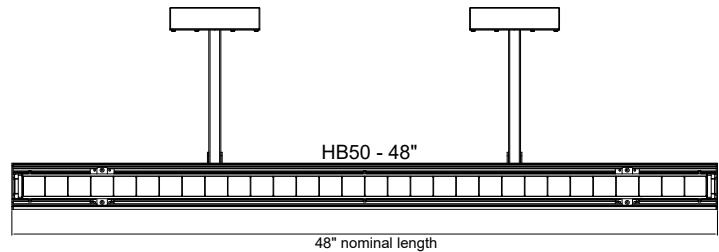
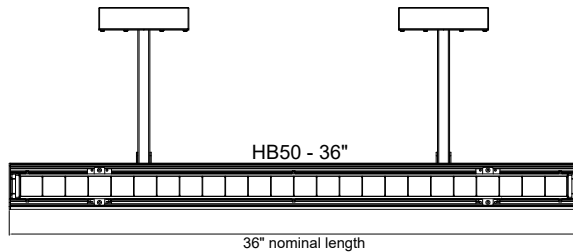
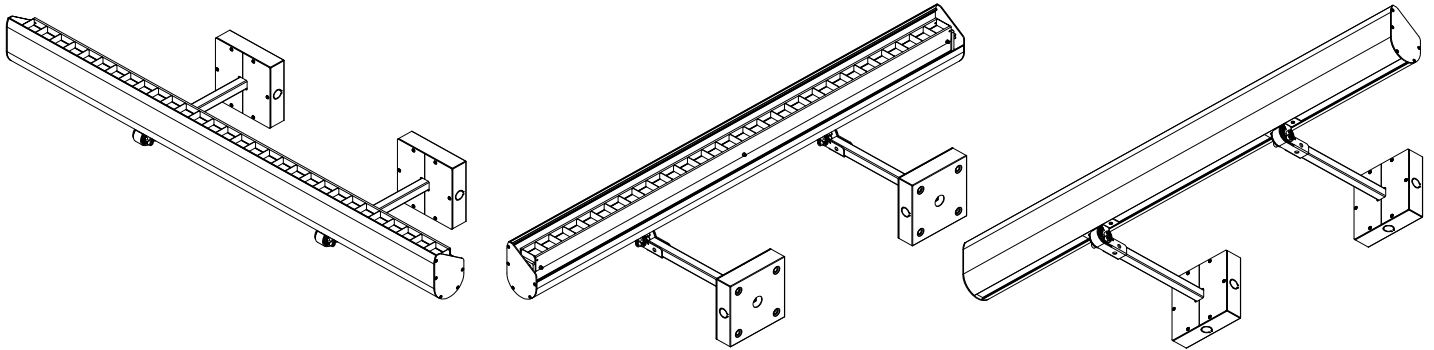

# HB50 Ground Post Mounting

FIXTURE SOLD SEPARATELY

Ground post stake  
Part #: HBEXT-GPS

## 12" AND 24" EXTRUSIONS WITH ONE THREADED ARM

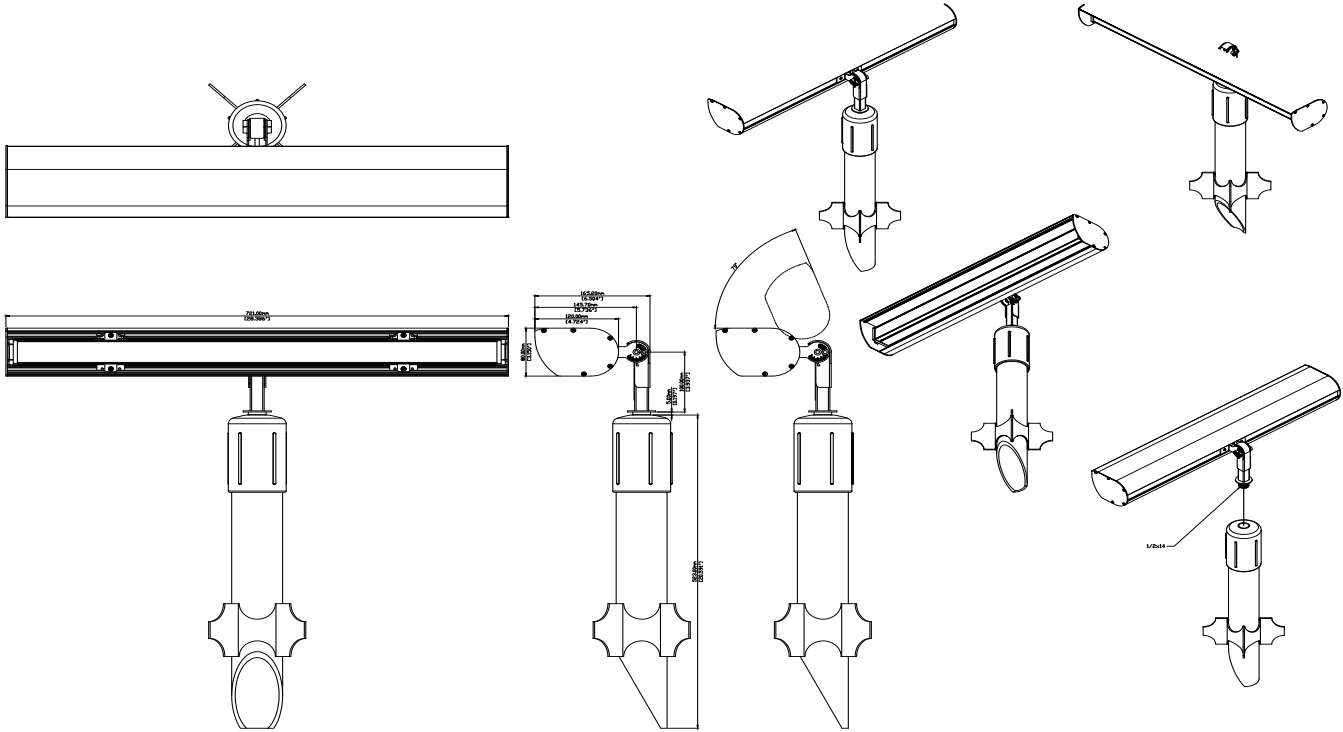

## 36" AND 48" EXTRUSIONS WITH TWO THREADED ARMS

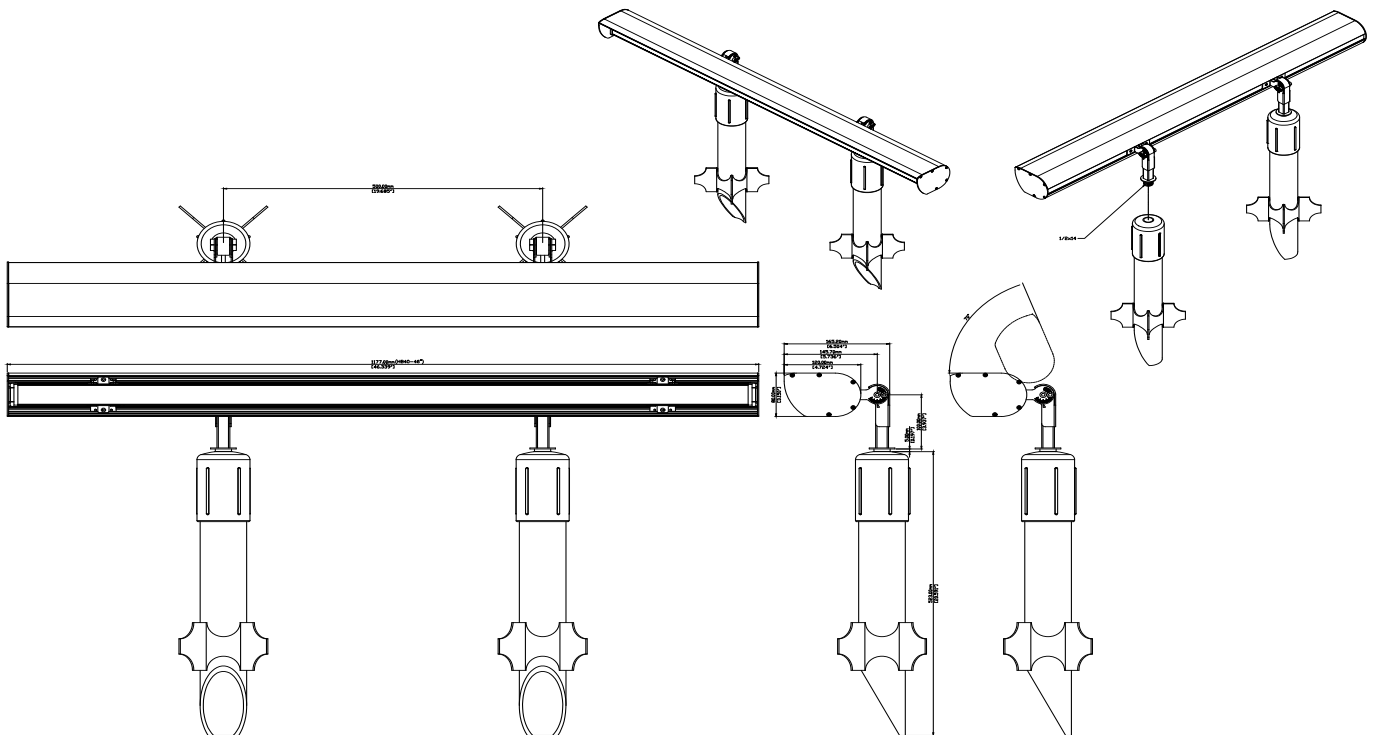

# HB50 Louvers

FIXTURES SOLD SEPARATELY

## LOUVERS

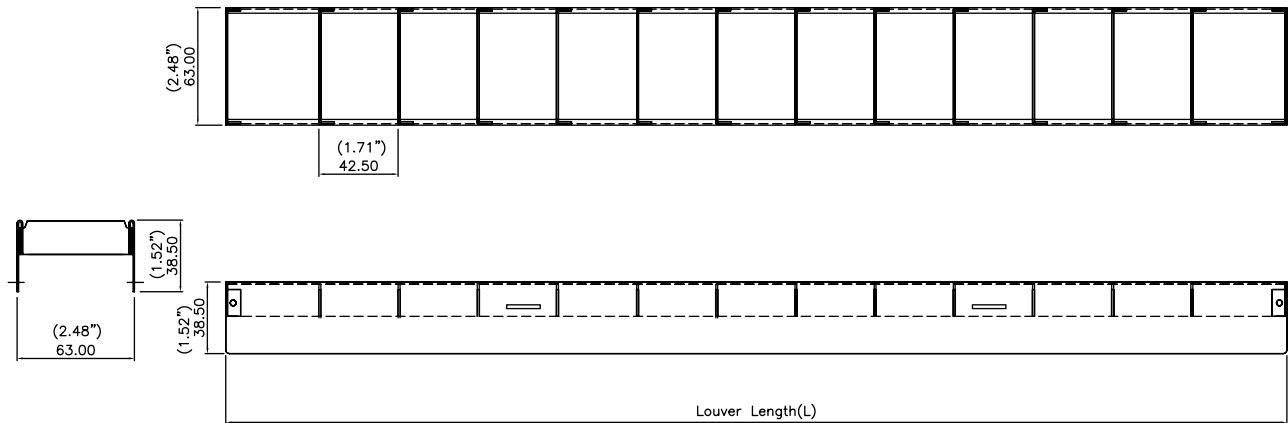

Model No.	Standard Inch	LEDs/Unit	LEDs/Pitch		Louver Length		Total Length	
HB50-12-louver	12	6	42.5 mm	1.71 inch	309 mm	12.2 inch	321 mm	12.6 inch
HB50-24-louver	24	12	42.5 mm	1.71 inch	607 mm	23.9 inch	619 mm	24.4 inch
HB50-36-louver	36	18	42.5 mm	1.71 inch	905 mm	35.6 inch	917 mm	36.1 inch
HB50-48-louver	48	24	42.5 mm	1.71 inch	1208 mm	47.6 inch	1220 mm	48 inch

