

Flexible Wall Washer Series

DMX White High-Efficacy



Features

Our FDBW is an economical, high performance DMX White Top-Bend Flexible Wall Washer in a compact form that offers multiple beam angles for maximum customization.

High transmittance polycarbonate lens with grazing angles in 20°, 30°, 40°, 60°, 25°x35° and 15°x60°.

Slim size and high-efficacy up to 117lm/W using high-power 3030 LED. The FDBW is Pixel controllable by DMX signal with smart IC TM512ACE designed on board.

Uniform brightness and color up to 5M [16.4ft.] run length. On-field cutting and assembly for desired length. IP67 for indoor and outdoor usage.

Complete installation accessory options including adhesive tape, clip, aluminum channel, bracket, and rotating bracket. Environmentally friendly, high-grade appearance, soft bend flexibility, and high weather resistance, using silicone material. 50,000 hours lifespan, and 3 years warranty.

Application

Ideal for indirect lighting applications for grazing, wall washing and architectural facades, making contours and patterns more stereoscopic and vivid. Perfect for hospitality, landscape, and architectural features.



General Parameters

Part No.	Style	Dimension	Max. Length	Increment	LED Type	LED QTY	IP Rating	Operating Ambient	Lifespan	Warranty
FDBW	Top-Bend DMX White High-Efficacy	W23xH13.5mm [W0.9xH0.53in.]	5M [16.4ft.]	166.7mm [6.56in.] (6 pixel/M 3 addresses/pixel IC: TM512ACE)	SMD 3030 (3 step 1 bin)	42LED/M [12LED/ft.]	IP67 [Wet Location]	Ta: -20~45°C [-4~113°F]	50,000h (L70@ Tc≤65°C [149°F], Tc is the temp. of LED pin)	3 years

Photoelectric Parameters

Part No.	Style	Power ±10%	Operating Voltage	Finished Product CCT/ Wavelength	CRI80, 4000K		CRI90, 4000K		Beam Angle
					Luminous Flux±10%	Light Efficiency	Luminous Flux±10%	Light Efficiency	
FDBW	Top-Bend DMX White High-Efficacy	18W/M [5.49W/ft.]	DC24V	2700K/3000K/ 4000K/6500K	2070lm/M [631lm/ft.]	115lm/W	1760lm/M [537lm/ft.]	98lm/W	20°
					2050lm/M [625lm/ft.]	114lm/W	1750lm/M [534lm/ft.]	97lm/W	30°
					2070lm/M [631lm/ft.]	115lm/W	1760lm/M [537lm/ft.]	98lm/W	40°
					2000lm/M [610lm/ft.]	111lm/W	1690lm/M [515lm/ft.]	94lm/W	60°
					2030lm/M [619lm/ft.]	113lm/W	1730lm/M [527lm/ft.]	96lm/W	25°*35°
					1930lm/M [588lm/ft.]	107lm/W	1640lm/M [500lm/ft.]	91lm/W	15°*60°

Note:

- Luminous flux for CCT 2700K/3000K is 10% lower, for CCT 6500K is 5% higher, compared with 4000K.
- Energy efficiency class of regulation (EU)2019/2020 is E(CRI80) and F(CRI90) for 4000K, it varies depending on CRI and CCT.
- Milky silicon rubber tube and transparent silicon potting glue, are standard configuration, extra heat sink is not necessary with self-cooling capacity.
- 3M 604A red adhesive tape attached on backside, is standard configuration; 200mm[0.6in] length of double insulated white silicone cable at both ends, with UL3132 5pins core wire (black: +, white: -, red: A, blue: B, green: PI), is standard configuration. (The black and white wires are AWG20, others are AWG22)
- Power maintenance rate=actual measured power in a certain length/(a same certain length*actual measured power in 1M[3.28ft.] length); Brightness maintenance rate=actual measured brightness on the tail section in a certain length/actual measured brightness on the first section in a same certain length. (Generally, there are few cases of full power operation for mixed-color like RGB/RGBW/RGBCCCT/RGBWCCT.)

LED Flexible Strip

Diagram & Dimension

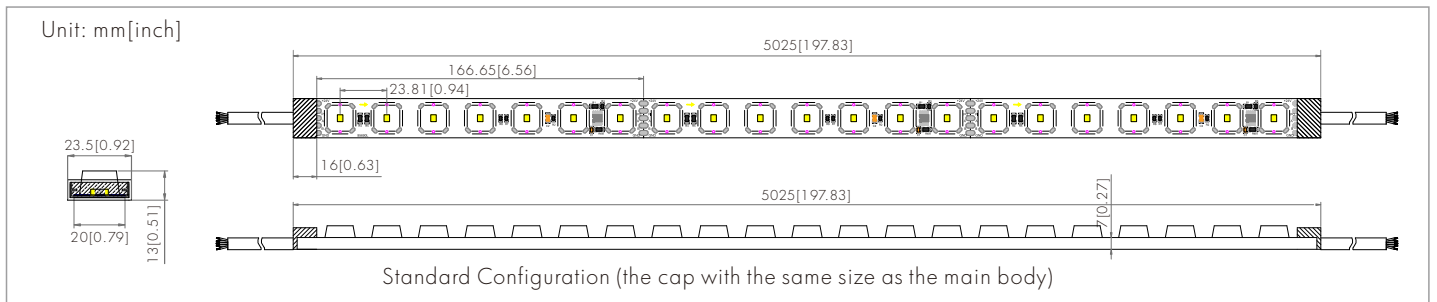
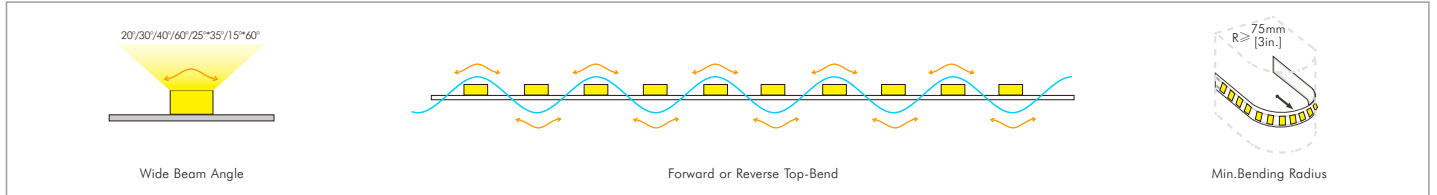

LED Flexible Strip

Light Distribution Diagram

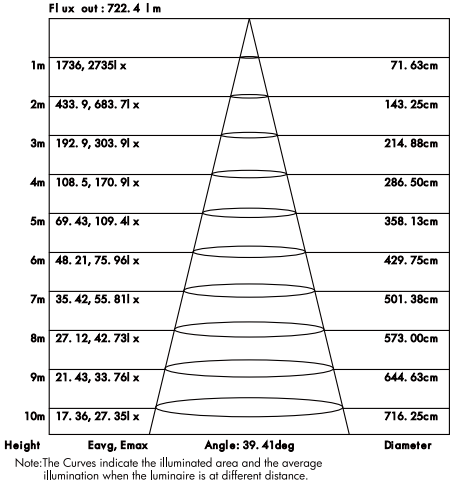
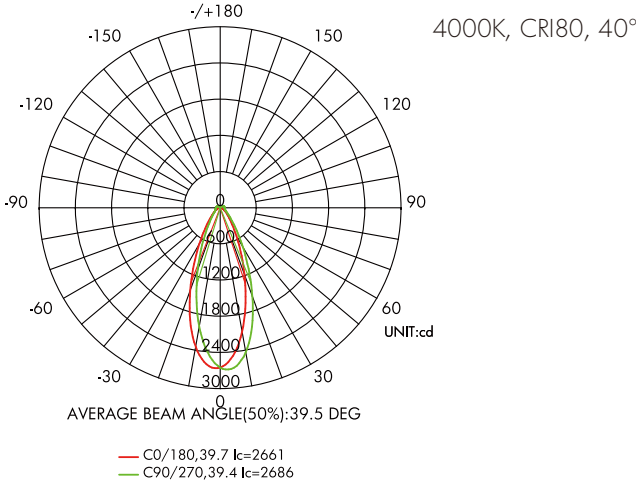
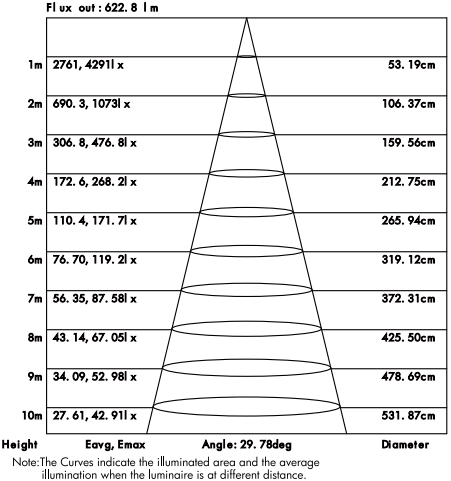
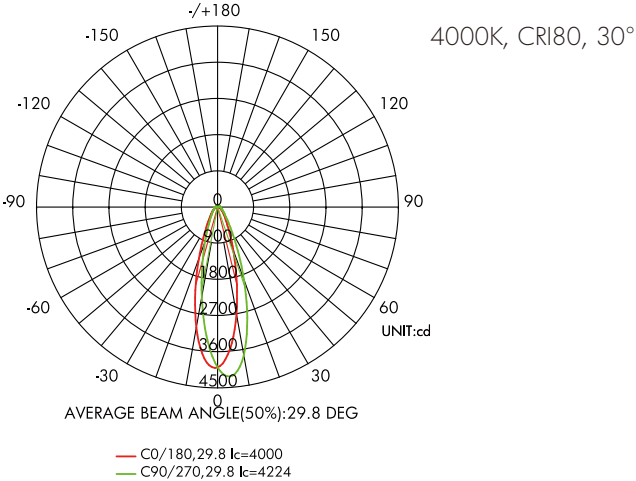
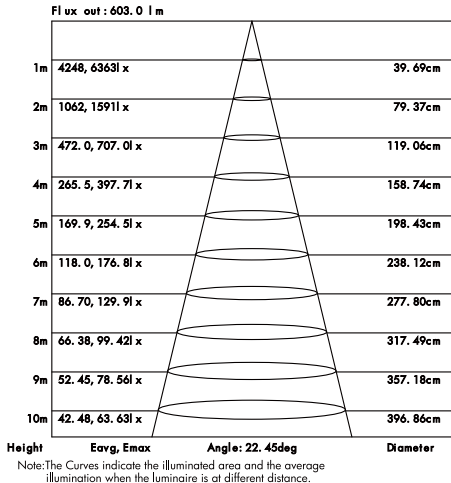
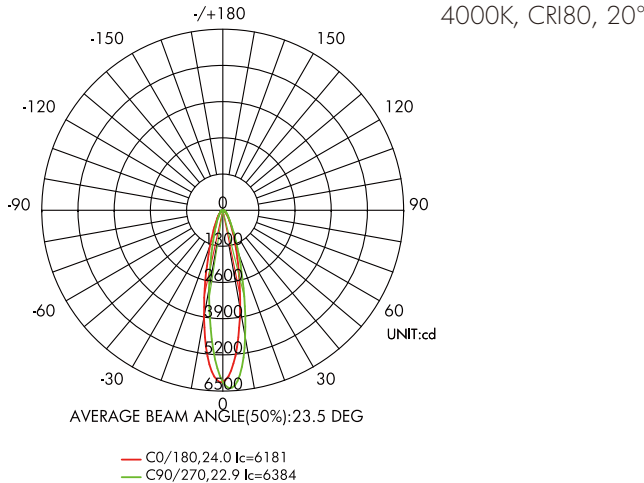

LED Flexible Strip

Light Distribution Diagram

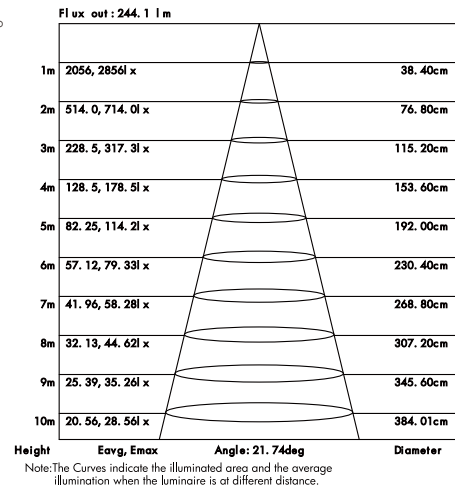
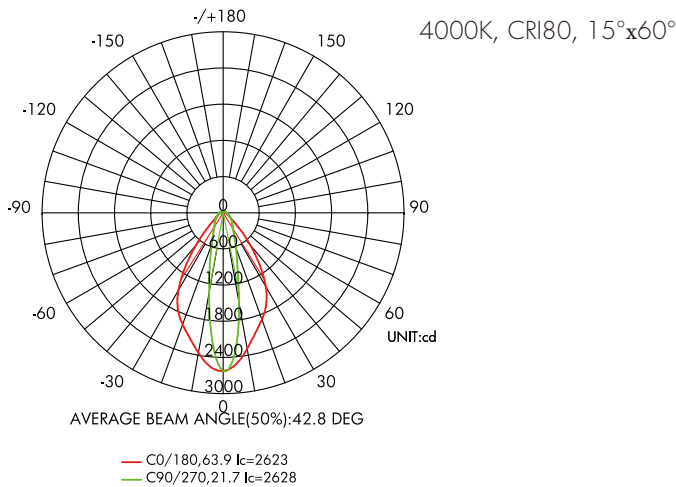
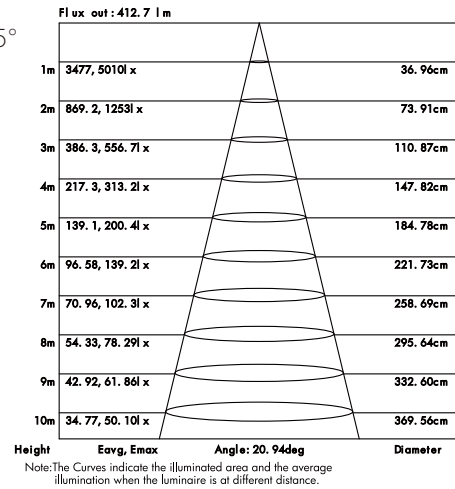
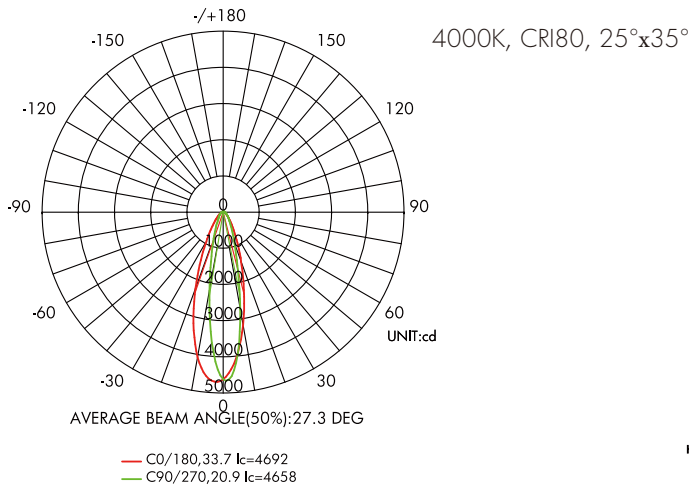
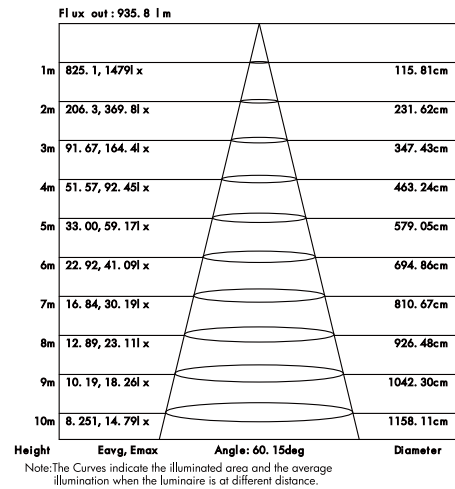
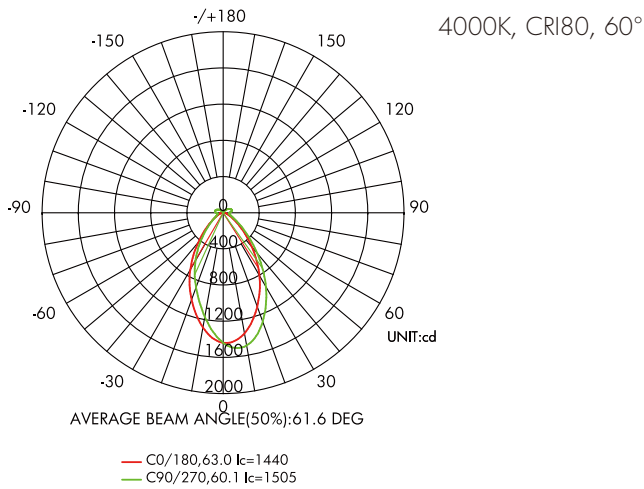

Application Scene Illustration

Wall washing & wall grazing performance to the wall (Horizontal mounting on the floor)



20° Side View
(White 18W)



20° Front View
Distance to the wall is 50mm[1.97in.]



20° Front View
Distance to the wall is 100mm[3.94in.]



20° Front View
Distance to the wall is 200mm[7.87in.]



20° Front View
Distance to the wall is 300mm[11.8in.]



60° Side View
(White 18W)



60° Front View
Distance to the wall is 50mm[1.97in.]



60° Front View
Distance to the wall is 100mm[3.94in.]



60° Front View
Distance to the wall is 200mm[7.87in.]



60° Front View
Distance to the wall is 300mm[11.8in.]



25°*35° Side View
(White 18W)



25°*35° Front View
Distance to the wall is 50mm[1.97in.]



25°*35° Front View
Distance to the wall is 100mm[3.94in.]



25°*35° Front View
Distance to the wall is 200mm[7.87in.]

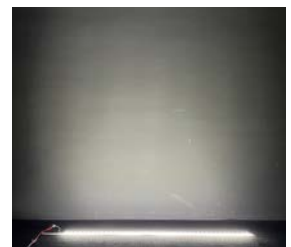

25°*35° Front View
Distance to the wall is 300mm[11.8in.]



15°*60° Side View
(White 18W)



15°*60° Front View
Distance to the wall is 50mm[1.97in.]



15°*60° Front View
Distance to the wall is 100mm[3.94in.]



15°*60° Front View
Distance to the wall is 200mm[7.87in.]

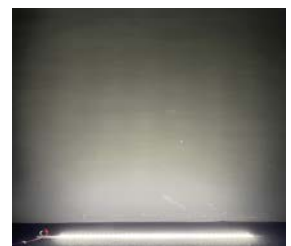

15°*60° Front View
Distance to the wall is 300mm[11.8in.]

Assembly Accessory

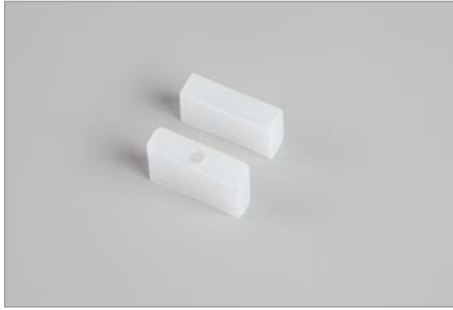

Front Cap & End Cap



Aluminum Channel & PC Transparent Cover
(silver or black color)



End Cap & Front Cap for Aluminum Channel
(silver or black color)



Glue

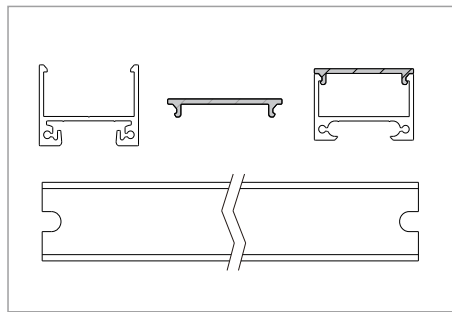

Aluminum Channel & PC Transparent Cover
(silver or black color)

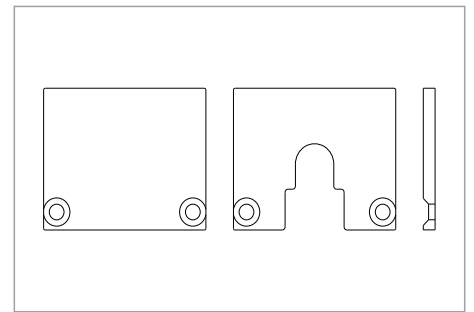

End Cap & Front Cap for Aluminum Channel
(silver or black color)

Installation Accessory



Adhesive Tape

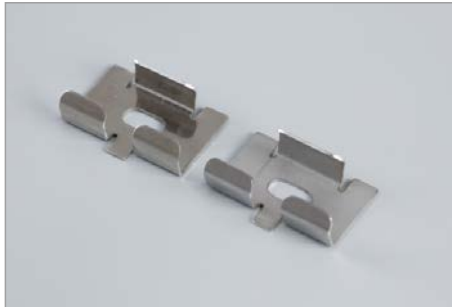

Bracket



120° Rotatable Bracket
(with fastening screw and angle scale)

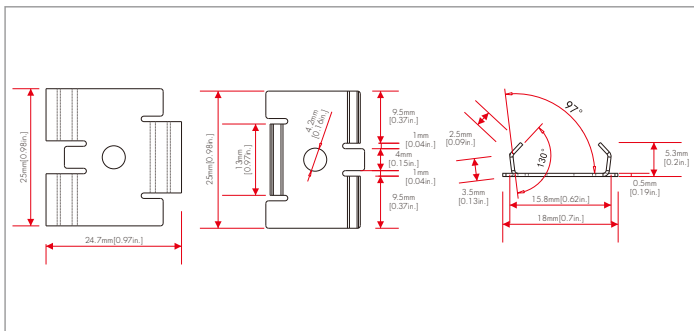

Bracket

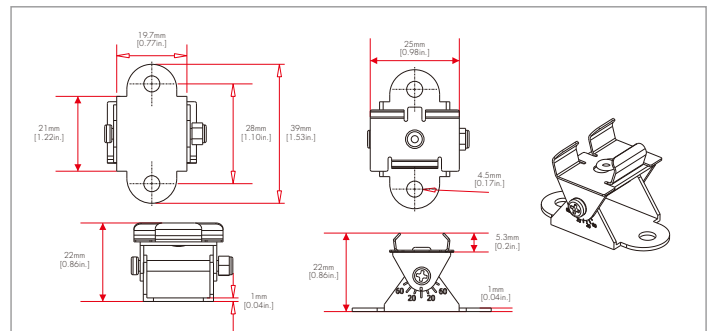

120° Rotatable Bracket (with fastening screw and angle scale)

Assembly

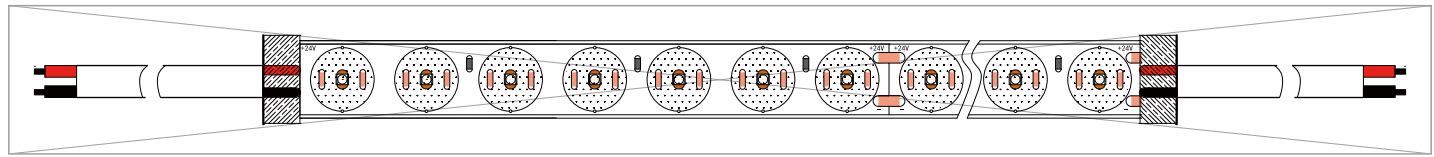

Self-Processed Version (the cap with bigger size than the main body)

<p>Front Cap End Cap</p>	<p>Following the mark line for cutting by scissors.</p>	<p>Peel off the silicone jacket on the top side by 3mm [0.12in.] length and exposure the solder pad.</p>
<p>Solder the cable to the solder pads on top side of the strip.</p>	<p>Fill the front cap with silicone glue and seal to the LED strip.</p>	<p>Fill the end cap with silicone glue and seal to the LED strip.</p>



(1) adhesive Tape

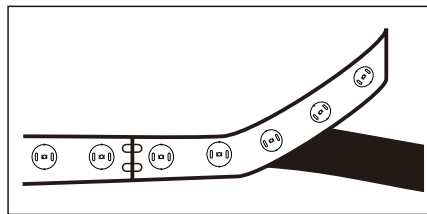

① Peel off the release paper of 3M tape.

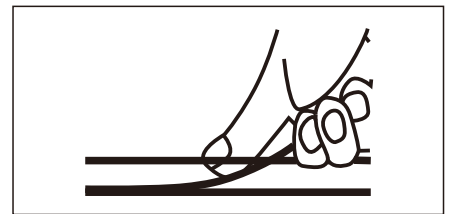

② Stick and fix the LED strip to the mounting surface.



(2) Bracket & Aluminum Channel & Screw
Or
(3) Bracket & Aluminum Channel & Screw & Cover & Cap

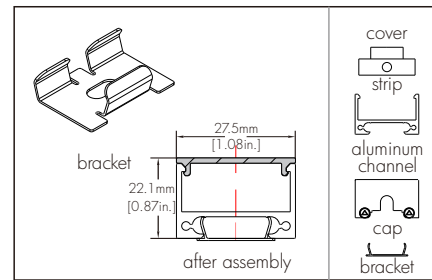

Fix the bracket to the mounting surface by screw. ② Fix the strip to the aluminum channel by adhesive tape.
③ Fix the cover and the cap to the aluminum channel by screw. ④ Clip the aluminum channel to the bracket.

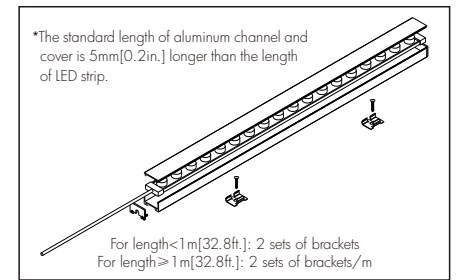

(4) 120° rotatable Bracket & Aluminum Channel & Cover & Cap & Screw

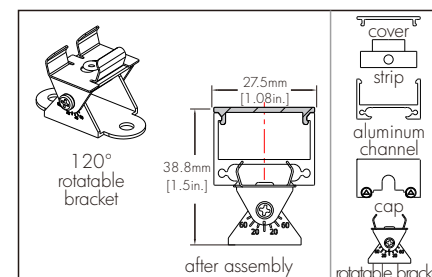

Fix the bracket to the mounting surface by screw. ② Fix the strip to the aluminum channel by adhesive tape.
③ Fix the cover and the cap to the aluminum channel by screw. ④ Clip the aluminum channel to the rotatable bracket.

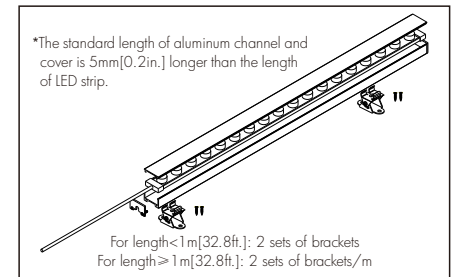

FDBW SERIES ORDERING INFORMATION

Ordering

Example: FDBW-40-16-24

Part No.	Beam Angle		Length		Voltage	
FDBW	20	20°	16	16.4ft	24	24vdc
	30	30°				
	40	40°	CU	Custom Length <i>cut by factory or in the field</i>		
	60	60°				
	25x35	20x35°				
	15x60	15x60°				

Custom Cut Orders can take 2-4 Weeks for Order Processing & Delivery

Accessories

- FS-FDBW-WL** Side Power Feed
- FS-FDBW-FBRKT** Fixed Angle Mounting Bracket (2 pieces)
- FS-FDBW-ADJBRKT** 120-degree Rotational Bracket (w/screws and Angle Scale)
- FS-FDBW-CHANNEL** Aluminum Rigid Channel (39" Section ,Transparent Cover and End Caps)



Recommended Power Supplies

Dimmable with 0-10v, ELV, MLV, TRIAC



Item Number	Description	Max/Min Load	Input Voltage	Output Voltage	Dimmable	Dimensions
PS-TSLC-UNV-24V-60WDHV2	60W	60W / 6W	100-277V AC	24V DC	Yes*	7.4"L x 3.6"W x 1.02"H
PS-TSLC-UNV-24V-96WDHV2	96W	96W / 9.6W	100-277V AC	24V DC	Yes*	8.66"L x 3.6"W x 1.61"H
PS-TSLC-UNV-24V-300WDHV2	300W	300W / 30W	100-305V AC	24V DC	Yes*	10.95"L x 4.33"W x 1.77"H
PS-TSLC-UNV-24V-288WDHV2	288W (3 x 96W)	288W / 28.8W	100-277V AC	24V DC	Yes*	11.85"L x 4.25"W x 1.8"H